

103

**U.S. PUBLIC LAND CORNER
MAINTENANCE**

**Corner ID : SE Sec.26, T19N-R1E
41901260000**

<u>DATE</u>	<u>CREW</u>	<u>MONUMENT TYPE</u> -----
December 6, 2014	Zachariah P. Dechant Gary L. Dechant	Found sleigh shoe at road intersection, down 10"

References:

	<u>Bearing</u>	<u>Distance</u>
1) Set 3/4"x24" square iron bar	S52E	58.78'
2) Set 3/4"x24" square iron bar	S34W	84.46'
3) Set 3/4"x24" square iron bar north of north end of gate	N80W	84.02'
4) Set 3/4"x24" square iron bar, 1' E of State Wildlife sign	N52W	32.86'

Harrison and reference markers 1 & 4 set on straight line.

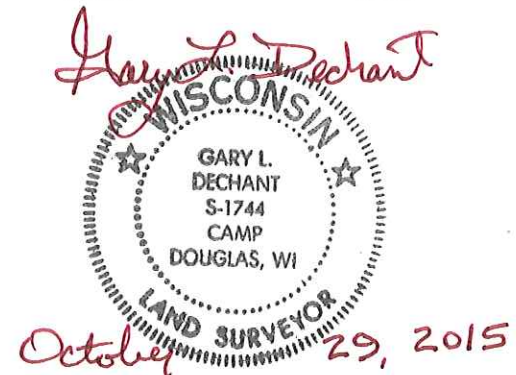

I, William C. Jung, do hereby certify that on the 4th day of March 1982, I found (evidence) (~~monument~~) of the NW corner of Section 36, T 19 N, R 1 E Fourth Principal Meridian, and I re-established said corner according to the Wisconsin Statutes as shown and described hereon.

Dated this 18th day of March 1982.

William C. Jung, R.L.S. 1323

County Surveyor's Office
Title

William C. Jung

Description of corner and witness monuments, references and accessories used to perpetuate the original or re-established location of this corner:

Witnesses to corner location:

W. Jung

G. Dechant

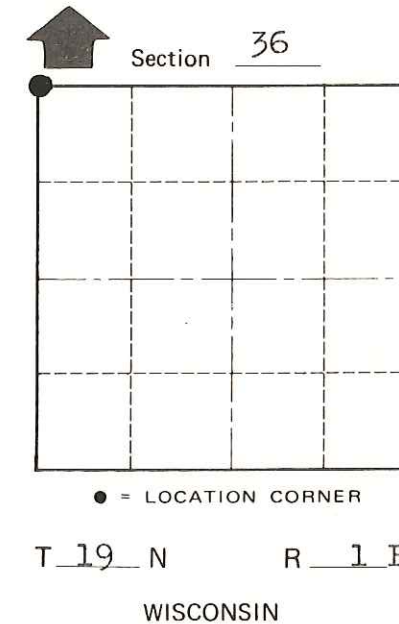
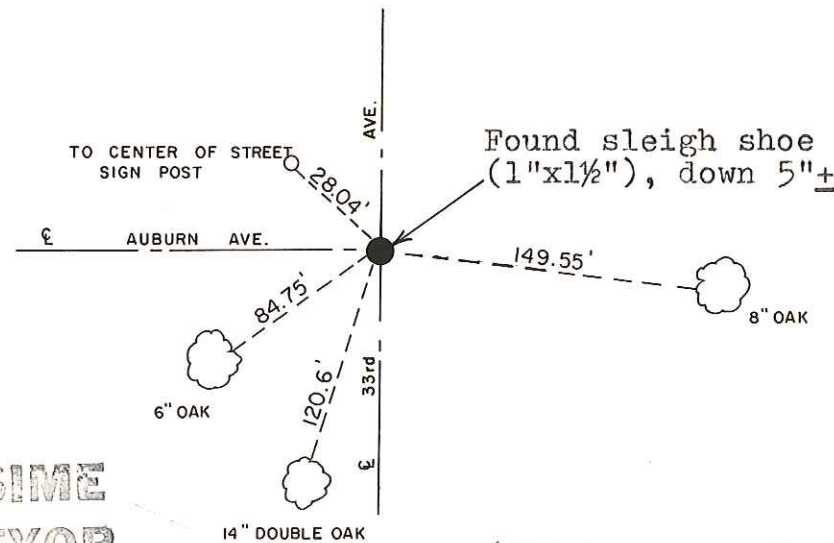
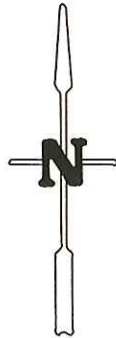
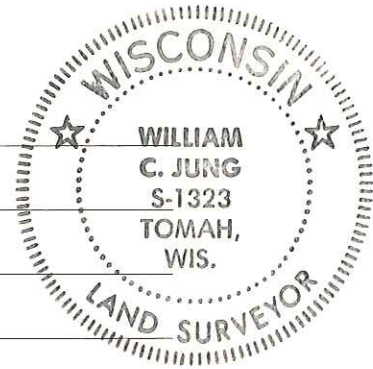

Approved: **HARLEY A. SIME**
MONROE CO. SURVEYOR

(All trees are double blazed with nail in lower blaze, distance to lower blaze)

See Reverse Side For Maintenance

SURVEY CONTROL ORDER

Horizontal	_____
Vertical	_____

WISCONSIN COORDINATE SYSTEM

Corner	East (X)	North (Y)	Elevation (Z)	Zone
Control Sta. Name				

~~City, Village or~~ Town Scott
County of Monroe

COUNTY SURVEYOR FORM NO. 1