

119

**U.S. PUBLIC LAND CORNER
MAINTENANCE**

**Corner ID : E1/4 Sec. 35, T19N-R1E
41901352000**

<u>DATE</u>	<u>CREW</u>	<u>MONUMENT TYPE -----</u>
April 5, 2018	Zachariah P. Dechant Gary L. Dechant	Existing Harrison, top broke off, down 20". 5' east center line Crescent Road. BT to NW gone. BT to SW stump w/nail. Power poles in place w/nail. Ties fit well.

References:

	<u>Bearing</u>	<u>Distance</u>
1) Set 1"x24" round iron bar, down 4", 4' west of trail sign. South edge of trail	East	96.34'
2) Set 1 1/4"x6' iron pipe, flush, in swampy ground	S60E	54.96'
3) Set 1 1/4"x24" iron pipe, down 6", 4' east of 10" White Pine, 12' south of trail	West	77.71'
4) Set 1 1/4"x24" iron pipe, flush in ditch, 4' SE of 12" White Oak	N60W	65.56'

Harrison and reference markers set on straight lines.

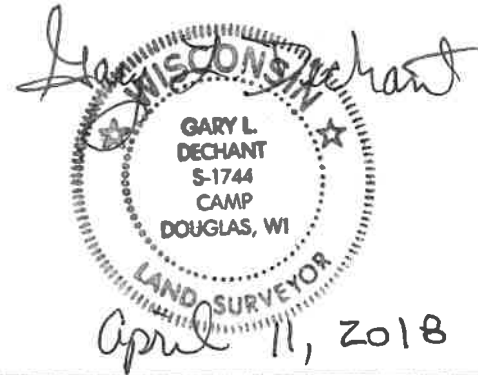

I, William C. Jung do hereby certify that on the twenty-eighth day of April 1982, I found ~~evidence~~ (no evidence) of the West corner of Section 36, T 19 N, R 1 E Fourth Principal Meridian, and I re-established said corner according to the Wisconsin Statutes as shown and described hereon.

Dated this seventh day of May 1982.

William C. Jung
Deputy County Surveyor
Title

History of corner establishment since Original Government Survey
No history recorded since the original government survey.

Description of corner evidence found:

I set the corner on line and equidistant between the section corners.

See Reverse Side For Maintenance

Approved: **HARLEY A. SIME**
MONROE CO. SURVEYOR

Description of corner and witness monuments, references and accessories used to perpetuate the original or re-established location of this corner:

Witnesses to corner location:

William Jung
Gary Dechant

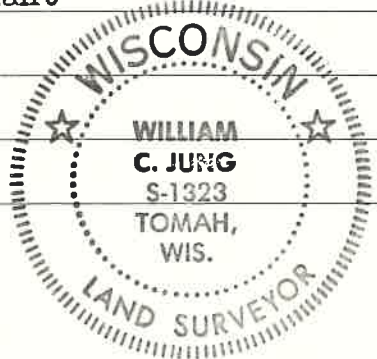

Both trees are double blazed Black Oaks; distances are to nails in blazes on N.W. side of trees.

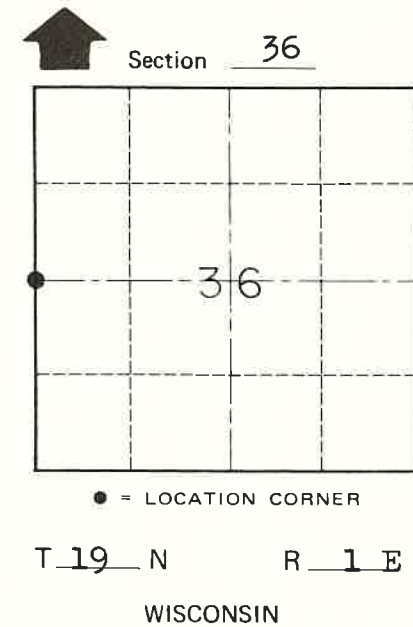
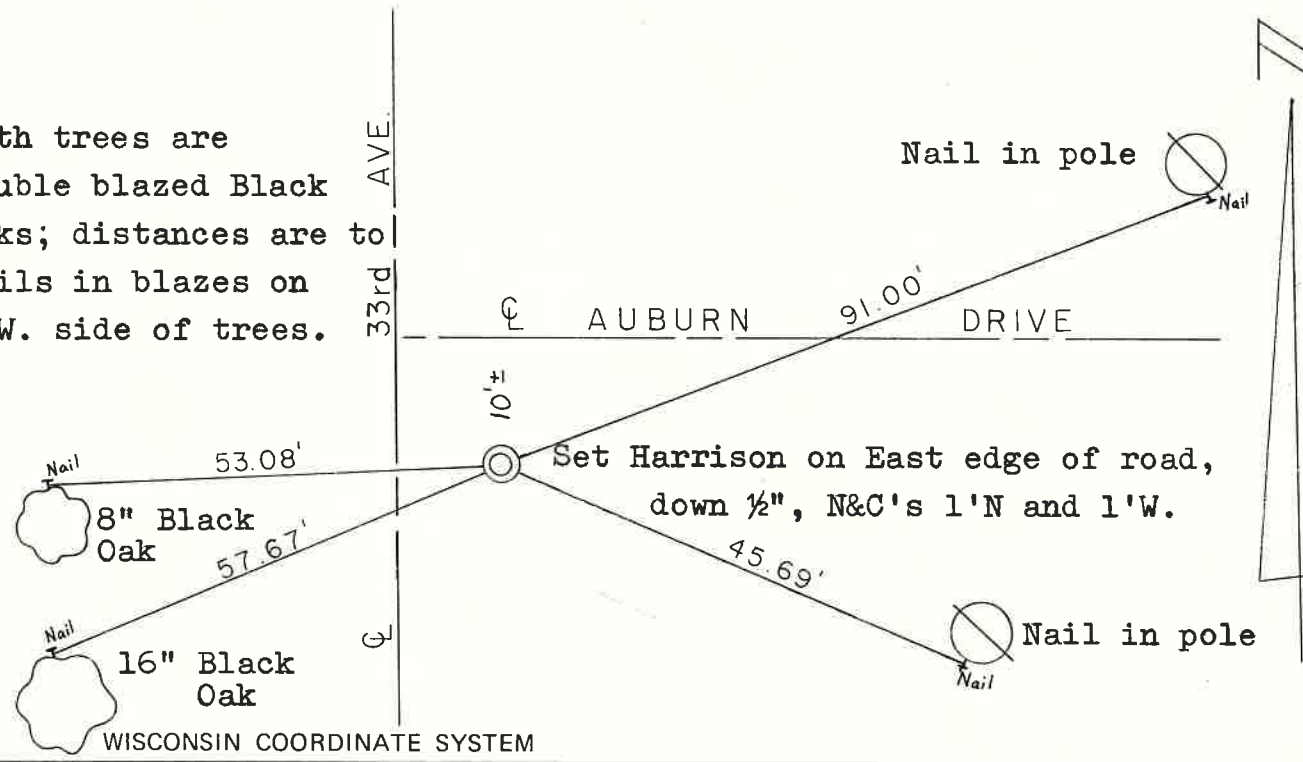

SURVEY CONTROL ORDER

Horizontal				
Vertical				
Corner	East (X)	North (Y)	Elevation (Z)	Zone
Control Sta. Name				

~~City, Village or~~ Town of Scott

County of Monroe

COUNTY SURVEYOR FORM NO. 1