

CERTIFICATE

CERTIFIED LAND CORNER

No. 36

21803082000

I, Lawrence A. Feddersen, do hereby certify that on the 29th day of August 1978, I found (evidence) (no evidence) of the East Quarter corner of Section 8, T 18 N, R 3 W, Fourth Principal Meridian, and I re-established said corner according to the Wisconsin Statutes as shown and described hereon.

Dated this 3 day of October 1978

Lawrence A. Feddersen

REGISTERED LAND SURVEYOR S-1226
Title

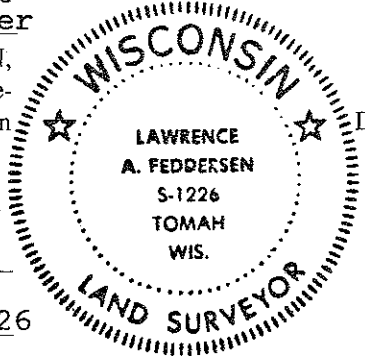

History of original corner establishment:

No subsequent history of corner perpetuation since the original U.S. Government Survey.

Description of corner evidence found:

This corner is intended to be on line and midway between the NE and SE corners of Section 8. A Jack pine at the intended corner position prevented it's proper location. The corner was placed as near as feasibly possible to it's intended position. This location agrees reasonably well with the occupied North-South fence line.

Description of corner and witness monuments, references and accessories used to perpetuate the original or re-established location of this corner:

Witnesses to corner location:
Lawrence A. Feddersen
Douglas J. Malliet
Steven R. Towne

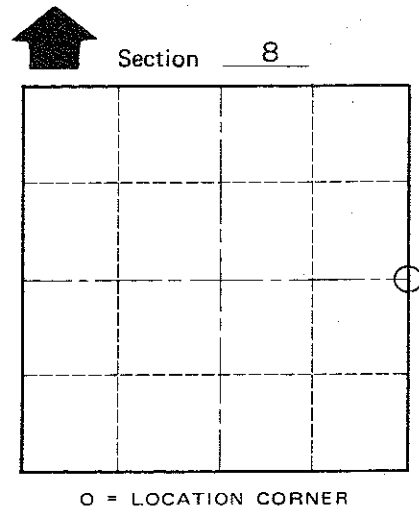
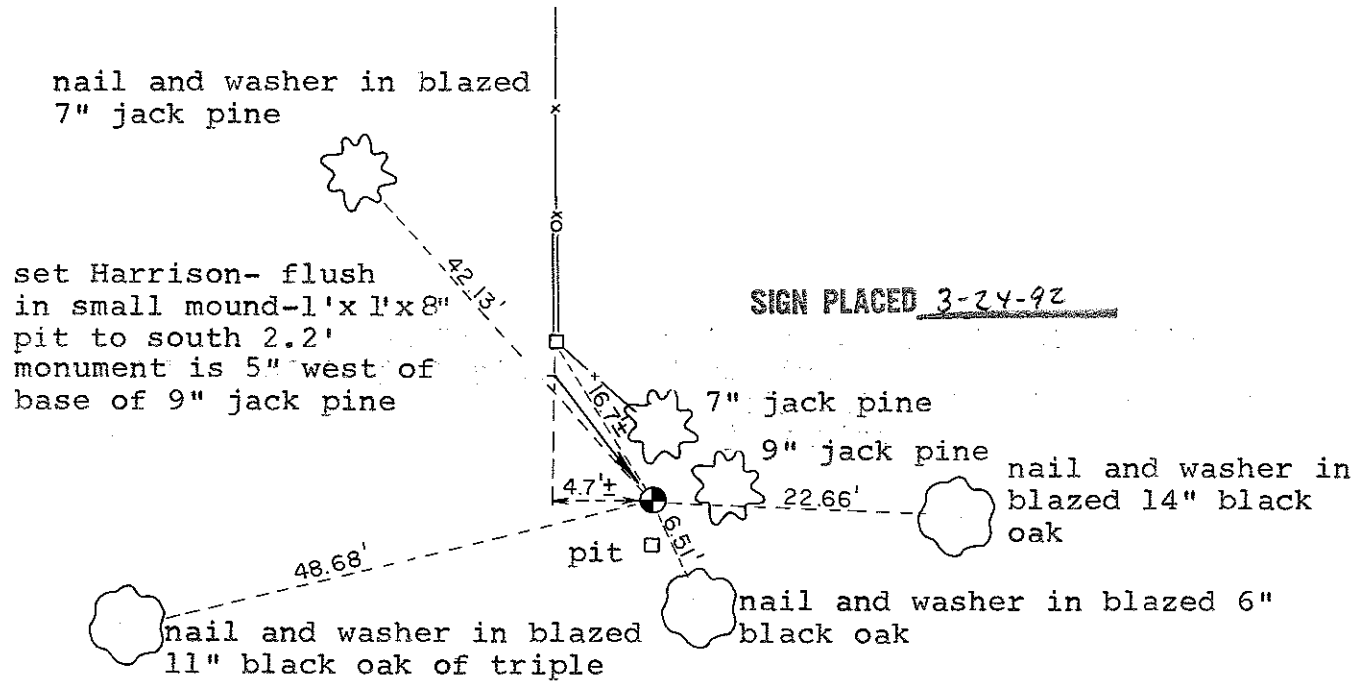

T 18 N R 3 W
WISCONSIN

COUNTY SURVEYOR FORM NO. 1

SURVEY CONTROL ORDER

Horizontal	_____
Vertical	_____

WISCONSIN COORDINATE SYSTEM

Corner	East (X)	North (Y)	Elevation (Z)	Zone
Control Sta. Name				

City, Village or Town OF LAFAYETTE
 County of MONROE