

CERTIFICATE

CERTIFIED LAND CORNER

No. 70

21803170020

I, Lawrence A. Feddersen, do hereby certify that on the 11th. day of September 19 78, I found ~~(witness)~~ (no evidence) of the South Quarter corner of Section 17, T 18 N, R 3 W, Fourth Principal Meridian, and I re-established said corner according to the Wisconsin Statutes as shown and described hereon.

History of original corner establishment:

No subsequent history of corner perpetuation since the original U.S. Government Survey.

Dated this 3 day of Oct. 19 78.

Lawrence A. Feddersen

REGISTERED LAND SURVEYOR S-1226
Title

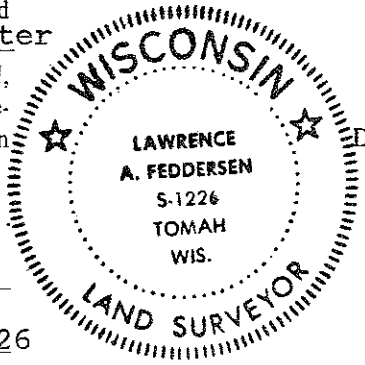

Description of corner evidence found:

This corner was re-established on line and midway between the SE and SW corners of Section 17. The East-West fence along the South line of Section 17 is somewhat erratic and bends substantially South at this corner.

Description of corner and witness monuments, references and accessories used to perpetuate the original or re-established location of this corner:

Witnesses to corner location:

Lawrence A. Feddersen

Douglas J. Malliet

Steven R. Towne

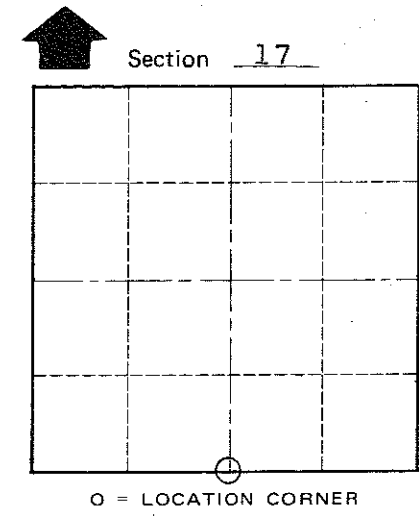
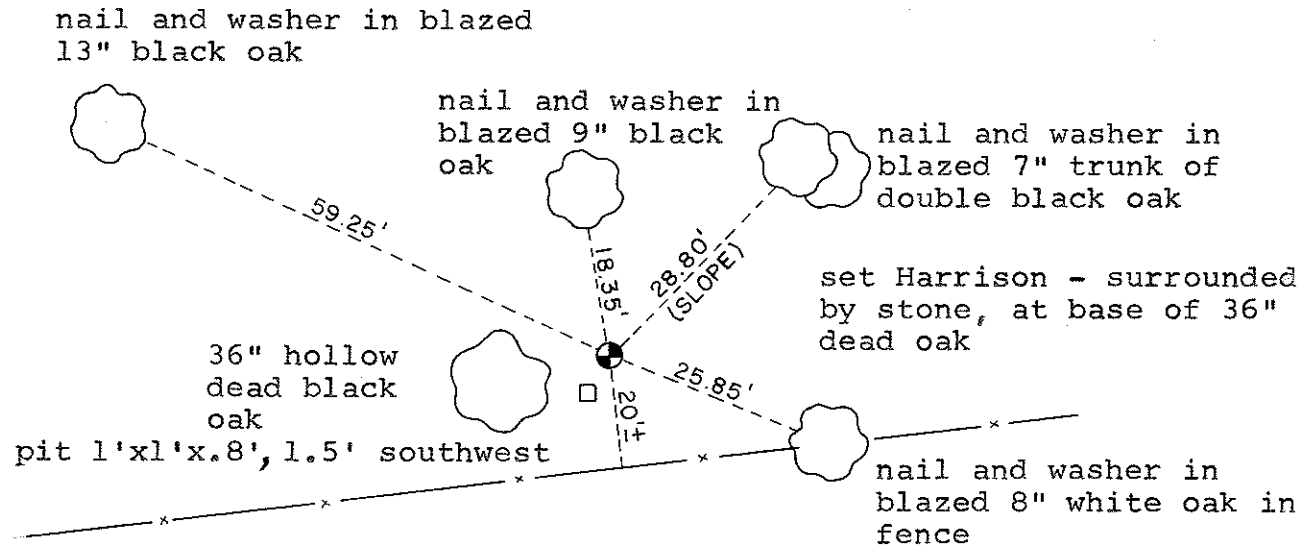

T 18 N R 3 W
WISCONSIN

COUNTY SURVEYOR FORM NO. 1

SURVEY CONTROL ORDER

Horizontal	_____
Vertical	_____

WISCONSIN COORDINATE SYSTEM

Corner	East (X)	North (Y)	Elevation (Z)	Zone
Control Sta. Name				

City, Village or Town of LAFAYETTE

County of MONROE