

21803302000

I, William C. Jung, do hereby certify that on the 21st day of December 1982, I found (evidence) ~~no evidence~~ of the West 1/4 corner of Section 29, T 18 N, R 3 W Fourth Principal Meridian, and I re-established said corner according to the Wisconsin Statutes as shown and described hereon.

Dated this 27th day of Jan. 1983.

William C. Jung

Deputy County Surveyor  
Title

History of corner establishment since Original Government Survey

Dahl was at this corner in May of 1869. Holden was at this corner in February of 1903. Bergman set an iron pipe at this corner in March of 1932. Feddersen found an iron pipe at this corner in March of 1977.

Description of corner evidence found:

I found an iron pipe at the old occupied corner, removed it, and replaced it with a Harrison marker.

Approved: **HARLEY A. SIME**  
**MONROE CO. SURVEYOR**

COUNTY SURVEYOR FORM NO. 1

Description of corner and witness monuments, references and accessories used to perpetuate the original or re-established location of this corner:

Witnesses to corner location:

William C. Jung

Bryan H. Meyer

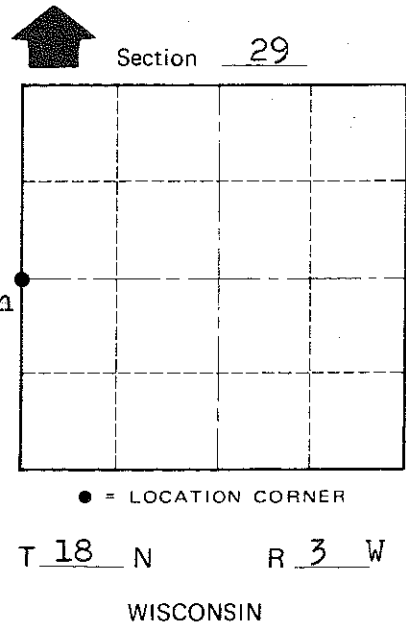
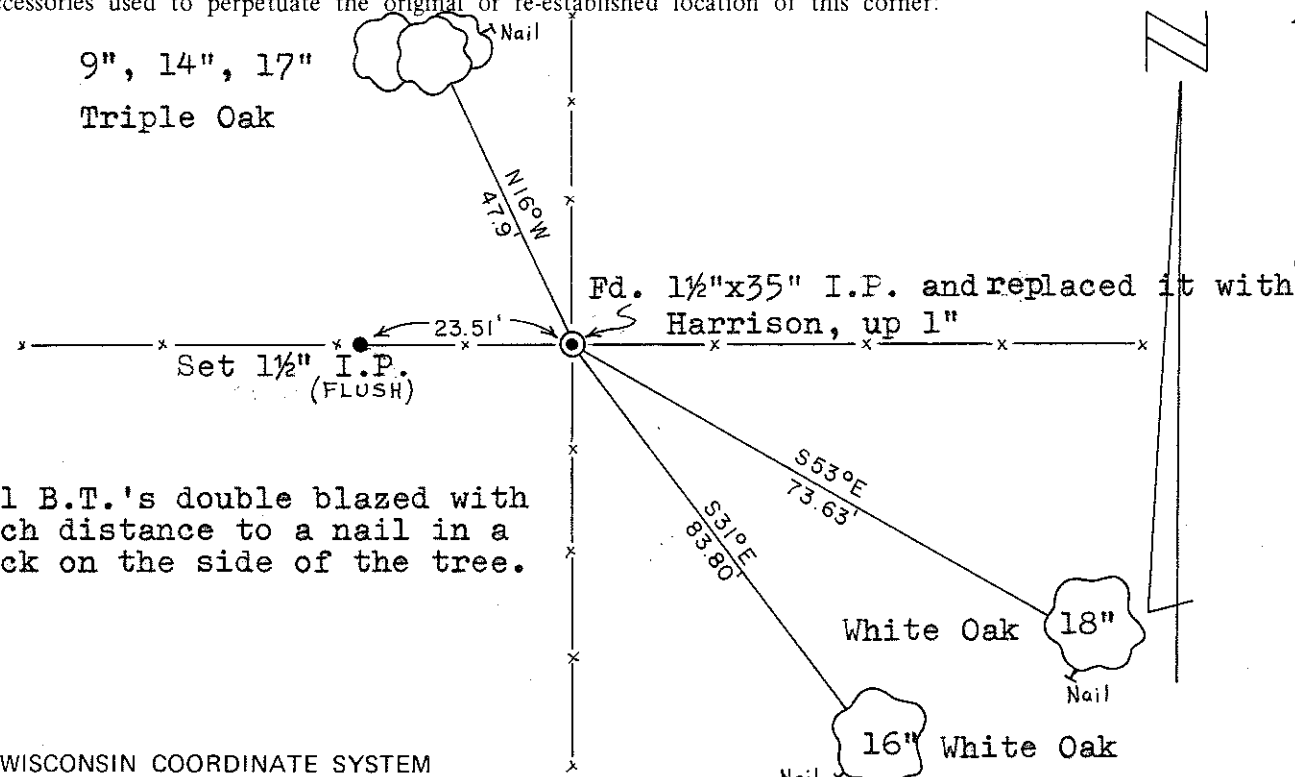
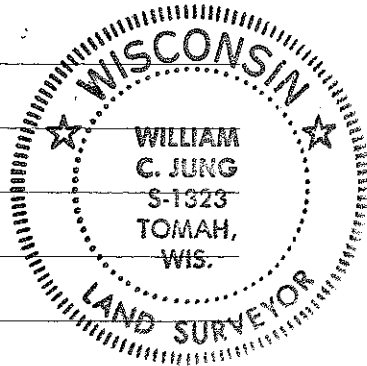

All B.T.'s double blazed with each distance to a nail in a hack on the side of the tree.

SURVEY CONTROL ORDER

Horizontal	_____
Vertical	_____

WISCONSIN COORDINATE SYSTEM

Corner	East (X)	North (Y)	Elevation (Z)	Zone
Control Sta. Name				

City, Village or Town of Lafayette

County of Monroe