

# 116

**U.S. PUBLIC LAND CORNER  
MAINTENANCE**

**Corner ID : E1/4 Sec. 32, T18N-R3W**

**21803322000**

| <u>DATE</u>      | <u>CREW</u>                             | <u>MONUMENT TYPE -----</u>  |
|------------------|---|---|
| October 13, 2016 | Zachariah P. Dechant<br>Gary L. Dechant | Existing Harrison intact. Down 6". 26' north CTH "I"/CTH "BB"<br>intersection |

| <u>References:</u>  | <u>Bearing</u> | <u>Distance</u> |
|---|----------------|-----------------|
| 1) Set 3/4" x24" round iron bar, down 12" in field                      | N63E           | 44.41'          |
| 2) Existing Geodetic Marker "La Fayette South 1993" south side CTH "BB" | S70E           | 141.51'         |
| 3) Set 3/4" x24" round iron bar, down 12" in field SW'ly of ditch       | S63W           | 81.05'          |
| 4) Set 3/4" x24" round iron bar, down 12" in field                      | N70W           | 38.10'          |

**Harrison and reference markers set on straight lines.**



I, William C. Jung, do hereby certify that on the 14th day of May 19 80, I found ~~(evidence)~~ (no evidence) of the West 1/4 corner of Section 33, T 18 N, R 3 W Fourth Principal Meridian, and I re-established said corner according to the Wisconsin Statutes as shown and described hereon.

Dated this 5th day of March 19 81.

*William C. Jung*

William C. Jung, R.L.S. 1323  
Title

History of corner establishment since Original Government Survey

None recorded since the original government survey.

**See Reverse Side  
For Maintenance**

Description of corner evidence found:

Set a Harrison marker equidistant and on line between the section corners.

**Approved: HARLEY A. SIMÉ  
MONROE CO. SURVEYOR**

COUNTY SURVEYOR FORM NO. 1

Description of corner and witness monuments, references and accessories used to perpetuate the original or re-established location of this corner:

Witnesses to corner location:

William C. Jung

Todd Tormoen

Scott Sowers

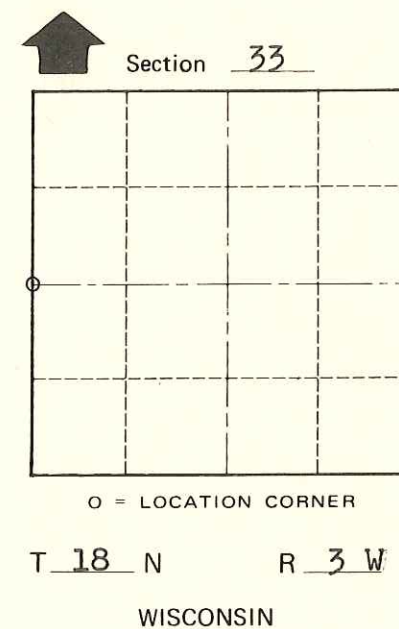
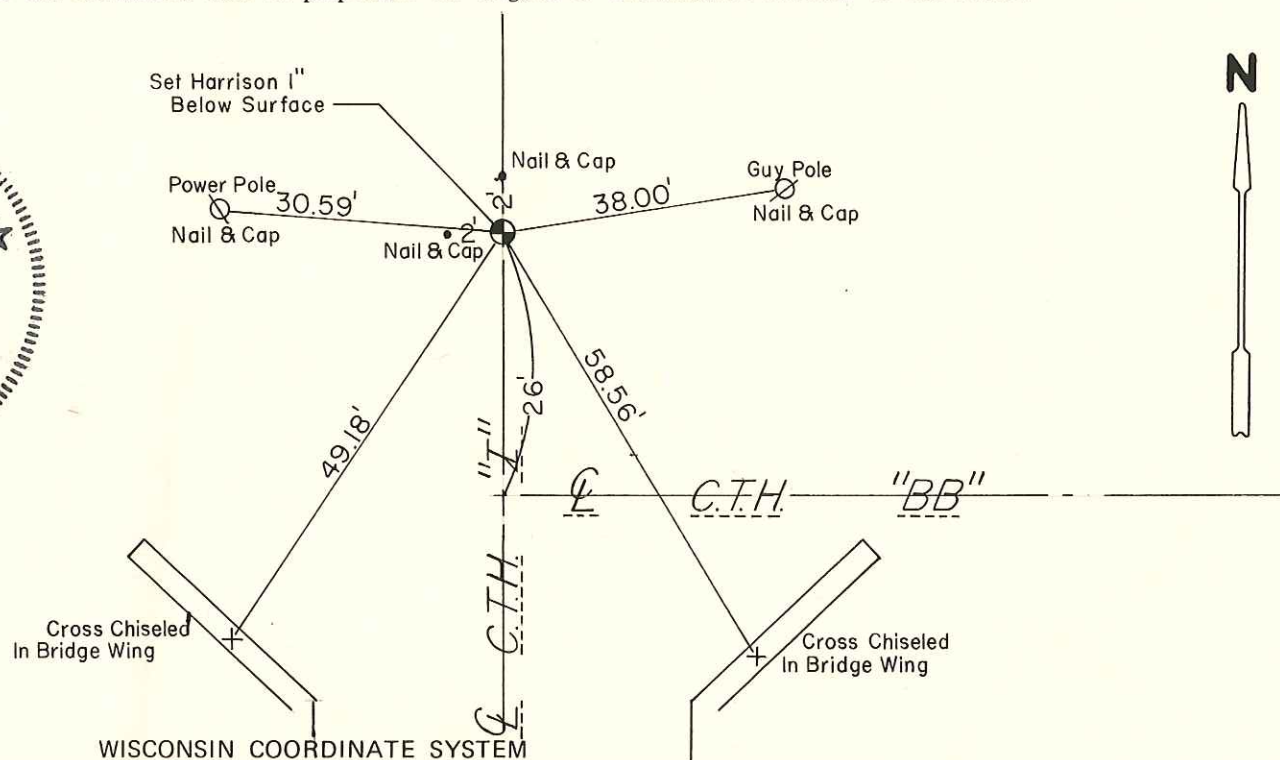
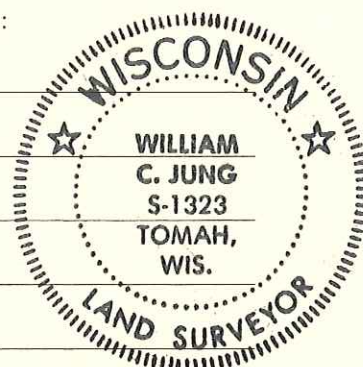

SURVEY CONTROL ORDER

|            |       |
|------------|-------|
| Horizontal | _____ |
| Vertical   | _____ |

| Corner            | East (X) | North (Y) | Elevation (Z) | Zone |
|-------------------|----------|-----------|---------------|------|
| Control Sta. Name |          |           |               |      |

City, Village or Town Lafayette  
County of Monroe  
Wisconsin