

21802020000

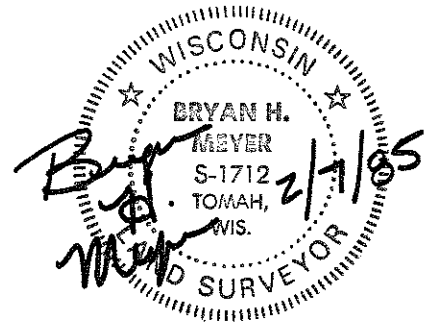

I, Bryan H. Meyer, do hereby certify that on the 29th day of June 1984, I found (evidence) ~~re-established~~ of the Northeast corner of Section 11, T 18 N, R 2 W Fourth Principal Meridian, and I re-established said corner according to the Wisconsin Statutes as shown and described hereon.

Dated this 7th day of Feb. 1985.
Bryan H. Meyer
Deputy County Surveyor
Title

History of corner establishment since Original Government Survey

O. R. Dahl was here in April of 1871. Fred Holden was here in May of 1907. This corner was again visited by Mr. Holden in April of 1909.

Description of corner evidence found:

I set this corner by "doubling over" the bearing and distance of the line which runs on the North side of the NE 1/4 of the NW 1/4 of Section 12. This location fits the occupied fenceline to the South very well. (I did find Holden's iron pipe bent and lying flat near the corner)

Description of corner and witness monuments, references and accessories used to perpetuate the original or re-established location of this corner:

Crew: Meyer, Wilhite
Date: June 29, 1984 - 2:30 P. M.
Weather: P. Cloudy, Nice! 80°±
Witnesses to corner location:

Bryan H. Meyer

Dallas Wilhite

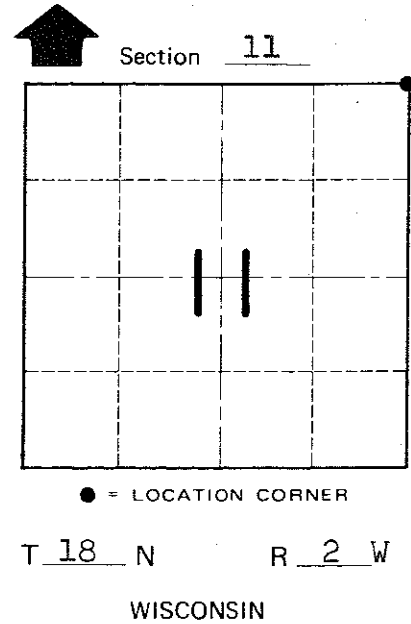
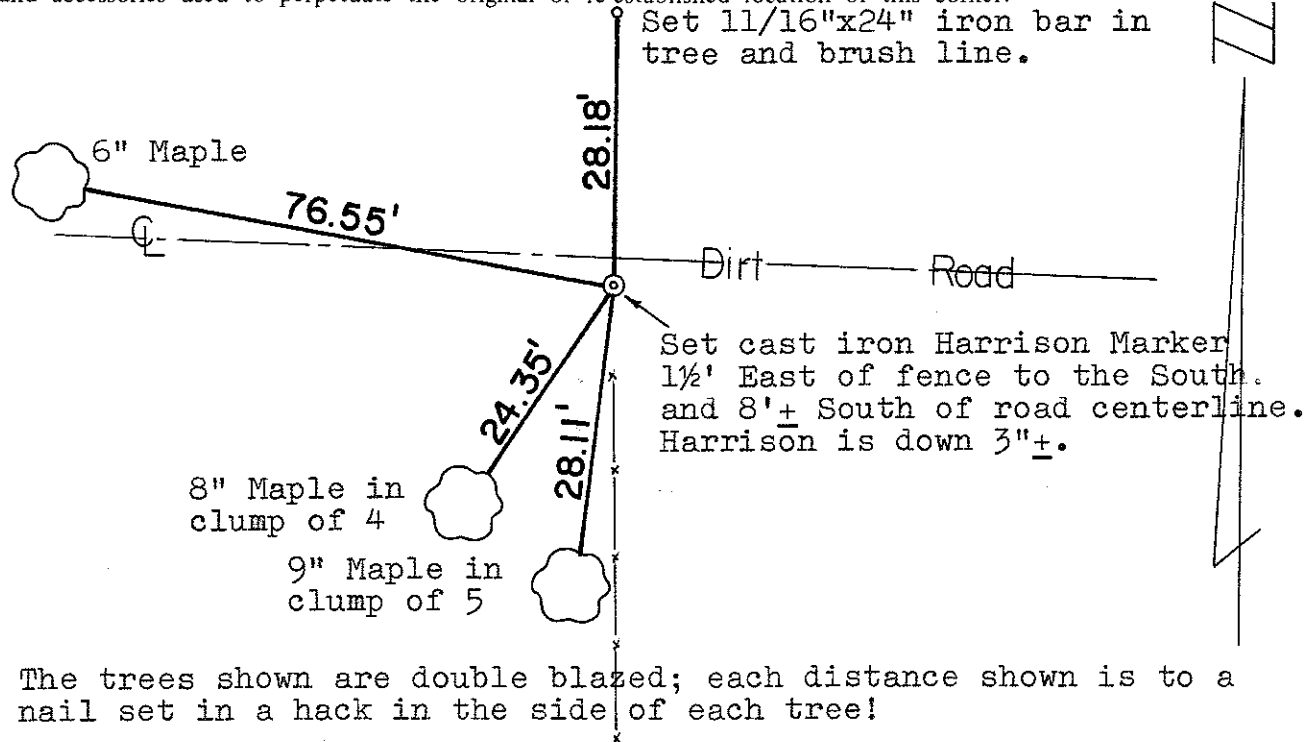

COUNTY SURVEYOR FORM NO. 1

SURVEY CONTROL ORDER

Horizontal	_____
Vertical	_____

The trees shown are double blazed; each distance shown is to a nail set in a hack in the side of each tree!

WISCONSIN COORDINATE SYSTEM

Corner	East (X)	North (Y)	Elevation (Z)	Zone
Control Sta. Name				

~~Village of~~ Town of Greenfield
County of Monroe