

#18 B

U.S. Public Land Survey Monument Record

Corner ID: C1/4 Sec. 2, T18N-R2W

21802022020

Type of Monument: Set Railroad spike (shallow rock bed)

Sec. 2, T18N-R2W

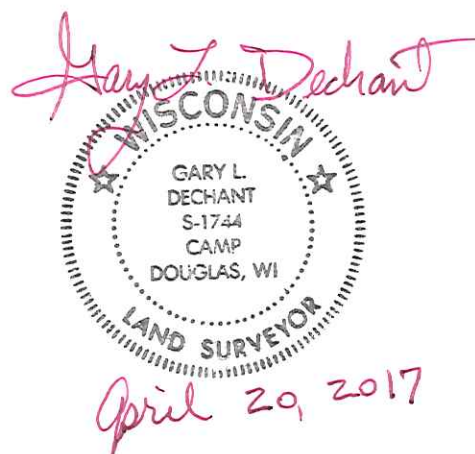
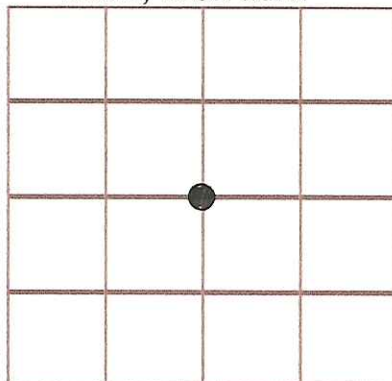

County Coordinates:

Witnesses: Zachariah P. Dechant
Gary L. Dechant

Basis For Monument Location:

(Show info such as history, evidence, testimony, found or method of relocation)

No known history.

Set at intersection of 1/4 lines.

