

CERTIFICATE

I, Garold A. Sime, do hereby certify that on the 24th day of August, 1984, I found (evidence) ~~(No Evidence)~~ of the W 1/4 corner of Section 24, T 18 N, R 2 W Fourth Principal Meridian, and I re-established said corner according to the Wisconsin Statutes as shown and described hereon.  
Dated this 15th day of Oct., 1984.

Garold A. Sime

Garold A. Sime, R.L.S. 1261

Title

CERTIFIED LAND CORNER

No. 79

21802232000

History of corner establishment since Original Government Survey

No history since the Original Government Survey

Description of corner evidence found:

I found an existing 1/4" iron pipe at corner (unrecorded) and accepted same as corner. I replaced this iron pipe with a Harrison Monument.

COUNTY SURVEYOR FORM NO. 1

Description of corner and witness monuments, references and accessories used to perpetuate the original or re-established location of this corner:

Harrison Monument at corner

Witnesses to corner location:

G. A. Sime

Dallas Wilhite

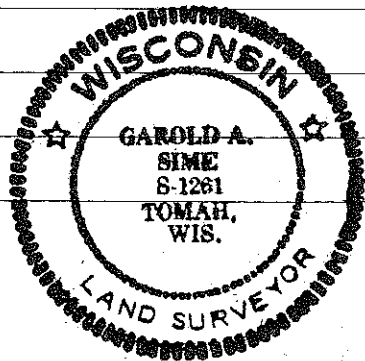

SURVEY CONTROL ORDER

Horizontal	
Vertical	

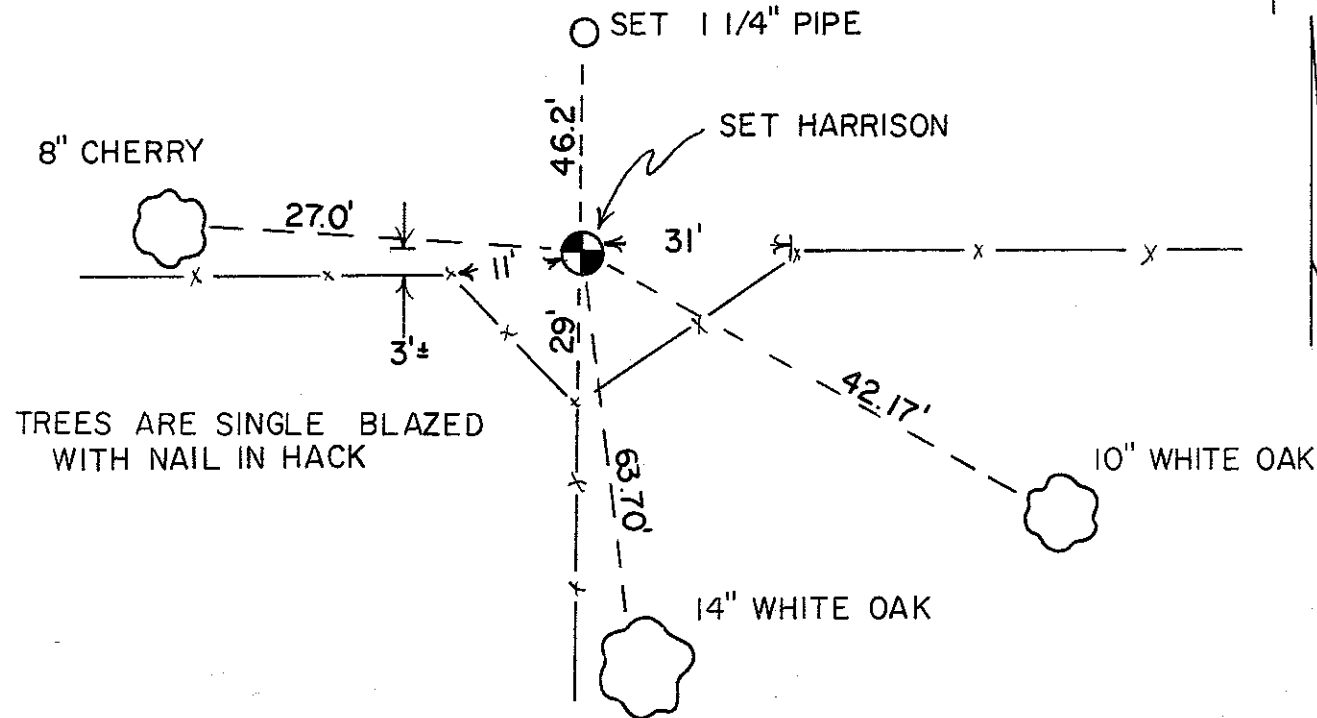

TREES ARE SINGLE BLAZED WITH NAIL IN HACK

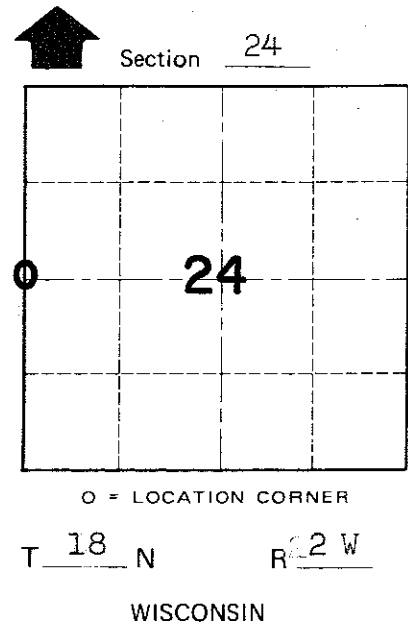

WISCONSIN COORDINATE SYSTEM

Corner	East (X)	North (Y)	Elevation (Z)	Zone
Control Sta. Name				

City, Village or Town Greenfield

County of Monroe