

CERTIFICATE

CERTIFIED LAND CORNER

No. 107

21802280000

I, William C. Jung, do hereby certify that on the 25th day of June 1979, I found (evidence) (no evidence) of the Southwest corner of Section 27, T 18 N, R 2 W, Fourth Principal Meridian, and I re-established said corner according to the Wisconsin Statutes as shown and described hereon.

Dated this 10th day of Feb. 1981.

William C. Jung
William C. Jung, R.L.S. 1323
Title

History of original corner establishment:

A surveyor was at this corner in June of 1883. Government surveyors found a concrete monument at this corner in 1944 while doing the McCoy boundary survey. It appears that this corner was set in about 1938 by government engineers.

Description of corner evidence found:

Found 9"x9" square concrete monument, up 3'+ with pointed top marked U.S. Mil. Res. No. "17" on north side.

Description of corner and witness monuments, references and accessories used to perpetuate the original or re-established location of this corner:

Witnesses to corner location:

Jung
Pietz

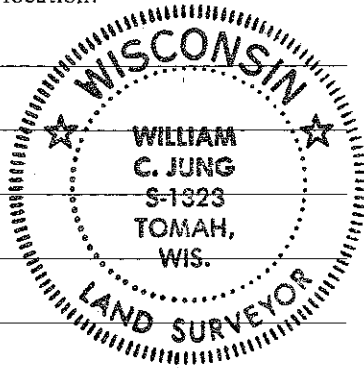

NOTE: ALL TREES DOUBLE BLAZED WITH NAIL & CAP SET

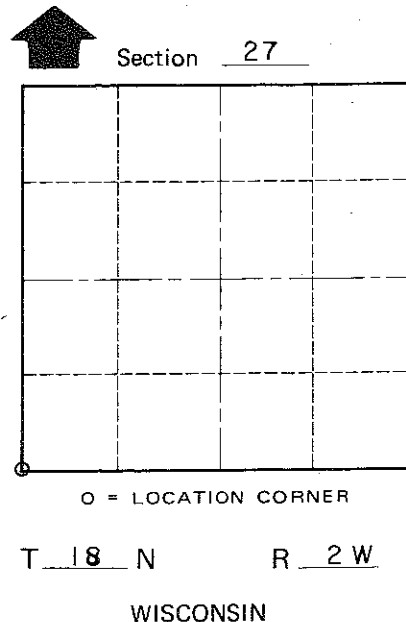
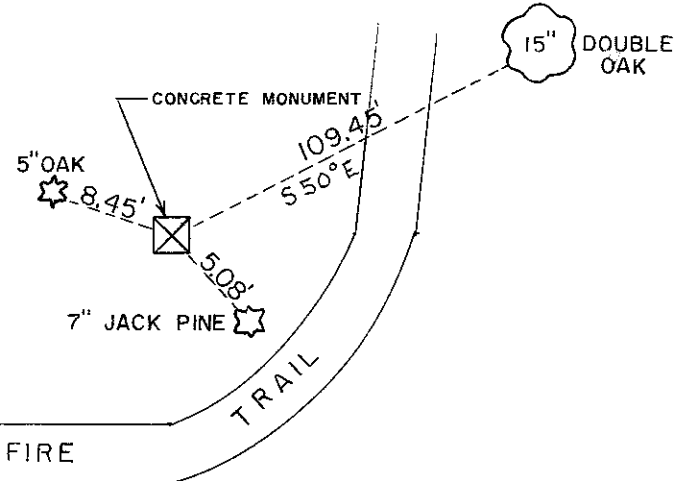

Approved: HARLEY A. SIME
MONROE CO. SURVEYOR

SURVEY CONTROL ORDER

Table with columns: Horizontal, Vertical, East (X), North (Y), Elevation (Z), Zone, Corner, Control Sta. Name

COUNTY SURVEYOR FORM NO. 1

or Town Greenfield
County of Monroe