

**U.S. PUBLIC LAND CORNER  
MAINTENANCE**

# 100

Corner ID: E1/4 Sec. 25, T18N-R2W

21802252000

DATE	CREW	MONUMENT TYPE
October 9, 2019	Zachariah P. Dechant Gary L. Dechant	Existing Harrison intact, 69' south of STH "21" 20' East of Flagstaff Rd. Near NE corner of Greenfield Cemetery. Set new sign 1/2' North.

References:

	Bearing	Distance
1) Set 3/4x24" round iron bar, down 4", 6' NW of 14" Walnut	S63E	45.68'
2) Set 3/4x24" round iron bar, down 4", 8' south of 36" White Oak (BT)	S30E	24.42'
3) Set 3/4x24" round iron bar, down 4", 7' west of row of White Pines to east	South	48.72'
4) Set 3/4x24" round iron bar, down 6",	S14W	13.50'

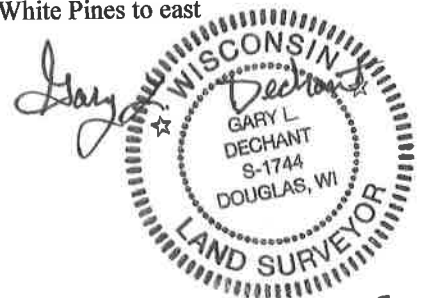

December 23, 2019

I, William C. Jung, do hereby certify that on the 25th day of October 1979, I found (evidence) ~~no evidence~~ of the E. 1/4 corner of Sec. 25, T18 N, R 2 W. Fourth Principal Meridian, and I re-established said corner according to the Wisconsin Statutes as shown and described hereon.

Dated this 3rd day of April 1980:

William C. Jung R.L.S. 1323

County Surveyors Office Monroe County, Wisconsin.

*William C. Jung*

History of corner establishment since Original Government Survey

Schroeder was here in October of 1895. Fred Holden was here in January of 1901.

Description of corner evidence found:

Found one of Holdens 1901 bearing trees, and set Harrison Monument at proper bearing and distance.

**See Reverse Side For Maintenance**

Description of corner and witness monuments, references and accessories used to perpetuate the original or re-established location of this corner:

Witnesses to corner location:

William Jung

Gary Dechant

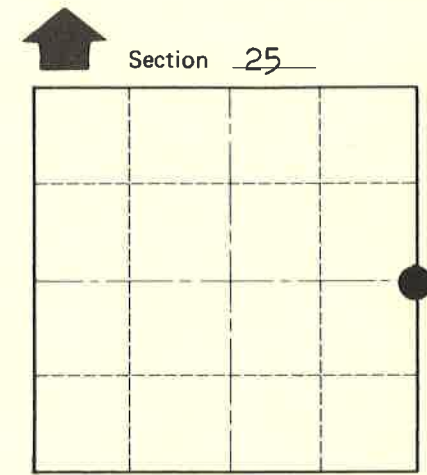
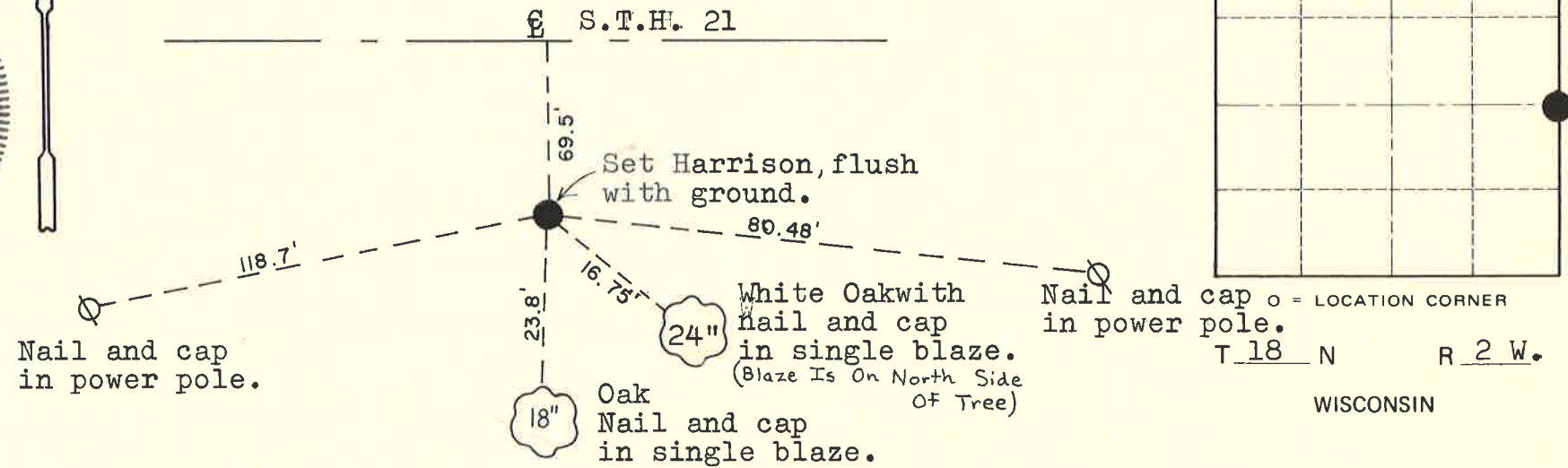
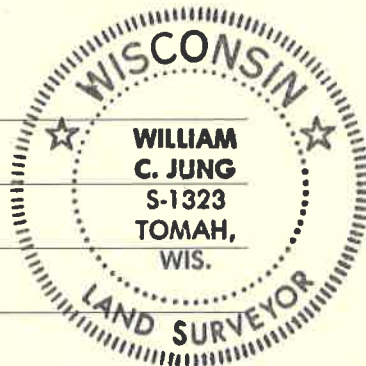

**Approved: HARLEY A. SIME**  
**MONROE CO. SURVEYOR**

SURVEY CONTROL ORDER

Horizontal	_____
Vertical	_____

WISCONSIN COORDINATE SYSTEM

Corner	East (X)	North (Y)	Elevation (Z)	Zone
Control Sta. Name				

City, Village or Town of Greenfield  
County of Monroe  
Wisconsin

COUNTY SURVEYOR FORM NO. 1