

**U.S. PUBLIC LAND CORNER  
MAINTENANCE**

# 114

**Corner ID:** W1/4 Sec. 31, T18N-R1W  
**21802362000**

| <u>DATE</u>       | <u>CREW</u>                             | <u>MONUMENT INFO</u>  |
|-------------------|---|---|
| December 20, 2019 | Zachariah P. Dechant<br>Gary L. Dechant | Existing Harrison intact, 35' north of fence<br>Set sign 1' north |

|   | <u>Bearing</u> | <u>Distance</u> |
|---|----------------|-----------------|
| 1) Set 5/8"x24" round iron bar, down 6"   | N22E           | 26.56'          |
| 2) Set 5/8"x24" round iron bar, down 6", 4' NW of 10" Maple   | S52E           | 12.31'          |
| 3) Set 5/8"x24" round iron bar, down 6", 4" SE of 18" Maple<br>Tree leaning south, bar NE side of stone | S70W           | 24.85'          |
| 4) Set 5/8"x24" round iron bar, down 6"   | N1W            | 26.57'          |

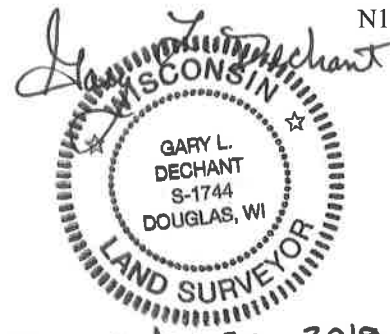

December 23, 2019

I, Harley Sime, do hereby certify that on the 3 day of June 19 76, I found

~~(evidence)~~ (no evidence) of the W<sup>1/4</sup> corner of Section 31, T 18 N, R 1 W, Fourth Principal Meridian, and I re-established said corner according to the Wisconsin Statutes as shown and described hereon.

Dated this \_\_\_\_\_ day of \_\_\_\_\_ 19\_\_\_\_.  
Harley Sime  
County Surveyor  
Title

History of original corner establishment:

**See Reverse Side  
For Maintenance**

Description of corner evidence found:

Found an old fence line coming up from the South, used as line in previous surveys. Using this fence line for an East-West reference the corner was thus set on this line and midway between the Section corners to the North and South. This location agreed with measurements all four ways.

Description of corner and witness monuments, references and accessories used to perpetuate the original or re-established location of this corner:

Set a standard Harrison monument up 2" in the middles of the woods, with accessories as described below:

Witnesses to corner location:

- K. Pritzlaff -
- D.J. Malliet - Survey crew chief
- A. Lueck
- G. Sime

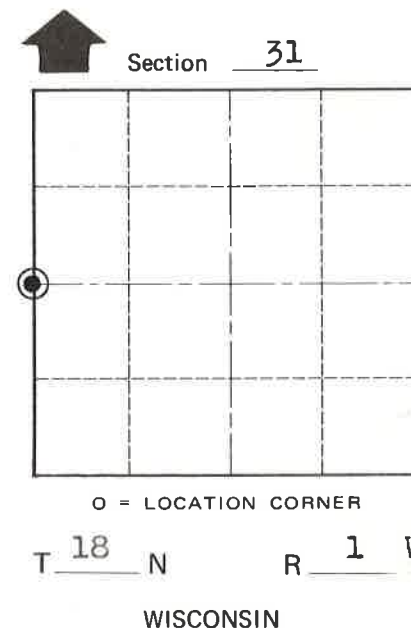
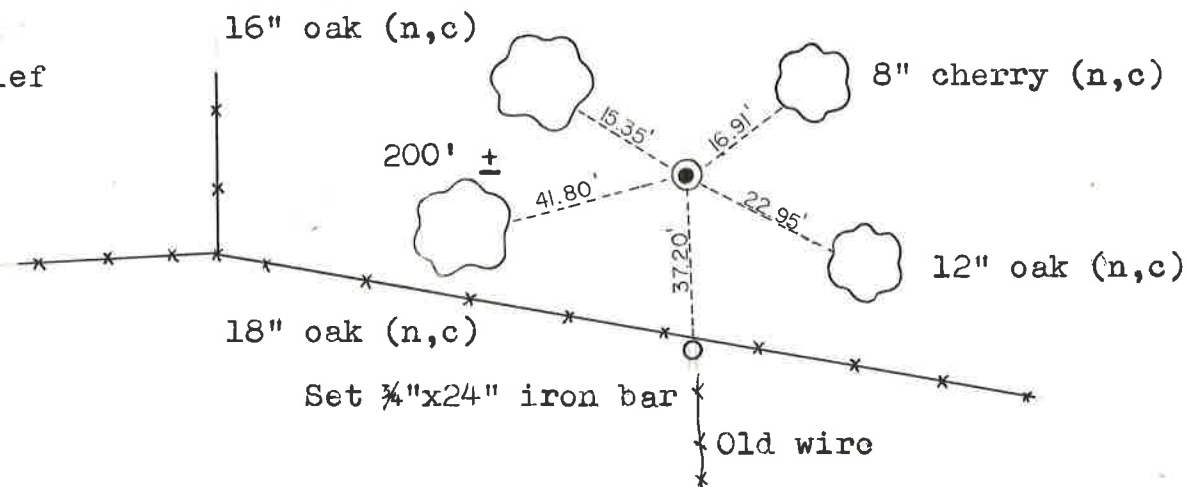

**PLACED  
COUNTY SURVEYOR'S  
SIGN 6-9-87**

COUNTY SURVEYOR FORM NO. 1

SURVEY CONTROL ORDER

|            |       |
|------------|-------|
| Horizontal | _____ |
| Vertical   | _____ |

WISCONSIN COORDINATE SYSTEM

| Corner            | East (X) | North (Y) | Elevation (Z) | Zone |
|-------------------|----------|-----------|---------------|------|
| Control Sta. Name |          |           |               |      |

0.37 N 1/4 of Town of La Grange

County of Monroe