

123

**U.S. PUBLIC LAND CORNER
MAINTENANCE**

**Corner ID : SE Sec.35, T18N-R2W
21802350000**

<u>DATE</u>	<u>CREW</u>	<u>MONUMENT TYPE</u> -----
August 5, 2015	Zachariah P. Dechant Gary L. Dechant	Existing Harrison intact, set survey sign 2' south falls on east slope

References:

	<u>Bearing</u>	<u>Distance</u>
1) Set 3/4"x24" hex iron bar, 8' south of large triple Red Oak	N1E	36.58'
2) Set 3/4"x24" hex iron bar, 5' NE of 8" Ash	N50E	19.65'
3) Set 3/4"x24" hex iron bar	S20E	20.94'
4) Set 3/4"x24" hex iron bar, 5' NE of 22" White Oak (BT)	S10W	16.68'

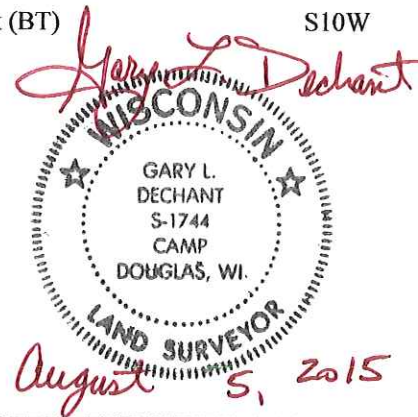

I, Harley A. Sime, do hereby certify that on the 3rd day of June 1976, I found (evidence) (~~no evidence~~) of the SW corner of Section 36, T 18 N, R 2 W, Fourth Principal Meridian, and I re-established said corner according to the Wisconsin Statutes as shown and described hereon.

Dated this 20th day of March 1978.

Harley Sime

County Surveyor
Title

History of original corner establishment:

F. Holden was here in January of 1901.
Schroeder was here in May of 1883.

Description of corner evidence found:

Found an iron bar in a 3-way fence and replaced it with a Harrison Monument.

See Reverse Side
For Maintenance

Approved: **HARLEY A. SIME**
MONROE CO. SURVEYOR

Description of corner and witness monuments, references and accessories used to perpetuate the original or re-established location of this corner:

Witnesses to corner location:

D. Malliet, Crew Chief

A. Lueck

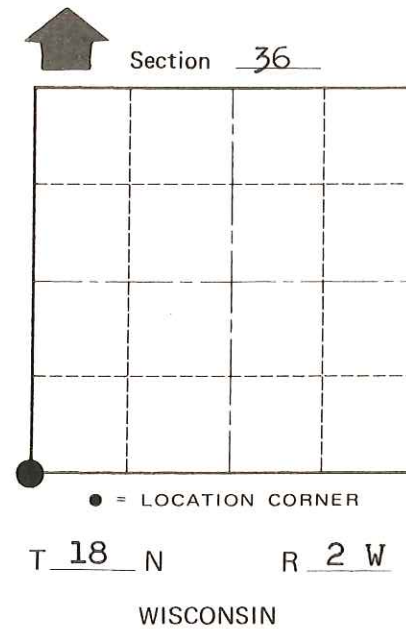
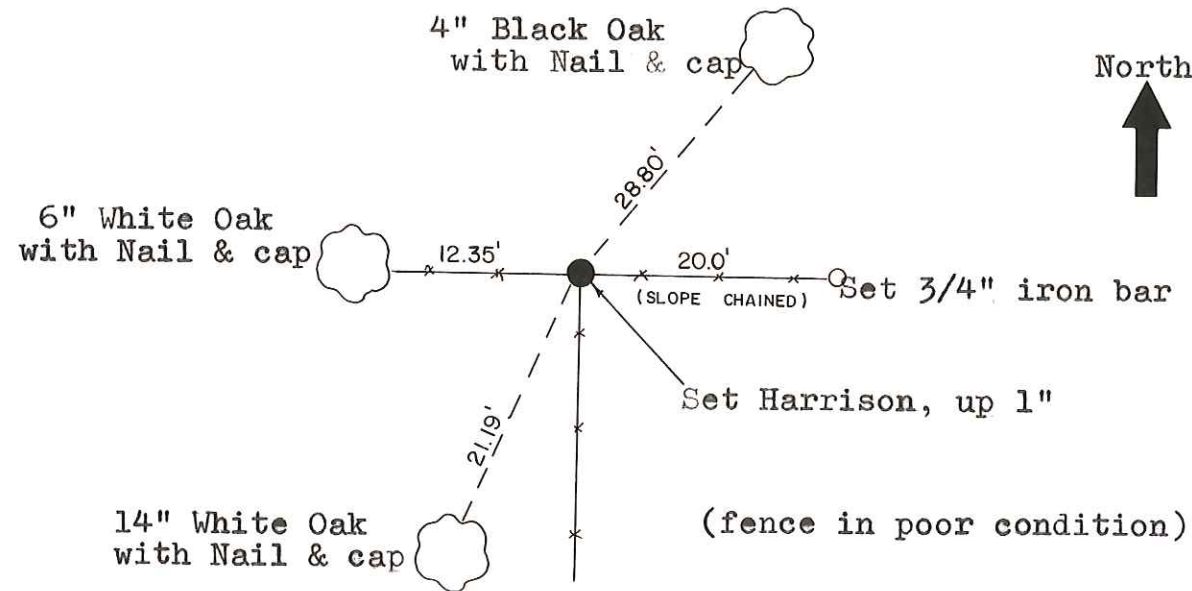
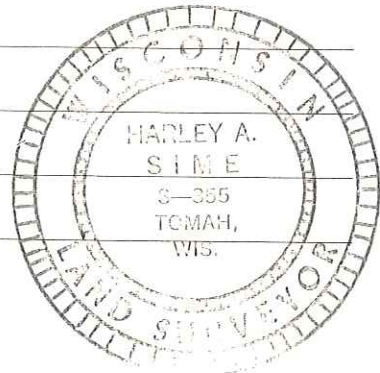

SURVEY CONTROL ORDER

Horizontal	_____
Vertical	_____

WISCONSIN COORDINATE SYSTEM

Corner	East (X)	North (Y)	Elevation (Z)	Zone
Control Sta. Name				

City, Village or Town Greenfield

County of Monroe

COUNTY SURVEYOR FORM NO. 1