

# 42

# U.S. PUBLIC LAND CORNER MAINTENANCE

Corner ID : N1/4 Sec. 13, T18N-R1E

41801120020

<u>DATE</u>	<u>CREW</u>	<u>MONUMENT TYPE</u> -----
February 7, 2018	Zachariah P.Dechant Gary Dechant	Existing Harrison intact, flush, survey sign on north side

<u>References:</u>	<u>Bearing</u>	<u>Distance</u>
1) Set 3/4"x24" round iron bar	N29E	35.10'
2) Set 3/4"x24" round iron bar, 3' SW of 12" Maple (BT)	N70E	11.06'
3) Set 3/4"x24" round iron bar, 4' east of 13" Black Oak	S26E	29.56'
4) Set 3/4"x24" round iron bar, 4' SW of 12" Maple (BT)	N52W	12.87'



41801120020

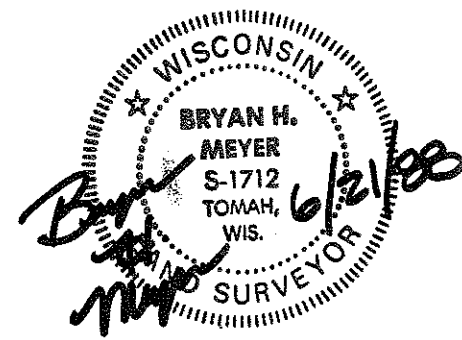

I, Bryan H. Meyer, do hereby certify that on the 14th day of June 19 88, I found (evidence) ~~re-established~~ of the North 1/4 corner of Section 13, T 18 N, R 1 E Fourth Principal Meridian, and I re-established said corner according to the Wisconsin Statutes as shown and described hereon.

History of corner establishment since Original Government Survey

Nothing Recorded.

Description of corner evidence found:

I established this corner by doubling West the North line of the NE1/4-NE1/4 of Section 13. Said line was established by Fred Zietlow in December of 1970. This corner location fits the existing fence corner EXTREMELY well!

Dated this 21st day of June 19 88.

Bryan H. Meyer

Registered Land Surveyor  
Title

COUNTY SURVEYOR FORM NO. 1

Description of corner and witness monuments, references and accessories used to perpetuate the original or re-established location of this corner:

Crew: Meyer, Forsythe  
Date: June 14, 1988 - 12:00 Noon  
Weather: Clear, 90°±  
Witnesses to corner location:

Bryan Meyer

Brian Forsythe

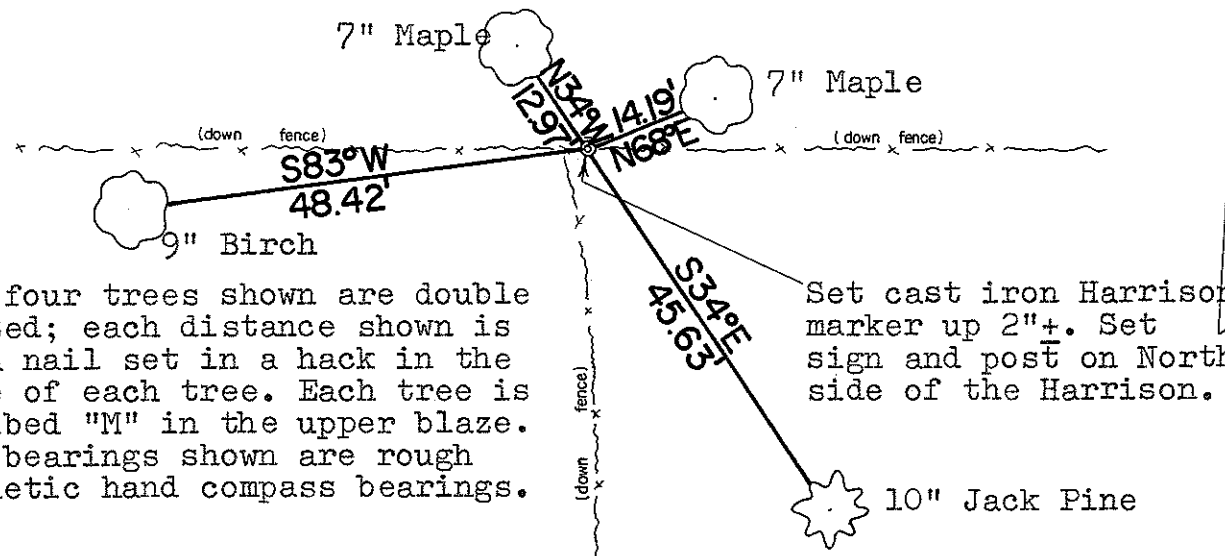

The four trees shown are double blazed; each distance shown is to a nail set in a hack in the side of each tree. Each tree is scribed "M" in the upper blaze. The bearings shown are rough magnetic hand compass bearings.

Set cast iron Harrison marker up 2"±. Set sign and post on North side of the Harrison.

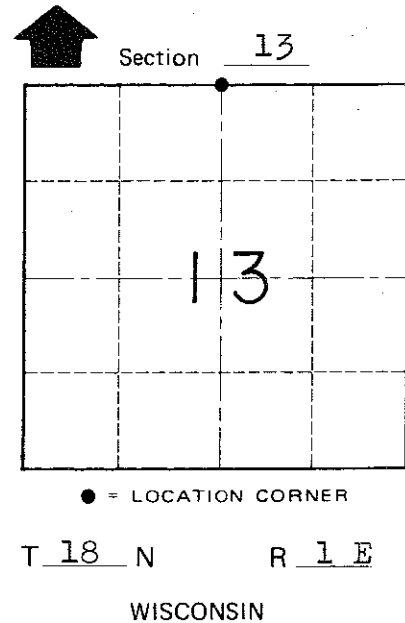

SURVEY CONTROL ORDER

Horizontal	_____
Vertical	_____

WISCONSIN COORDINATE SYSTEM

Corner	East (X)	North (Y)	Elevation (Z)	Zone
Control Sta. Name				

~~Byron Village~~ Town of Byron

County of Monroe