

CERTIFICATE

CERTIFIED LAND CORNER

No. 130

21704320020

I, Harley A. Sime, do hereby certify that on the 14 day of June 1976, I found ~~(evidence)~~ (no evidence) of the S¹/₄ corner of Sec. 32, T 17 N, R 4 W, Fourth Principal Meridian, and I re-established said corner according to the Wisconsin Statutes as shown and described hereon.

Dated this 9 day of July 1976.

Harley A. Sime
 COUNTY SURVEYOR
Title

History of original corner establishment:

Description of corner evidence found:

The distance between the SW & SE corners of Sec. 32 computed to be 5282.0'. I placed the corner on line and equidistant between the section corners; field conditions fit fairly well with the computed corner.

COUNTY SURVEYOR FORM NO. 1

Description of corner and witness monuments, references and accessories used to perpetuate the original or re-established location of this corner:

Witnesses to corner location:

D.J. Malliet, Crew chief, R.L.S.

A.L. Lueck

B. Meyer

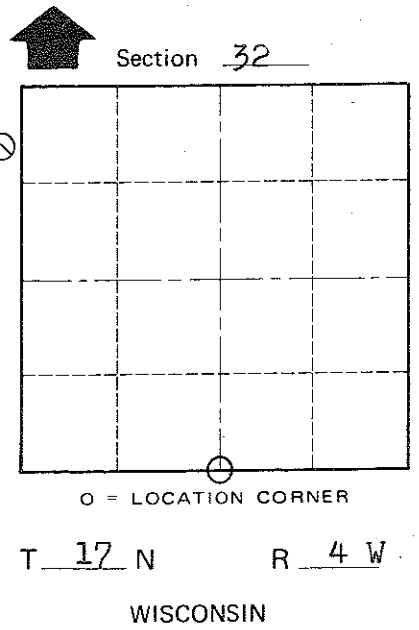
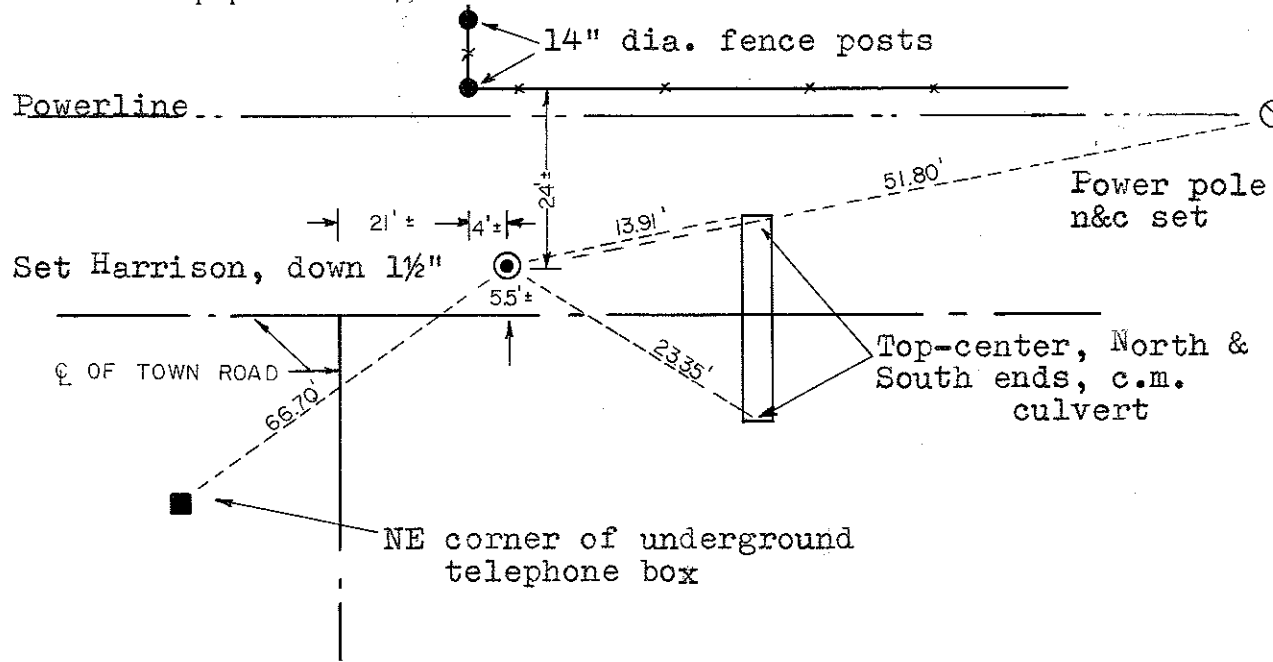
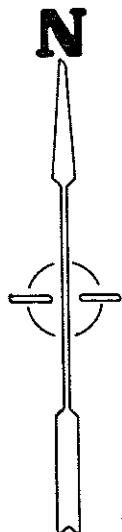
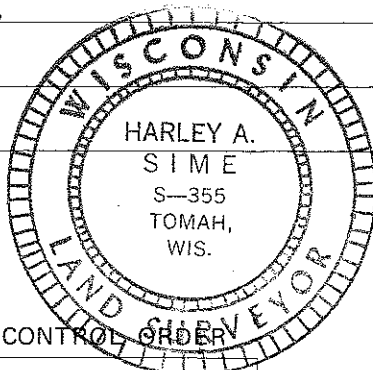

T 17 N R 4 W
 WISCONSIN

SURVEY CONTROL ORDER
Horizontal _____
Vertical _____

WISCONSIN COORDINATE SYSTEM

Corner	East (X)	North (Y)	Elevation (Z)	Zone
Control Sta. Name				

City, Village or Town of Sparta
 County of Monroe