

CERTIFICATE

CERTIFIED LAND CORNER

No. 96

21704292000

I, Harley A. Sime, do hereby certify that on the 6 day of January 1976, I found ~~(evidence)~~ (no evidence) of the E 1/4 corner of Sec. 29, T17 N, R 4 W, Fourth Principal Meridian, and I re-established said corner according to the Wisconsin Statutes as shown and described hereon.

Dated this 9 day of July 1976.

Harley A. Sime  
COUNTY SURVEYOR

History of original corner establishment:

Fred Holden visited this corner 16 Nov. 1899, under the direction of Hamilton LaRue.

Description of corner evidence found:

Accepted the existing field conditions, a 2-way fence corner as the best available evidence. This location agreed well with the rest of the section.

Description of corner and witness monuments, references and accessories used to perpetuate the original or re-established location of this corner:

A 1/4"x30" round iron bar was set in place of a Harrison, because of large tree roots.

Witnesses to corner location:

Douglas J. Malliet  
D.J. Malliet, Crew chief, R.L.S.  
G.A. Sime

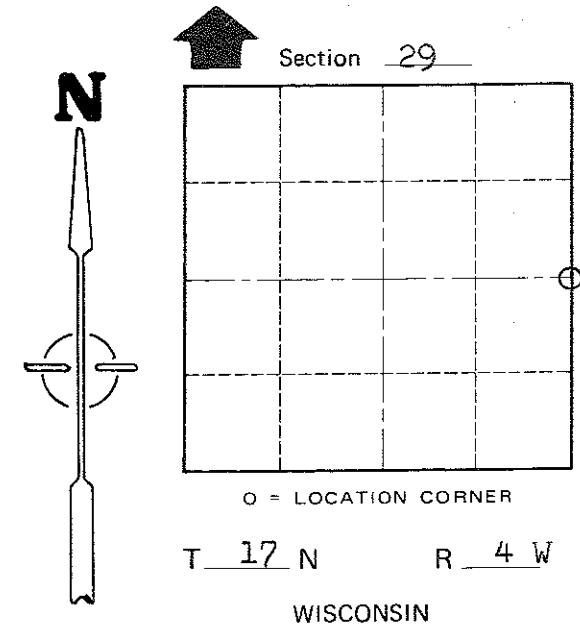
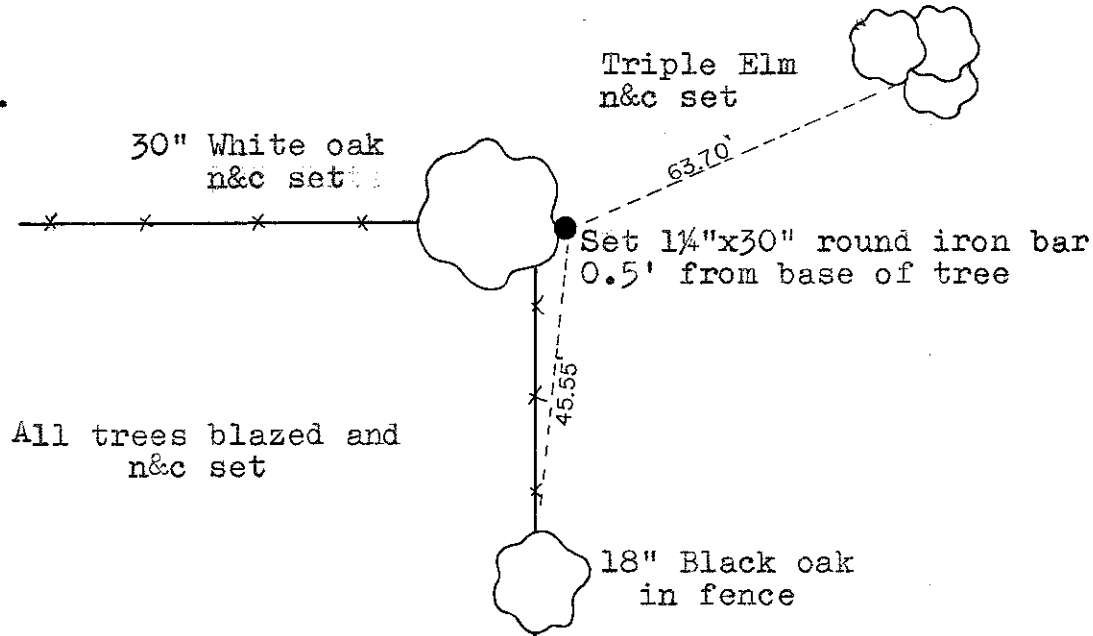
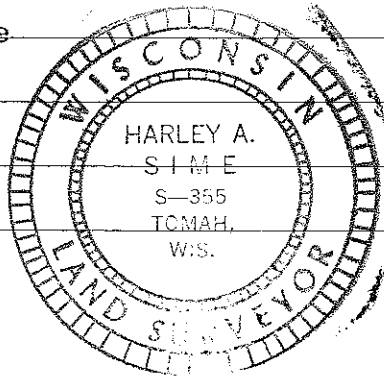

COUNTY SURVEYOR FORM NO. 1

SURVEY CONTROL ORDER

Horizontal \_\_\_\_\_  
Vertical \_\_\_\_\_

WISCONSIN COORDINATE SYSTEM				
Corner	East (X)	North (Y)	Elevation (Z)	Zone
Control Sta. Name				

City, Village or Town of Sparta

County of Monroe