

CERTIFICATE

CERTIFIED LAND CORNER

No. 97

21704282000

I, Harley A. Sime, do hereby certify that on the 14 day of June 1976, I found ~~(evidence)~~ (no evidence) of the E¹/₄ corner of Sec. 28, T 17 N, R 4 W, Fourth Principal Meridian, and I re-established said corner according to the Wisconsin Statutes as shown and described hereon.

Dated this 9 day of July 1976.

Harley A. Sime

COUNTY SURVEYOR

History of original corner establishment:

Description of corner evidence found:

I accepted the post at the NE corner of Sec. 28 and the computed location of the section corner at the SE corner of Sec. 28. The corner was placed on line and equidistant between the section corners. This location agreed well D.L. Mulock's survey of this line.

Description of corner and witness monuments, references and accessories used to perpetuate the original or re-established location of this corner:

Witnesses to corner location:

Douglas J. Malliet
D.J. Malliet, Crew Chief, R.L.S.

A.L. Lueck

B. Meyer

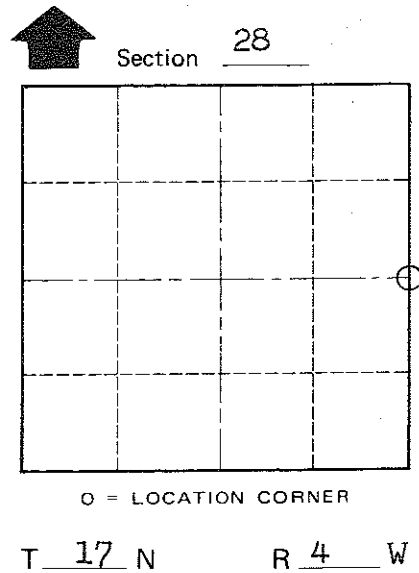
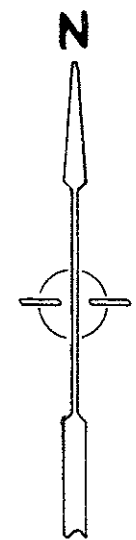
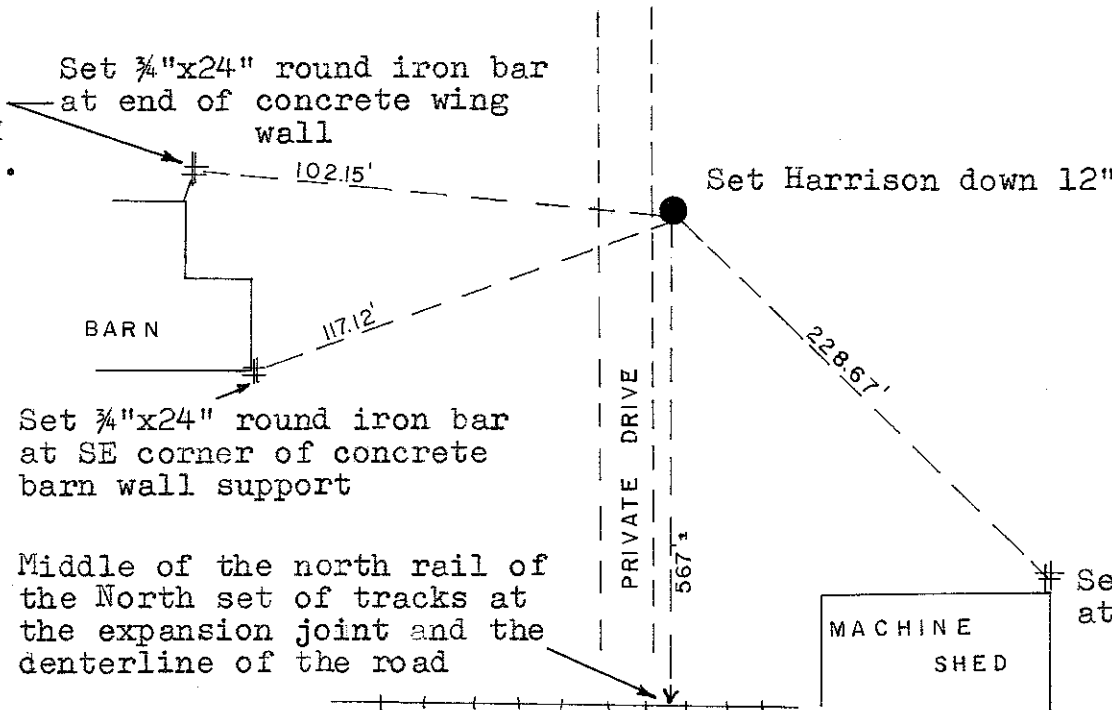
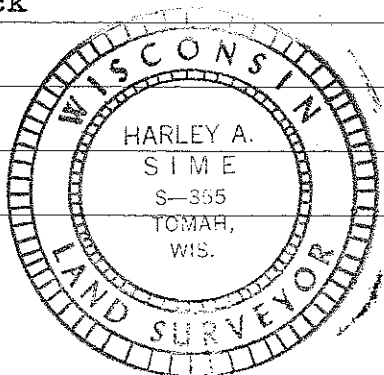

COUNTY SURVEYOR FORM NO. 1

SURVEY CONTROL ORDER

Horizontal	_____
Vertical	_____

WISCONSIN COORDINATE SYSTEM

Corner	East (X)	North (Y)	Elevation (Z)	Zone
Control Sta. Name				

City, Village or Town of Sparta

County of Monroe