

CERTIFICATE

CERTIFIED LAND CORNER

No. 105

21704270000

I, Harley A. Sime, do hereby certify that on the 23 day of July 19 76, I found (evidence) (~~no evidence~~) of the SW corner corner of Sec. 26, T 17 N, R 4 W, Fourth Principal Meridian, and I re-established said corner according to the Wisconsin Statutes as shown and described hereon.

Dated this 5 day of March 19 76.

Harley A. Sime

COUNTY SURVEYOR
Title

History of original corner establishment:

Description of corner evidence found:

Found existing 1 1/4" iron bar set by D.L. Mulock in March, 1964, and used in subsequent surveys; replaced the existing bar with a Harrison Monument.

Description of corner and witness monuments, references and accessories used to perpetuate the original or re-established location of this corner:

Set Harrison, Down 2"

Witnesses to corner location:

Douglas J. Malliet

D.J. Malliet - Crew Chief RLS

A. Lueck

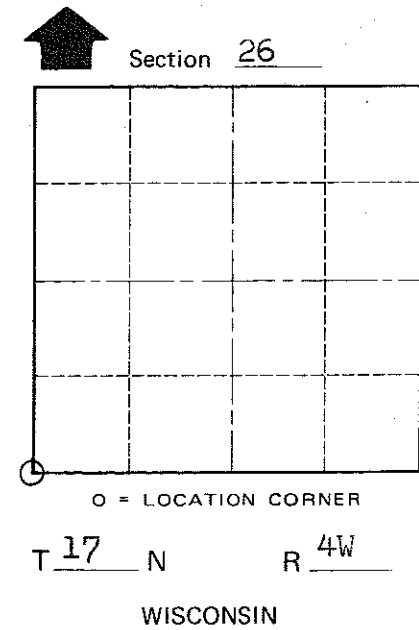
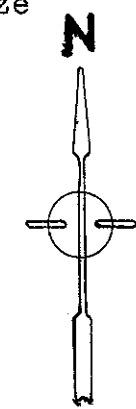
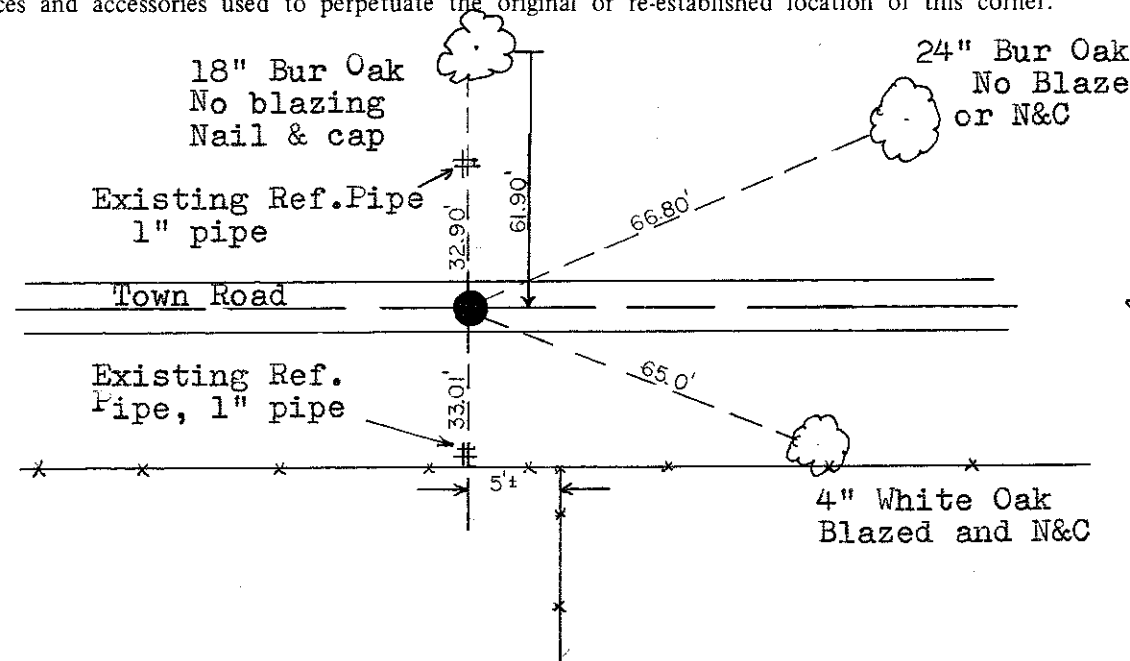
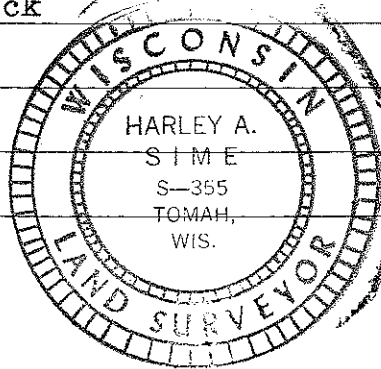

COUNTY SURVEYOR FORM NO. 1

SURVEY CONTROL ORDER

Horizontal	_____
Vertical	_____

WISCONSIN COORDINATE SYSTEM

Corner	East (X)	North (Y)	Elevation (Z)	Zone
Control Sta. Name				

City, Village or Town Sparta

County of Monroe