

78

**U.S. PUBLIC LAND CORNER
MAINTENANCE**

**Corner ID : E1/4 Sec.22, T17N-R4W
21704222000**

<u>DATE</u>	<u>CREW</u>	<u>MONUMENT TYPE</u> -----
November 28, 2018	Zachariah P. Dechant Gary L. Dechant	Existing Harrison intact, down 4". Sign 1½' east. On back lot line between 901 & 913 Pfaff Parkway.
<u>References:</u>		<u>Bearing</u> <u>Distance</u>
1) Set 3/4"x24" round iron bar, down 4", 7' east of 8" Cedar		N65E 12.48'
2) Set 3/4"x24" round iron bar, down 4", between two 14" Red Pines		S36E 14.96'
3) Set 3/4"x24" round iron bar, flush, 2' north & 2' west of NE corner of garage		S60W 15.27'
4) Set 3/4"x24" round iron bar, flush in lawn, 4' SE of triple 10" Birch		N42W 27.28'

Gary L. Dechant

December 9, 2018

CERTIFICATE

CERTIFIED LAND CORNER

No. 78

I, Harley A. Sime, do hereby certify that on the 6 day of July 19 76, I found (evidence) (no evidence) of the E¹/₄ corner of Sec. 22, T 17 N, R 4 W Fourth Principal Meridian, and I re-established said corner according to the Wisconsin Statutes as shown and described hereon.

Dated this 8 day of July 19 76.

Harley A. Sime
COUNTY SURVEYOR
Title

History of original corner establishment:

See Reverse Side For Maintenance

Description of corner evidence found:

Did not locate the iron pipe used by H.A. Sime as the E¹/₄ corner in 1967. The corner was reset, Sime's distances and monuments from his survey, using

Note: The corner was adjusted to its present position, as shown below, by Feddersen Engineering on May 16, 1977.

W.E.G. 2/9/78

Description of corner and witness monuments, references and accessories used to perpetuate the original or re-established location of this corner:

Witnesses to corner location:

D.J. Malliet, Crew chief, R.L.S. *Douglas & Malliet*

D.C. Dade

B. Meyer

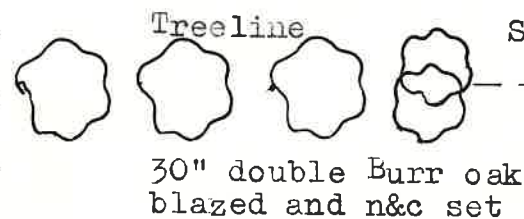
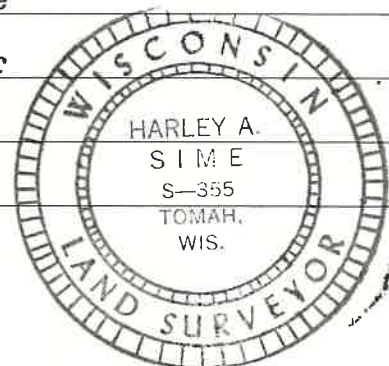

Set Harrison down 1"

68.93'

Set 3/4"x24" round iron bar, next to old wood post

SIGN PLACED 3-19-90 J. Sime

26.03'

45±

18.45'

Brace posts

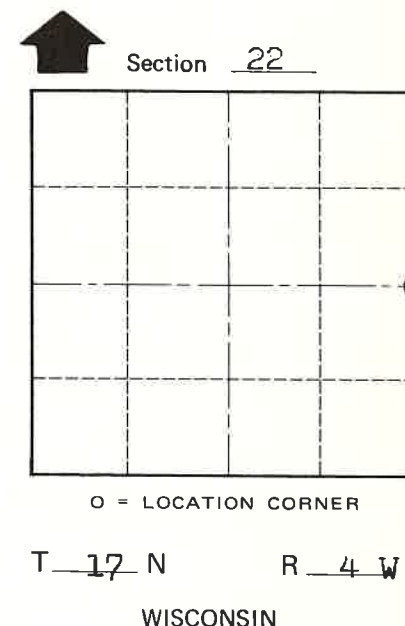
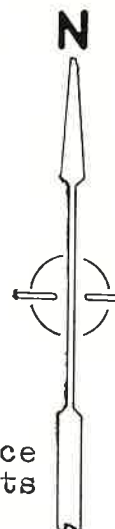

SURVEY CONTROL ORDER

Horizontal	_____
Vertical	_____

WISCONSIN COORDINATE SYSTEM

Corner	East (X)	North (Y)	Elevation (Z)	Zone
Control Sta. Name				

City, Village or Town of Sparta

County of Monroe

COUNTY SURVEYOR FORM NO. 1