

CERTIFICATE

CERTIFIED LAND CORNER

No. 89

I, Harley A. Sime, do hereby certify that on the 6th day of February 1976, I found ~~(evidence)~~ (no evidence) of the N.W. corner of Sec. 28, T 17 N, R 4 W Fourth Principal Meridian, and I re-established said corner according to the Wisconsin Statutes as shown and described hereon.

Dated this 24th day of July 1976.

Harley A. Sime
 COUNTY SURVEYOR
Title

History of original corner establishment:

Fred Holden was at this corner in November of 1899 and found an original government bearing tree.

Description of corner evidence found:

The corner was set so as to best match existing field evidence and occupation. This causes problems due to the shortage West and North. Existing conditions however show that the corner as set is in the best possible position. To set it by any other method would cause severe title problems. An effort was made to locate signs of Holden's bearing tree, but with no success.

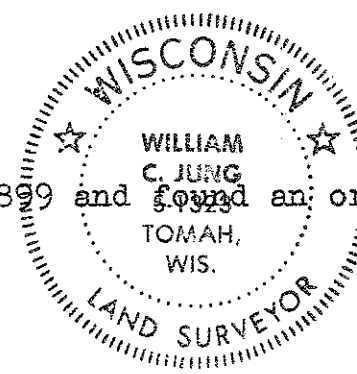

21704200000

COUNTY SURVEYOR FORM NO. 1

Description of corner and witness monuments, references and accessories used to perpetuate the original or re-established location of this corner:

Set a 2"x72" iron pipe in the water.

Witnesses to corner location:

D. Malliet - Clerk

A. Lueck

W. Jung - Witness

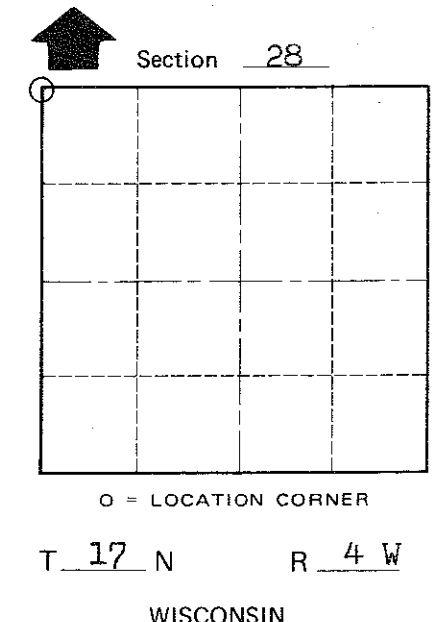
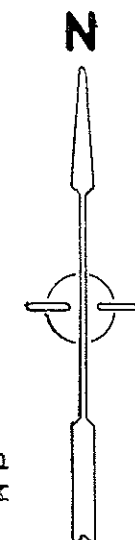
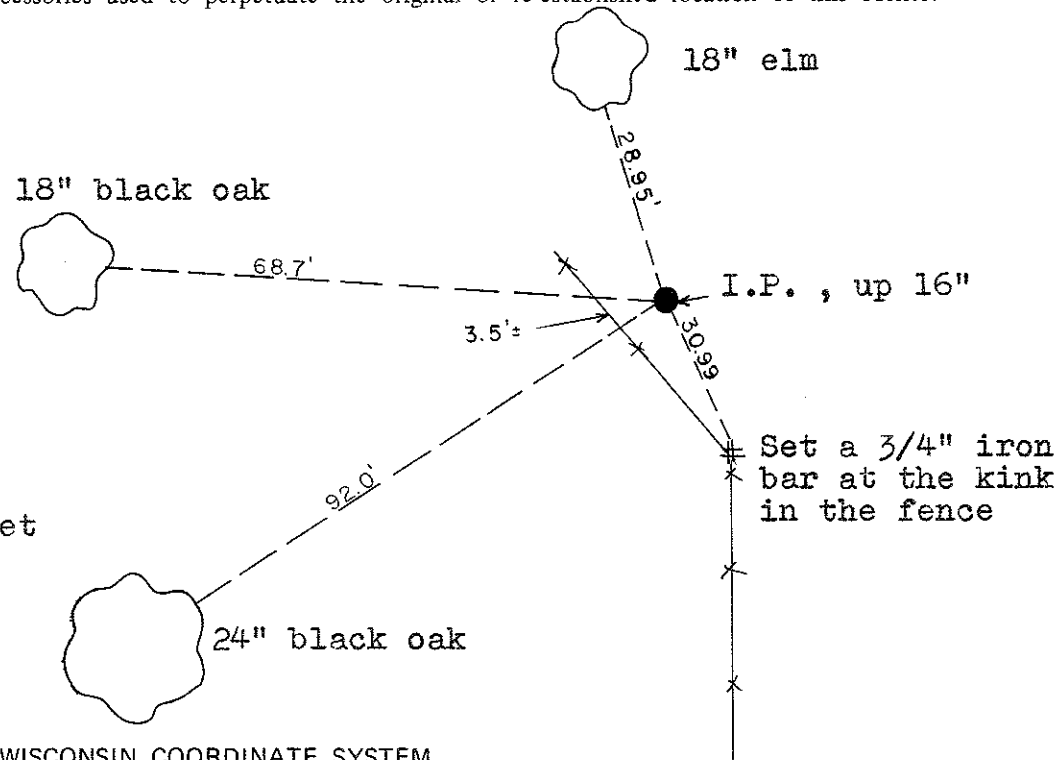
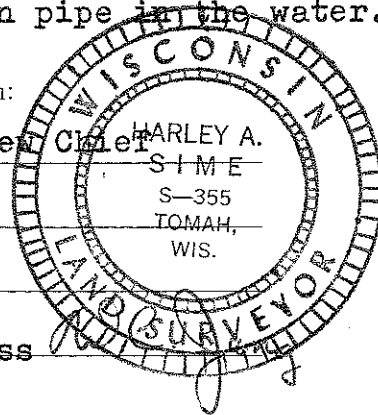

Note: All trees blazed with n&c's set in them.

SURVEY CONTROL ORDER

Horizontal	_____
Vertical	_____

WISCONSIN COORDINATE SYSTEM

Corner	East (X)	North (Y)	Elevation (Z)	Zone
Control Sta. Name				

City, Village or Town Sparta
 County of Monroe