

55

**U.S. PUBLIC LAND CORNER
MAINTENANCE**

Corner ID : E1/4 Sec. 18, T17N-R4W

21704182000

| <u>DATE</u> | <u>CREW</u> | <u>MONUMENT TYPE -----</u> |
|--|--|--|
| December 10, 2015 | Zachariah P.Dechant Gary L. Dechant | Existing Harrison, top broke off, down 12" 3' south centerline Hamilton Ave, 141' west of driveway Fire No. 4946 Hamilton, 40d nails 1' N & W. |
| <u>References:</u> | | <u>Bearing</u> <u>Distance</u> |
| 1) Set 3/4"x24" iron bar, down 6", 1' east of angle iron post | | North 26.79' |
| 2) Set 3/4"x24" iron bar, down 12" in field | | S39E 48.06' |
| 3) Set 3/4"x24" iron bar, down, 12" in field | | South 35.79' |
| 4) Set 3/4"x24" iron bar, down 12" in field, west side of field entrance | | N39W 57.15' |

Harrison and reference markers set on straight lines.



I, Harley A. Sime, do hereby certify that on the 25 day of April 1975, I found ~~(evidence)~~ (no evidence) of the E 1/4 corner of Section 18, T 17 N, R 4W, Fourth Principal Meridian, and I re-established said corner according to the Wisconsin Statutes as shown and described hereon.

Dated this 19 day of Jan. 1976.

Harley A. Sime
County Surveyor
Title

History of original corner establishment:

**See Reverse Side
For Maintenance**

Description of corner evidence found:

Set the corner proportionately between the section corners.

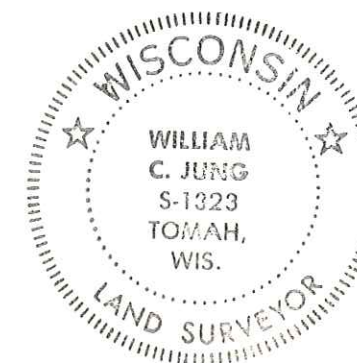

Description of corner and witness monuments, references and accessories used to perpetuate the original or re-established location of this corner:

Set a Harrison marker in the road, down 1".

Witnesses to corner location:

W.C. Jung - Crew Chief *W.C. Jung*

D. Malliet

A. Lueck

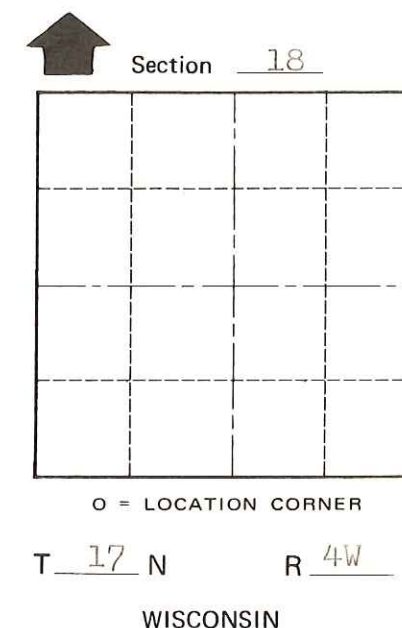
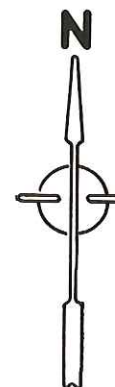
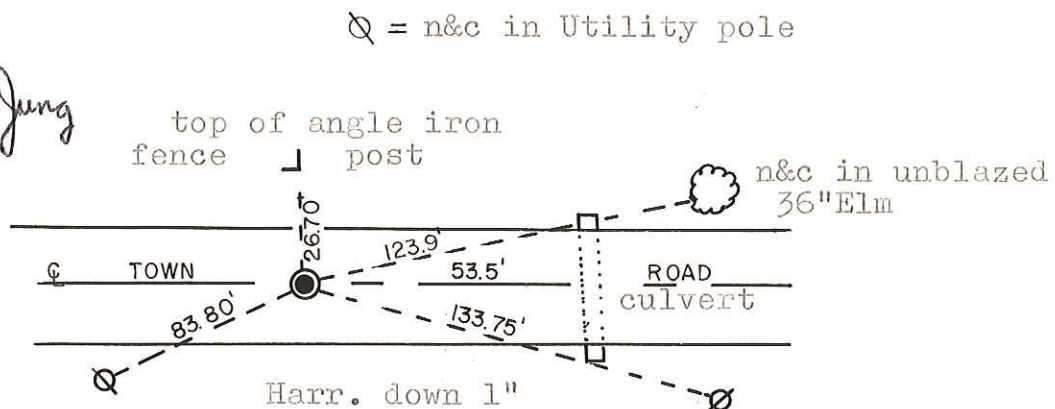
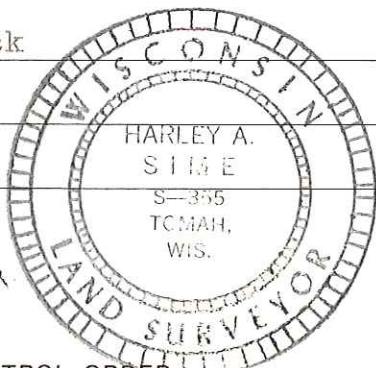

SURVEY CONTROL ORDER

| | |
|------------|-------|
| Horizontal | _____ |
| Vertical | _____ |

WISCONSIN COORDINATE SYSTEM

| Corner | East (X) | North (Y) | Elevation (Z) | Zone |
|-------------------|----------|-----------|---------------|------|
| Control Sta. Name | | | | |

City, Village or Town Sparta

County of Monroe

COUNTY SURVEYOR FORM NO. 1