

41

**U.S. PUBLIC LAND CORNER
MAINTENANCE**

Corner ID : SE Sec. 12, T17N-R4W

21704120000

<u>DATE</u>	<u>CREW</u>	<u>MONUMENT TYPE</u>
November 19, 2018	Zachariah P. Dechant Gary L. Dechant	Found Harrison intact, 14' north of gravel road. Set new sign 1/2' NW.

<u>References:</u>	<u>Bearing</u>	<u>Distance</u>
1) Set 3/4"x 24" round iron bar, down 10" in field, 40' south of road	S16E	56.29'
2) Set 3/4"x 24" round iron bar, down 10" in field	S26W	60.03'
3) Set 3/4"x 24" round iron bar, down 4", 4' SE of Quintuplet 6" Ash	N62W	38.41'
4) Set 3/4"x 24" round iron bar, down 2" in lawn	N34W	22.26'

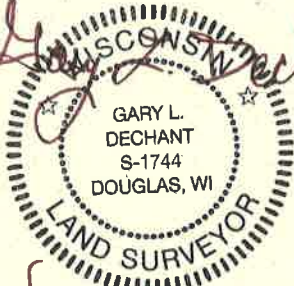
Zachariah P. Dechant

November 19, 2018

CERTIFICATE

CERTIFIED LAND CORNER

No. 41

I, Harley A. Sime, do hereby certify that on the 18 day of July 1975, I found (evidence) (~~no evidence~~) of the S.E. corner of Section 12, T 17 N, R 4W, Fourth Principal Meridian, and I re-established said corner according to the Wisconsin Statutes as shown and described hereon.

Dated this 15 day of Jan. 1976.

Harley A. Sime

County Surveyor

Title

History of original corner establishment:

Description of corner evidence found:

Found an iron bar that had been used in previous surveys. Removed the iron bar and replaced it with a Harrison marker.



See Reverse Side For Maintenance

Description of corner and witness monuments, references and accessories used to perpetuate the original or re-established location of this corner:

Set a Harrison, up 3", 6" South of fence and near a painted steel fence post.

Witnesses to corner location:

W.C. Jung - Crew Chief *W.C. Jung*

G. Dechant

A. Lueck

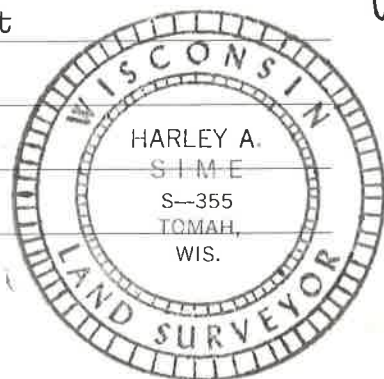

Ø = n&c in utility pole

SIGN PLACED 11/24/86 Meyer, Kenworthy

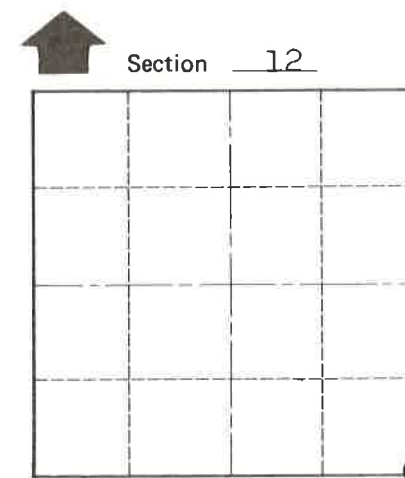
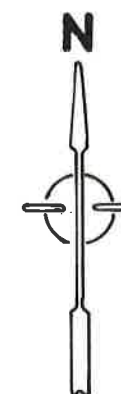
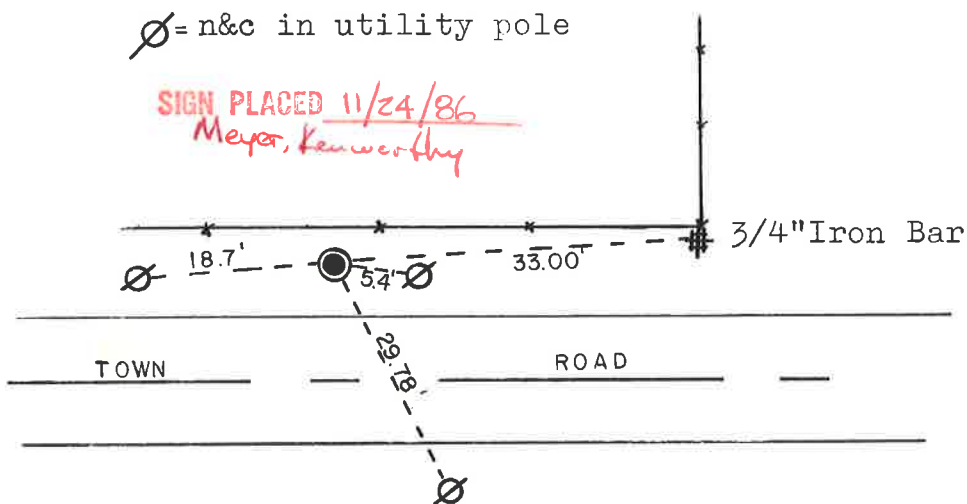

Ø = LOCATION CORNER

T 17 N R 4W

WISCONSIN

SURVEY CONTROL ORDER

Horizontal _____
Vertical _____

WISCONSIN COORDINATE SYSTEM

Corner	East (X)	North (Y)	Elevation (Z)	Zone
Control Sta. Name				

City, Village or Town Sparta

County of Monroe

COUNTY SURVEYOR FORM NO. 1