

# 39

**U.S. PUBLIC LAND CORNER  
MAINTENANCE**

**Corner ID :** E1/4 Sec.11, T17N-R4W  
**21704112000**

<u>DATE</u>	<u>CREW</u>	<u>MONUMENT TYPE</u> -----
September 3, 2015	Zachariah P. Dechant Gary L. Dechant	Existing 1 1/4" round iron bar at intersection of CTH "B" & General Ave.

References:

	<u>Bearing</u>	<u>Distance</u>
1) Set 3/4"x24" hex iron bar, down 12" in field	N39E	61.15'
2) Set 3/4"x24" hex bar, down 6" in lawn	S52E	68.72'
3) Set 3/4"x24" hex iron bar, down 12" in field	S39W	56.38'
4) Set 3/4"x24" hex iron bar, down, 6" in gravel drive	N52W	81.05'

Harrison & reference markers set on straight line.

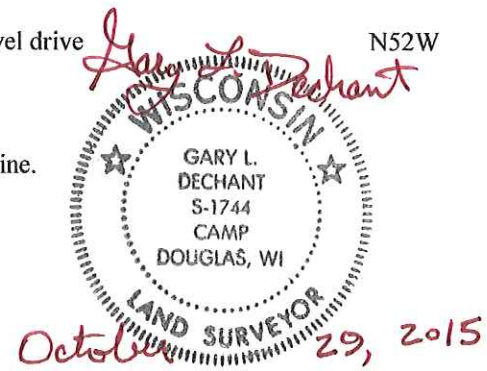

I, Harley A. Sime, do hereby certify that on the 9 day of April 1975, I found (evidence) ~~(no evidence)~~ of the W 1/4 corner of Section 12, T 17 N, R 4W, Fourth Principal Meridian, and I re-established said corner according to the Wisconsin Statutes as shown and described hereon.

Dated this 15 day of Jan 1976.  
Harley A. Sime  
County Surveyor  
Title

History of original corner establishment:

Description of corner evidence found:

Found an iron bar in the road that had been used in previous surveys. Removed the iron bar and replaced it with a Harrison marker.

See Reverse Side For Maintenance

COUNTY SURVEYOR FORM NO. 1

Description of corner and witness monuments, references and accessories used to perpetuate the original or re-established location of this corner:  
Set a Harrison in the road intersection, down 1".

Witnesses to corner location:

W.C. Jung - Crew Chief W.C. Jung  
D. Malliet  
G. Sime

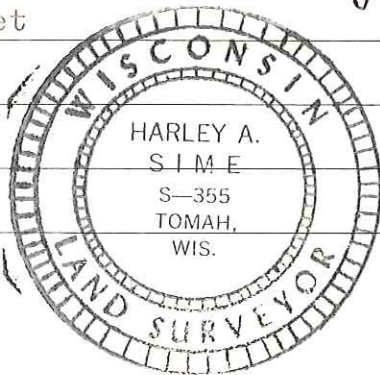

Ø=n&c in utility pole

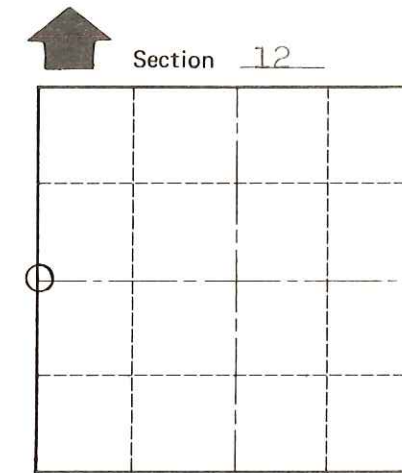
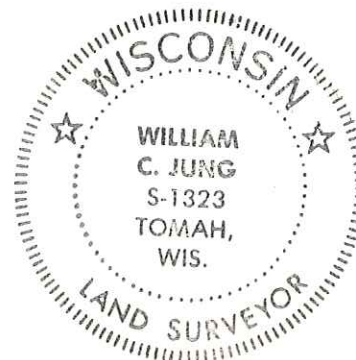
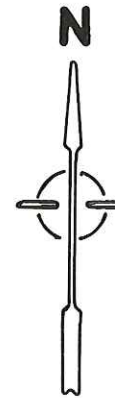
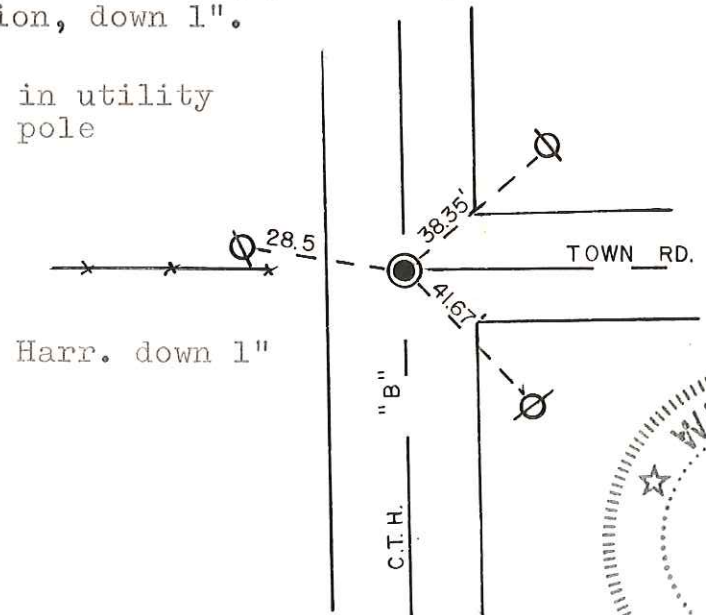

○ = LOCATION CORNER  
T 17 N R 4W  
WISCONSIN

SURVEY CONTROL ORDER

Horizontal \_\_\_\_\_  
Vertical \_\_\_\_\_

WISCONSIN COORDINATE SYSTEM

Corner	East (X)	North (Y)	Elevation (Z)	Zone
Control Sta. Name				

City, Village or Town Sparta

County of Monroe