

# U.S. PUBLIC CERTIFIED LAND CORNER

Corner No. 45

Type of Monument: Cast Iron County Monument

Corner NW

County Coordinates:

Section 14

Town 17N

Range 4W

Elevation: \_\_\_\_\_

Witnesses: Zachariah P. Dechant

Gary L. Dechant

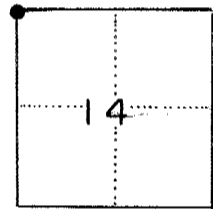
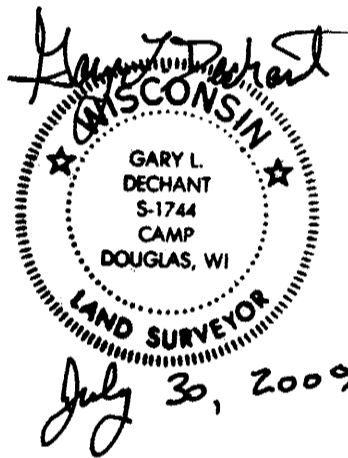

**HISTORY:**

H.A. Sime and Associates found a well point at this corner in April of 1975, accepted it and replaced it with a Harrison Monument.

**Evidence/Method of Location:**

Found Harrison in good condition but witness monuments have been destroyed. New witness monuments were placed.

**Drawing of Corner:**

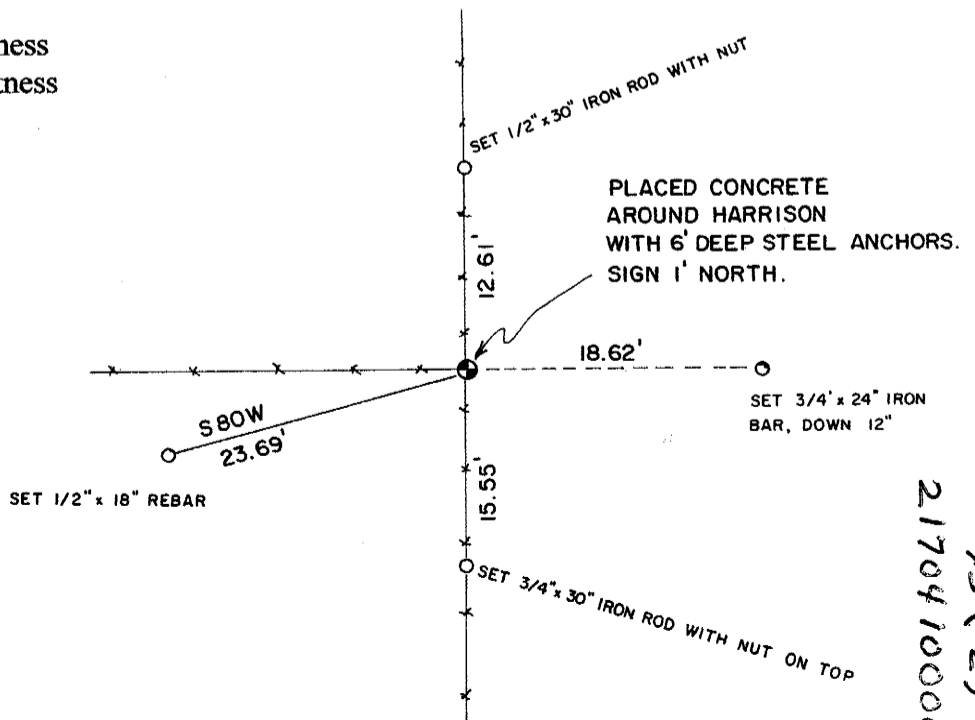

45 (2)  
21704100000