

CERTIFICATE

CERTIFIED LAND CORNER

No. 37

21704092000

I, Harley A. Sime, do hereby certify that on the 19 day of March 1975, I found (evidence) ~~(no evidence)~~ of the E 1/4 corner of Section 9, T17 N, R 4W, Fourth Principal Meridian, and I re-established said corner according to the Wisconsin Statutes as shown and described hereon.

History of original corner establishment:

Description of corner evidence found:

Found a stone, up 14", with a 1" iron pipe near the bottom North side of the stone, both near a double oak. The stone was not in the county records, but does fit the East line of Section 9. It was also used in a certified survey of May, 1963.

Dated this 15 day of Jan. 1976.

Harley A. Sime
County Surveyor
Title

3/12/81
old stone set by Keach in June of 1909.
W.C.J.

Description of corner and witness monuments, references and accessories used to perpetuate the original or re-established location of this corner:

Found a stone, up 14", with a 1" iron pipe on the North side of it.

(Tie trees blazed)

Witnesses to corner location:

W.C. Jung - Crew Chief W.C. Jung
D. Malliet

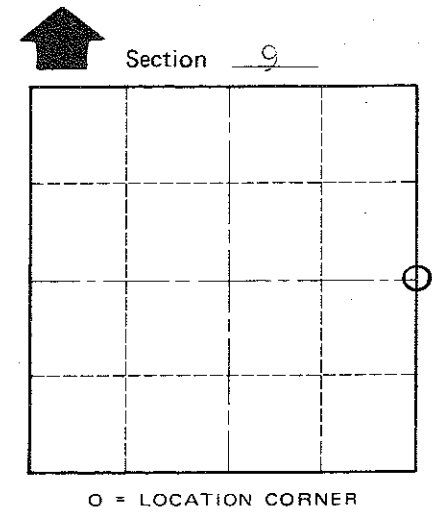
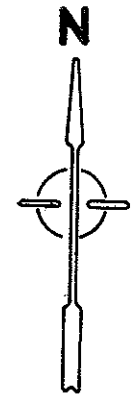
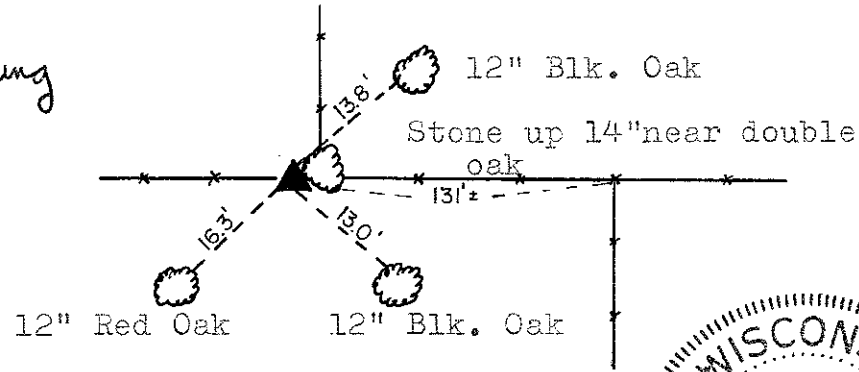

T 17 N R 4W
WISCONSIN

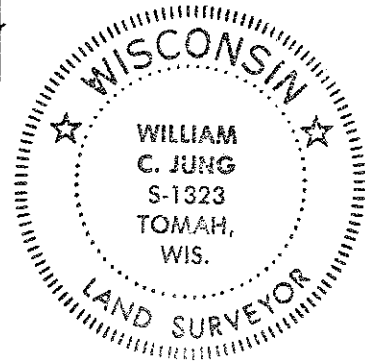
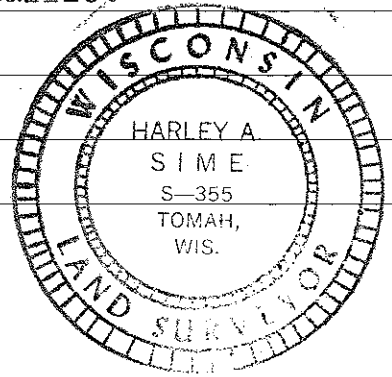

COUNTY SURVEYOR FORM NO. 1

SURVEY CONTROL ORDER

Horizontal	_____
Vertical	_____

WISCONSIN COORDINATE SYSTEM

Corner	East (X)	North (Y)	Elevation (Z)	Zone
Control Sta. Name				

City, Village or Town Sparta
County of Monroe