

# 36

**U.S. PUBLIC LAND CORNER  
MAINTENANCE**

**Corner ID :** E1/4 Sec. 8, T17N-R4W  
**21704082000**

<u>DATE</u>	<u>CREW</u>	<u>MONUMENT TYPE</u> -----
October 5, 2015	Zachariah P. Dechant Gary L. Dechant	Found Harrison in field, down 12". Appears to be slightly leaning, but must have been set that way as it fits the two remaining ties.

References:

	<u>Bearing</u>	<u>Distance</u>
1) Existing 3/4" round iron bar at fence corner	North	90.91'
2) Set 3/4"x24" round iron bar, down 12" in field	South	23.17'
3) Existing (GPS) monument in concrete south of CTH "BC"	S15W	320.70 '(320.70)''
4) Existing 3/4" round iron bar, 2' east of power pole north of CTH "BC"	S32W	272.25' (272.25')
5) Set 3/4"x24" round iron bar, down 12" in field	West	26.27'



I, Harley A. Sime, do hereby certify that on the 2 day of May 19 75, I found ~~(evidence)~~ (no evidence) of the W 1/4 corner of Section 9, T. 17 N, R. 4W, Fourth Principal Meridian, and I re-established said corner according to the Wisconsin Statutes as shown and described hereon.

Dated this 15 day of Jan. 19 76.

Harley A. Sime  
County Surveyor  
Title

History of original corner establishment:

Description of corner evidence found:

Set the corner by projecting a line through the C<sup>1</sup>/<sub>4</sub> and E<sup>1</sup>/<sub>4</sub> corners of Section 9 and intersecting this line with the West line of the NW<sup>1</sup>/<sub>4</sub> of Section 9. See the miscellaneous sheet behind, corner sheet for more detailed information.  
this

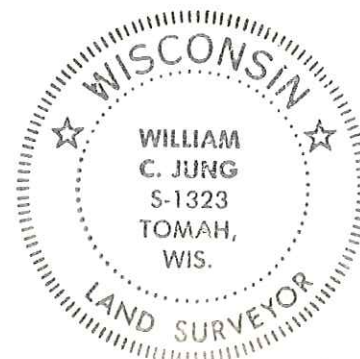

See Reverse Side For Maintenance

COUNTY SURVEYOR FORM NO. 1

Description of corner and witness monuments, references and accessories used to perpetuate the original or re-established location of this corner:

Set a Harrison marker in an open field, down 12".  $\odot$  = Utility pole

Witnesses to corner location:

W.C. Jung - Crew Chief W.C. Jung

A. Lueck

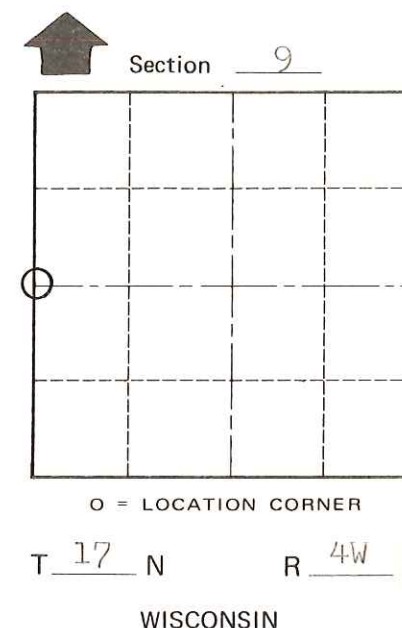
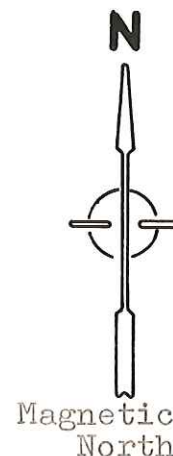
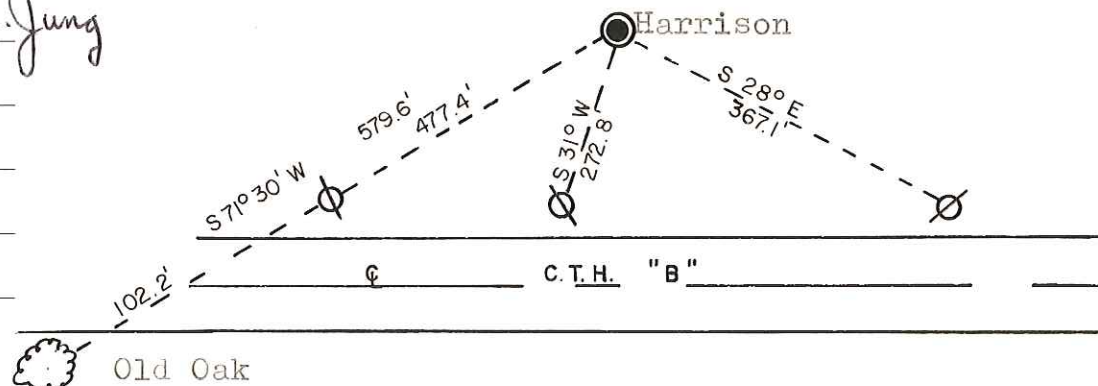
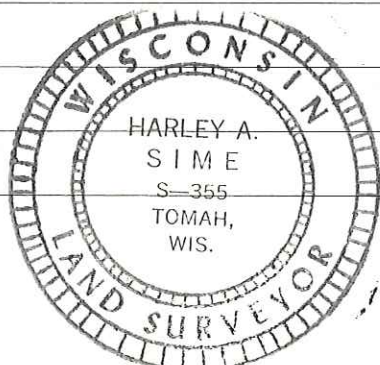

SURVEY CONTROL ORDER

Horizontal	_____
Vertical	_____

WISCONSIN COORDINATE SYSTEM

Corner	East (X)	North (Y)	Elevation (Z)	Zone
Control Sta. Name				

City, Village or Town Sparta

County of Monroe

MISCELLANEOUS SHEET ( In regards to Section 8-T17N-R4W )

On April 18, 1975, I talked to Tracy Humphrey, age 78, father of Donald Humphrey. He stated that in about 1910 there was a dispute between his father and the farmer to the East in Section 9. A surveyor (Fred Holden?) was called in to establish the East line of Section 8: The surveyor found an original bearing tree at the Northeast corner of Section 8 and then put an iron pipe at the section corner. Mr. Humphrey stated that this was the same pipe that we found and replaced with a Harrison monument. The surveyor went South and found that the fence corner at the Southeast corner of Section 8 was good. The surveyor also put an iron pipe at the Southeast corner of the NE1/4-NE1/4 of Section 8. We found a bent 1" iron pipe at said forty corner and replaced it with a 1½" round iron bar. The presently occupied fence corner at the Southeast corner of Section 8 was within 5 feet of the original government survey distance and more or less on line with the Northeast corner of Section 8 and previously mentioned forty corner. With this in mind we accepted the fence corner at the Southeast corner of Section 8 as the correct corner. The Harrison monument we set at the East 1/4 corner of Section 8 fell in the old fence line established in 1910. The fence was gone in 1975 but one could see where it had been. The distance we set for the East line the NE1/4 of Section 8 is long but was so established after surveying out all of Section 9 and tying into existing monuments and evidence. The terrain along the East line of aforesaid Northeast 1/4 of Section 8 is fairly rugged, thus accounting for error in earlier surveys. I might also add that Mr. Humphrey's testimony seemed very accurate in all respects. He even told how the old surveyor peeled the bark back to identify the old bearing tree.

I certify that the above statement is true and accurate to the best of my knowledge and belief.

*William C. Jung*

William C. Jung  
County Surveyor's Office  
Monroe County, Wi.

January 8, 1976

