

**U.S. PUBLIC LAND CORNER
MAINTENANCE**

51

Corner ID: SE Sec. 7, T17N-R4W
21704070000

<u>DATE</u>	<u>CREW</u>	<u>MONUMENT INFO</u>		
April 23, 2020	Zachariah P. Dechant Gary L. Dechant	Existing Harrison, top broke off, down 20", 3' south of center of Garden Ave, 18' west of driveway 5003 Garden Set small mason nails 2' north & east	<u>Compass Bearing</u>	<u>Distance</u>
1)	Set 3/4"x24" round iron bar, down 10" in field		N14E	49.10'
2)	Set 3/4"x24" round iron bar, down 2" 4' NW of 14" Spruce in lawn		S45E	51.44'
3)	Set 3/4"x24" round iron bar, west of driveway for 4983 Garden, down 2" in lawn		S14W	48.99'
4)	Set 3/4"x24" round iron bar, down 10" in field		N45W	61.00'

Corner and reference markers set on straight lines.

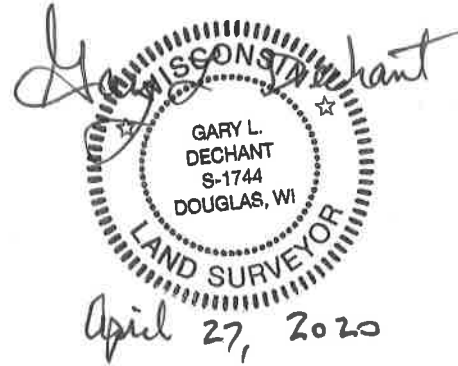

CERTIFICATE

CERTIFIED LAND CORNER

No. 51

I, Harley A. Sime, do hereby certify that on the 25 day of April 1975, I found ~~evidence~~ (no evidence) of the N.E. corner of Section 18, T 17 N, R 4W, Fourth Principal Meridian, and I re-established said corner according to the Wisconsin Statutes as shown and described hereon.

History of original corner establishment:



Description of corner evidence found:

Accepted the intersection of the road and North line fence as the corner. This fits the overall conditions very well.

Dated this 19 day of Jan. 1976.

Harley A. Sime
County Surveyor
Title

See Reverse Side
For Maintenance

Description of corner and witness monuments, references and accessories used to perpetuate the original or re-established location of this corner:

Set a Harrison marker in the road, down 1".

Witnesses to corner location:

W.C. Jung - Crew Chief *W.C. Jung*
D. Malliet
A. Lueck

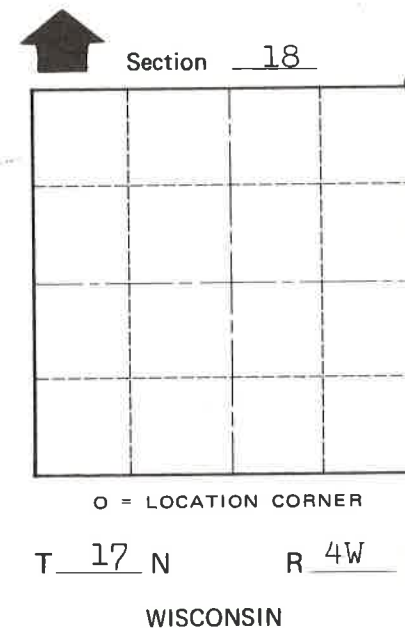
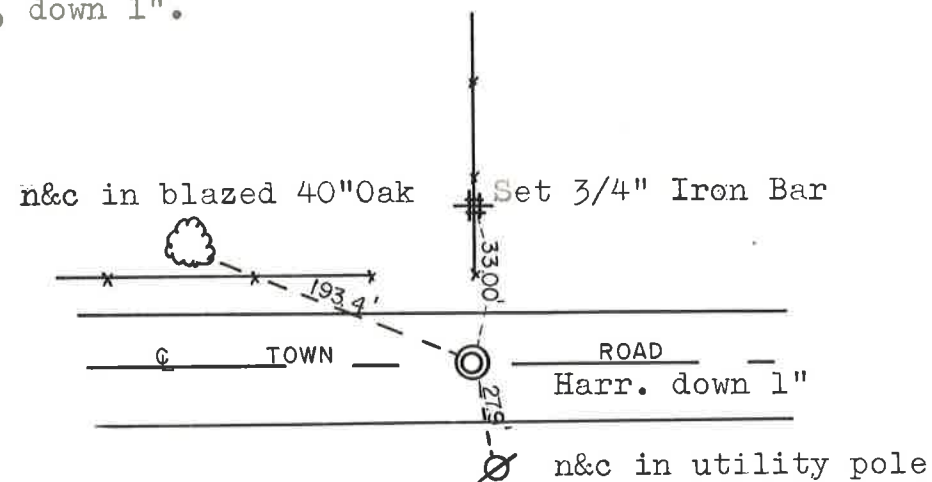
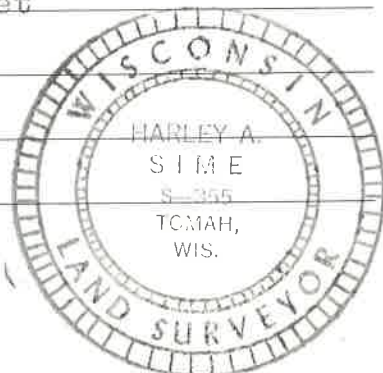

SURVEY CONTROL ORDER

Horizontal _____
Vertical _____

WISCONSIN COORDINATE SYSTEM

Corner	East (X)	North (Y)	Elevation (Z)	Zone
Control Sta. Name				

City, Village or Town Sparta
County of Monroe

COUNTY SURVEYOR FORM NO. 1