

U.S. LAND CORNER MAINTENANCE

Corner ID : E¼ Sec. 6, T17N-R4W
21704062000

<u>DATE</u>	<u>CREW</u>	<u>MONUMENT TYPE -----</u>
August 17, 2013	Zachariah P. Dechant Gary L. Dechant	Existing Harrison, down 8", Set sign 1' West

References:

Set ¾"x24" hexagon iron bar, down 8", ½ way between power pole and anchor
Set ¾"x24" hexagon iron bar iron, down 12"
Set ¾"x24" hexagon iron bar, down 15"
Set ¾"x24" hexagon iron bar, down 8", 1.5' west of old power pole, now used as fence post

<u>Bearing</u>	<u>Distance</u>
N28E	20.31'
S7W	19.27'
S86W	25.09'
N6E	25.02'

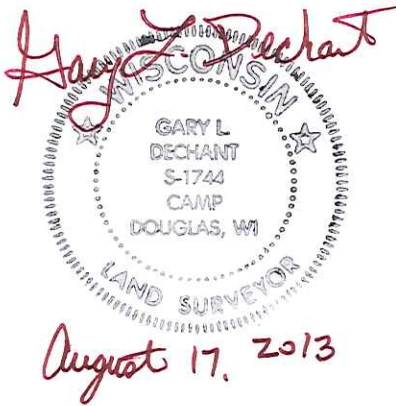

CERTIFICATE

CERTIFIED LAND CORNER

No. 15

21704062000

I, Harley A. Sime, do hereby certify that on the 2 day of May, 1975, I found (evidence) (no evidence) of the E 1/4 corner of Section 6, T17 N, R 4W, Fourth Principal Meridian, and I re-established said corner according to the Wisconsin Statutes as shown and described hereon.

Dated this 14 day of Jan., 1976.

Harley A. Sime
County Surveyor
Title

History of original corner establishment:

Description of corner evidence found:

Set at a proportionate distance between the section corners.

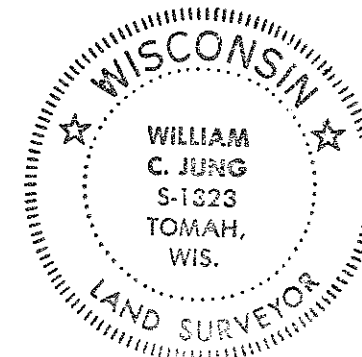

COUNTY SURVEYOR FORM NO. 1

Description of corner and witness monuments, references and accessories used to perpetuate the original or re-established location of this corner:
Set a Harrison marker, down 8".

Witnesses to corner location:

W.C. Jung - Crew Chief W.C. Jung
A. Lueck

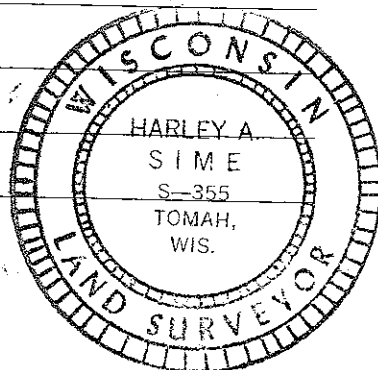

Ø = Utility pole with a n&c

Harrison down 8" on edge of field.

N.E. Corner of steel post

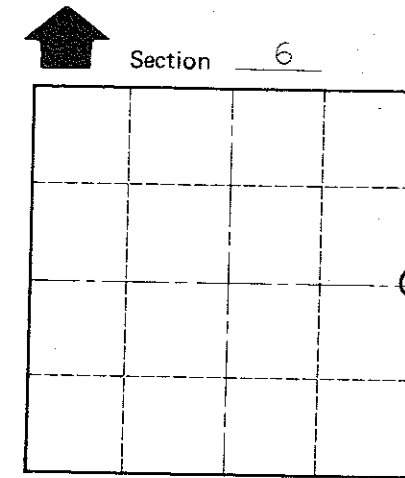
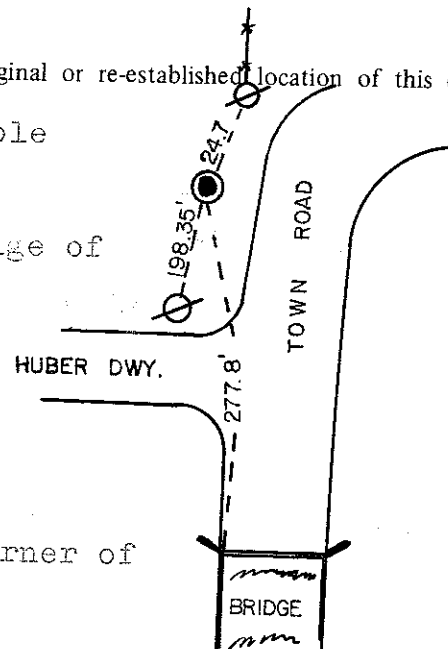

Ø = LOCATION CORNER

T 17 N R 4W

WISCONSIN

SURVEY CONTROL ORDER

Horizontal	_____
Vertical	_____

WISCONSIN COORDINATE SYSTEM

Corner	East (X)	North (Y)	Elevation (Z)	Zone
Control Sta. Name				

City, Village or Town Sparta

County of Monroe