

CERTIFICATE

CERTIFIED LAND CORNER

No. 27

**21704040000**

I, Harley A. Sime, do hereby certify that on the 27 day of March 1975, I found (evidence) ~~(no evidence)~~ of the S.W. corner of Section 3, T 17 N, R 4 W E, Fourth Principal Meridian, and I re-established said corner according to the Wisconsin Statutes as shown and described hereon.

Dated this 14 day of Jan. 1976.

Harley A. Sime  
County Surveyor  
Title

History of original corner establishment:

Description of corner evidence found:

Found a loaf like sandstone at a 3-way fence. The stone was not on record. It might have been just a brace stone, but to us it didn't appear to be. With this in mind and the fact that the fence corner was a "strong" occupied one, we accepted it as the best available evidence. Further surveying showed this corner to check out fairly well.

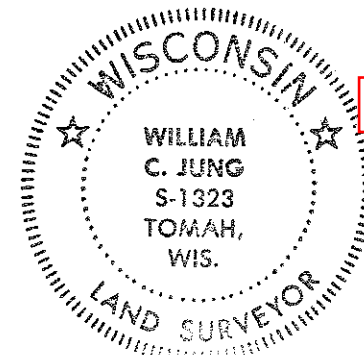

COUNTY SURVEYOR FORM NO. 1

Description of corner and witness monuments, references and accessories used to perpetuate the original or re-established location of this corner:

Set a Harrison marker at the fence corner, up 6", and placed the stone next to it. Harrison is also 1 ft. West of a small oak.

Witnesses to corner location:

W.C. Jung - Crew Chief *W.C. Jung*  
D. Malliet

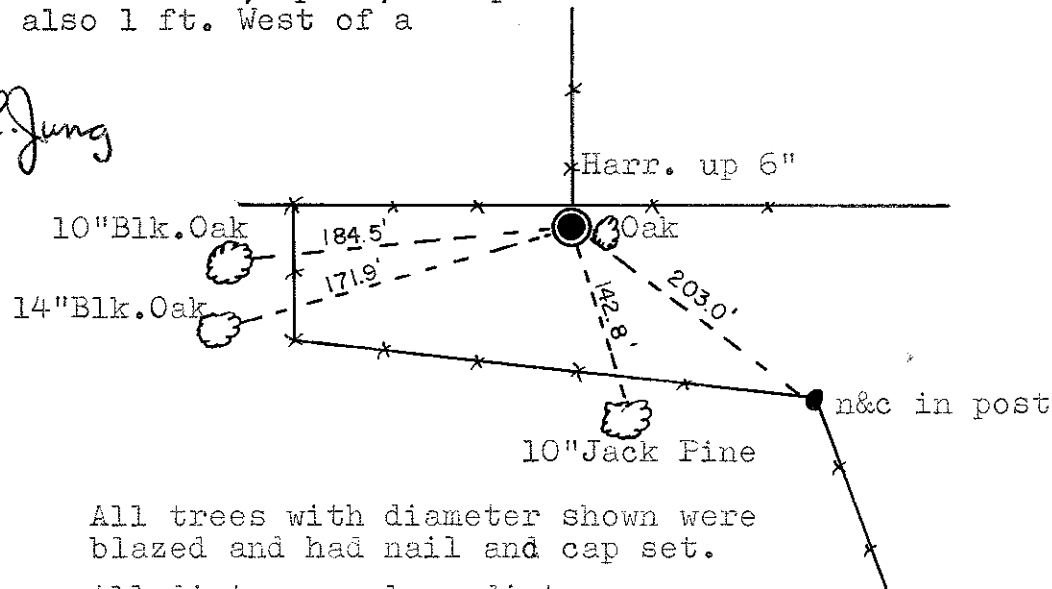
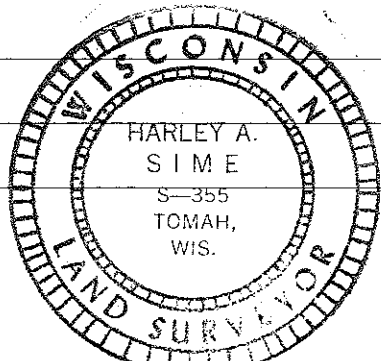

All trees with diameter shown were blazed and had nail and cap set.

All dist. are slope dist.

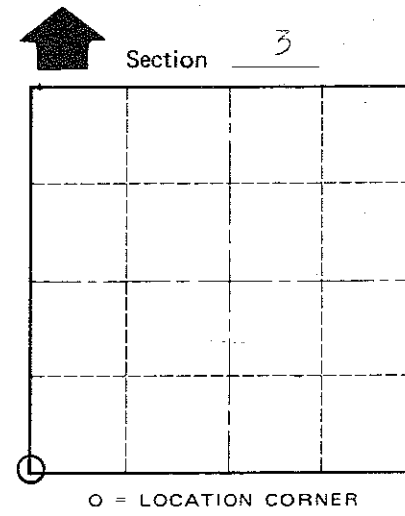
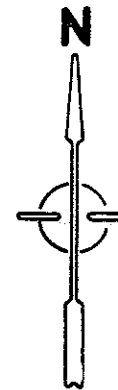

T 17 N R 4 W  
WISCONSIN

SURVEY CONTROL ORDER

Horizontal	_____
Vertical	_____

WISCONSIN COORDINATE SYSTEM

Corner	East (X)	North (Y)	Elevation (Z)	Zone
Control Sta. Name				

City, Village or Town Sparta  
County of Monroe