

CERTIFICATE

CERTIFIED LAND CORNER

No. 111

21702300000

I, Lawrence A. Feddersen, do hereby certify that on the eighteenth day of November 19 93, I found (evidence) (no evidence) of the Southwest corner of Section 29, T 17 N, R 2 W, Fourth Principal Meridian, and I re-established said corner according to the Wisconsin Statutes as shown and described hereon.

Dated this 15th day of Dec. 1993.

Lawrence A. Feddersen

Registered Land Surveyor
Title

History of corner establishment since Original Government Survey

No record of re-established corner.

Description of corner evidence found:

This Southwest corner, was established at a 4-way fence corner. Harrison was placed in hole of old fence post.

COUNTY SURVEYOR FORM NO. 1

Description of corner and witness monuments, references and accessories used to perpetuate the original or re-established location of this corner:

Witnesses to corner location:

Lawrence A. Feddersen

Timothy J. Jeatran

John Rulseh

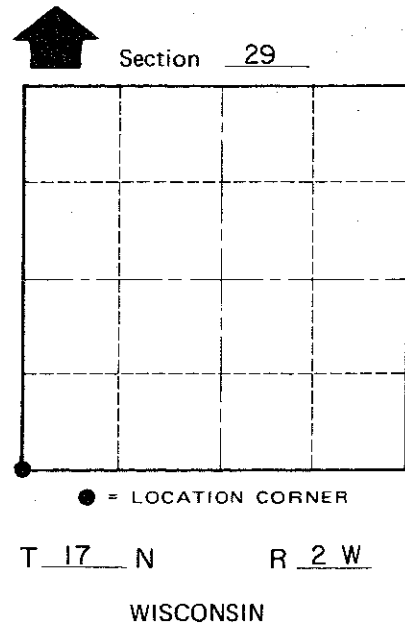
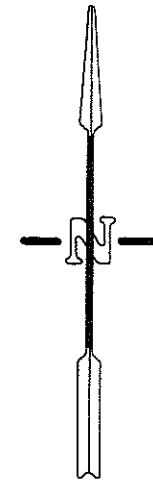
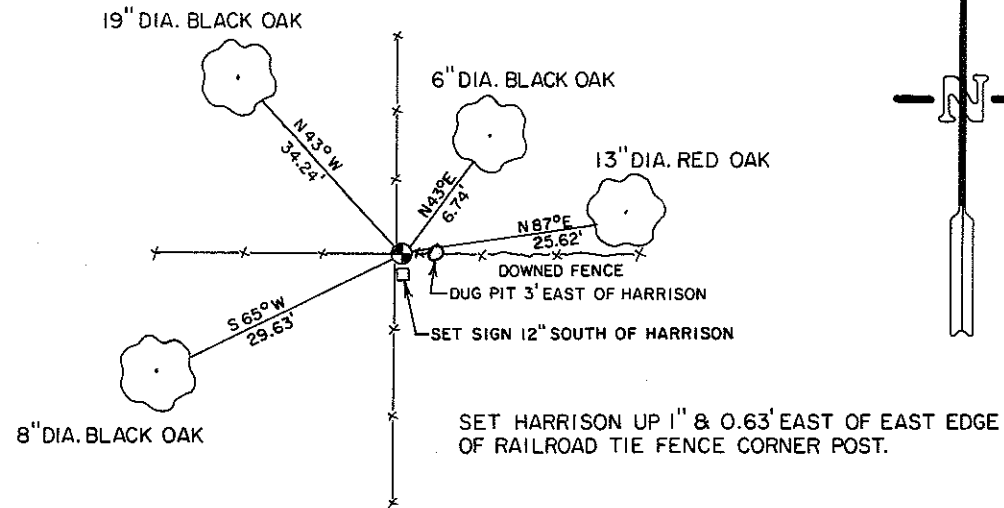

Note: All trees are double blazed with N&W in side base and tie distances are slope taped to nail in center of washer.

SURVEY CONTROL ORDER

Horizontal	_____
Vertical	_____

WISCONSIN COORDINATE SYSTEM

Corner	East (X)	North (Y)	Elevation (Z)	Zone
Control Sta. Name				

~~City, Village or Town of~~ Adrian

County of Monroe