

CERTIFICATE

CERTIFIED LAND CORNER

No. 105

**21702270000**

I, Harley A. Sime, do hereby certify that on the 21 day of October 1977, I found (evidence) (no evidence) of the Northeast corner of Section 34, T 17 N, R 2 W, Fourth Principal Meridian, and I re-established said corner according to the Wisconsin Statutes as shown and described hereon.

History of original corner establishment:  
No record of corner since Original Government survey

Dated this 3 day of Nov. 1977.

Description of corner evidence found:

Set corner by double proportionate measurement after traversing to the quarter corners North, South, East and West.

**Approved: HARLEY A. SIME**  
**MONROE CO. SURVEYOR**

County Surveyor  
Title

COUNTY SURVEYOR FORM NO. 1

Description of corner and witness monuments, references and accessories used to perpetuate the original or re-established location of this corner:

Set Harrison Monument, up 4".  
All trees blazed, with nail and cap.  
Witnesses to corner location:

- Pietz
- Lueck
- Dechant

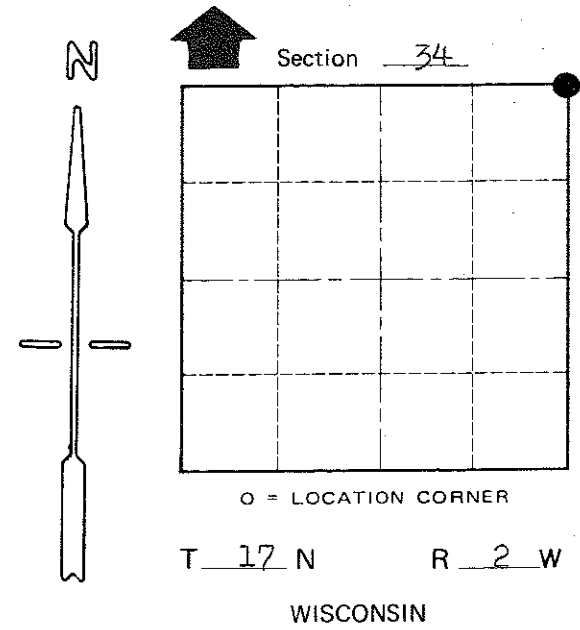
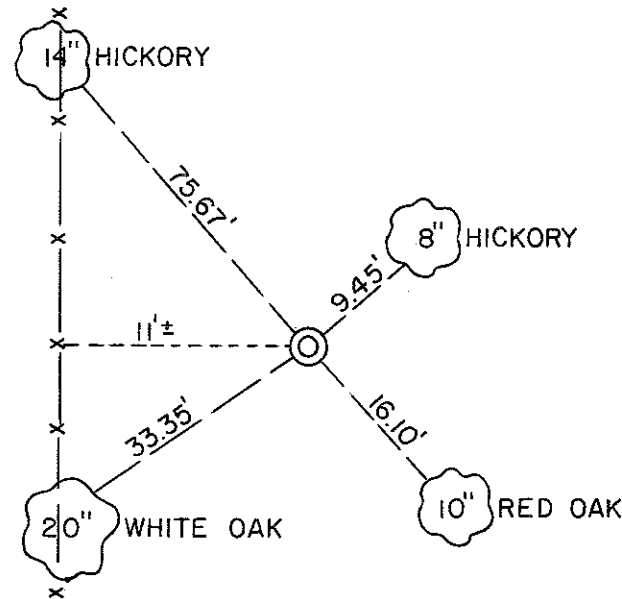

SURVEY CONTROL ORDER

Horizontal	_____
Vertical	_____

WISCONSIN COORDINATE SYSTEM

Corner	East (X)	North (Y)	Elevation (Z)	Zone
Control Sta. Name				

City, Village or Town Adrian

County of Monroe