

CERTIFICATE

CERTIFIED LAND CORNER

No. 104

21702260020

I, Harley A. Sime, do hereby certify that on the 16th day of April 1976, I found (evidence) (~~no evidence~~) of the South 1/4 corner of Section 26, T 17 N, R 2 W, Fourth Principal Meridian, and I re-established said corner according to the Wisconsin Statutes as shown and described hereon.

Dated this 5th day of April 1977.

History of original corner establishment:

A surveyor was at this corner in November of 1887.

Description of corner evidence found:

Set the corner by projecting a line through the North 1/4 and Center 1/4 corners of Section 26, and intersecting this line with the South line of the Southeast 1/4 of Section 26, the later line being identified by existing evidence.

County Surveyor Title

Approved: HARLEY A. SIME
MONROE CO. SURVEYOR

Description of corner and witness monuments, references and accessories used to perpetuate the original or re-established location of this corner:

Set a Harrison up 3" in centerline of old road bed, and packed stones around it. Set 3/8" rod and wood lathe Witnesses to corner location: by monument.

Jung
Malliet

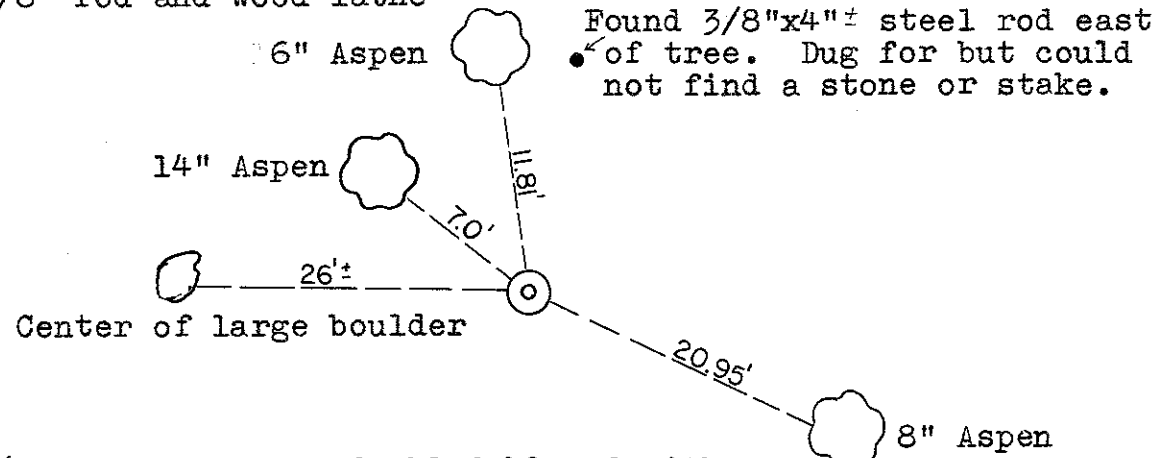
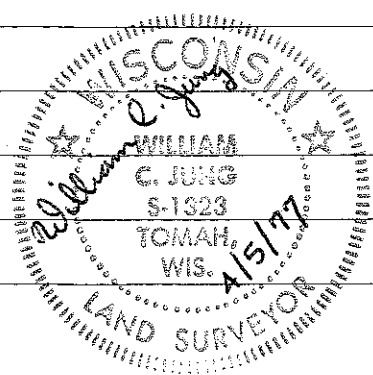

(Note: All trees doubled blazed with nail and caps set in trees.)

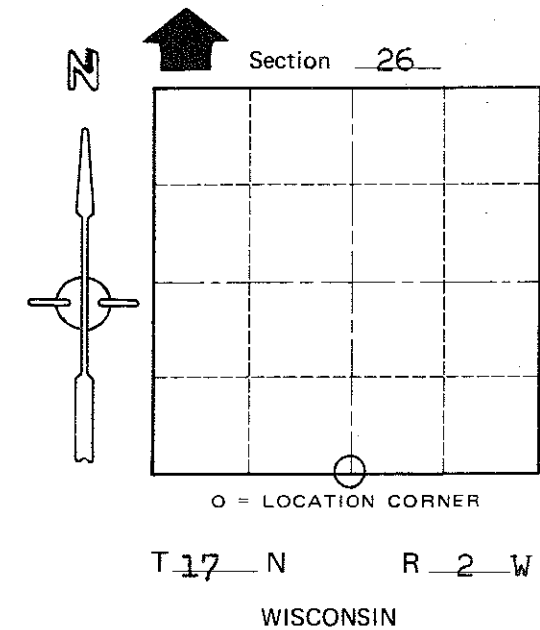

COUNTY SURVEYOR FORM NO. 1.

SURVEY CONTROL ORDER

Horizontal	_____
Vertical	_____

WISCONSIN COORDINATE SYSTEM

Corner	East (X)	North (Y)	Elevation (Z)	Zone
Control Sta. Name				

City, Village or Town Adrian

County of Monroe