

CERTIFICATE

CERTIFIED LAND CORNER

No. 79 G

**21702243030**

I, Harley A. Sime, do hereby certify that on the 21 day of November 19 75, I found ~~(evidence)~~ (no evidence) of the e1/16-NW1/4 corner of Section 24, T 17 N, R 2 W, Fourth Principal Meridian, and I re-established said corner according to the Wisconsin Statutes as shown and described hereon.

History of original corner establishment:

Description of corner evidence found:

Dated this 5<sup>th</sup> day of April 19 77.

Set "By Law" after running out Section 24.

County Surveyor \_\_\_\_\_  
Title

Approved: **HARLEY A. SIME**  
**MONROE CO. SURVEYOR**

Description of corner and witness monuments, references and accessories used to perpetuate the original or re-established location of this corner:

Set 3/4" iron bar.

Witnesses to corner location:

Jung  
Lueck  
Malliet

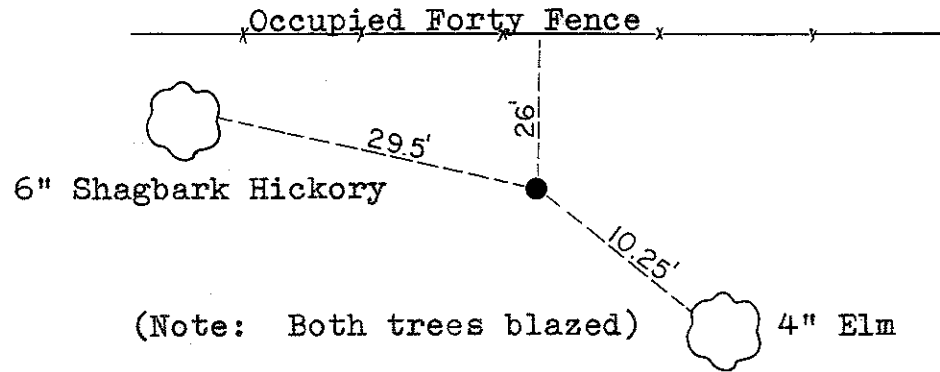
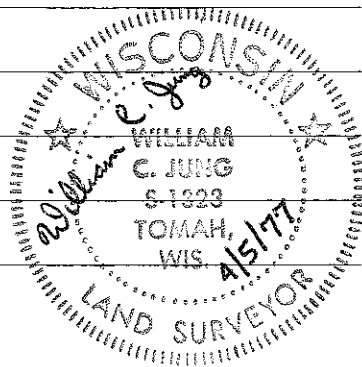

(Note: Both trees blazed)

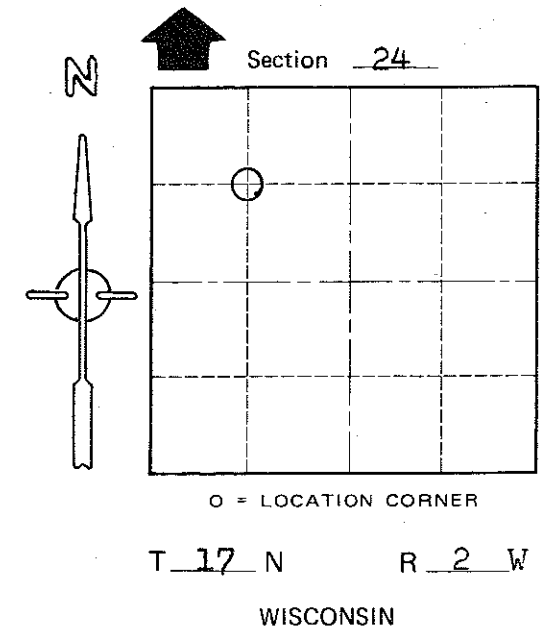

COUNTY SURVEYOR FORM NO. 1

SURVEY CONTROL ORDER

Horizontal	_____
Vertical	_____

WISCONSIN COORDINATE SYSTEM

Corner	East (X)	North (Y)	Elevation (Z)	Zone
Control Sta. Name				

City, Village or Town Adrian

County of Monroe