

# 84

**U.S. PUBLIC LAND CORNER  
MAINTENANCE**

**Corner ID : S1/4 Sec. 23 T17N-R2W**

**21702230020**

<u>DATE</u>	<u>CREW</u>	<u>MONUMENT TYPE -----</u>
August 17, 2016	Zachariah P.Dechant Gary L. Dechant	Existing Harrison intact. Leaning slightly NE. At four-way fence corner. Bearing trees gone

References:

	<u>Bearing</u>	<u>Distance</u>
1) Set 3/4"x24" round iron bar, down 12" in field	N60E	23.22'
2) Set 3/4"x24 round iron bar, down 12" in field	S24E	19.29'
3)Set 3/4"x24" round iron bar, down 12" in field	S30W	24.06'
4) Set 3/4"x24" round iron bar, down 12" in pasture	N42W	25.91

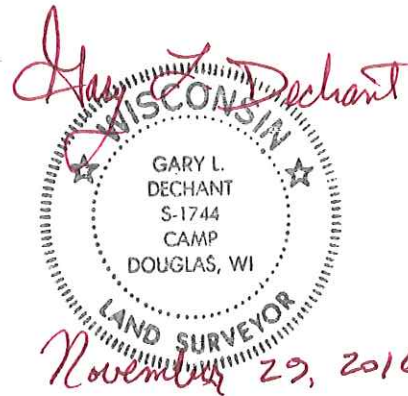

I, Harley A. Sime, do hereby certify that on the 16 day of April 19 76 I found (evidence) ~~(no evidence)~~ of the North 1/4 corner of Section 26, T 17 N, R 2 W, Fourth Principal Meridian, and I re-established said corner according to the Wisconsin Statutes as shown and described hereon.

Dated this 29th day of March 19 77.

History of original corner establishment:

A surveyor was at this corner in November of 1887.

Description of corner evidence found:

Accepted occupied four way fence as the best available evidence after surveying out Section 26.

County Surveyor Approved: HARLEY A. SIME  
 Title MONROE CO. SURVEYOR

**See Reverse Side  
For Maintenance**

Description of corner and witness monuments, references and accessories used to perpetuate the original or re-established location of this corner:

Set Harrison, up 1".

Witnesses to corner location:

Jung  
Malliet

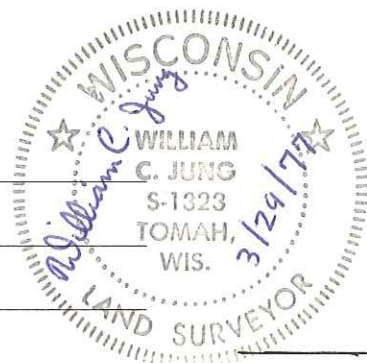

(Note: Both trees doubled blazed, with nail and cap set in each tree.)

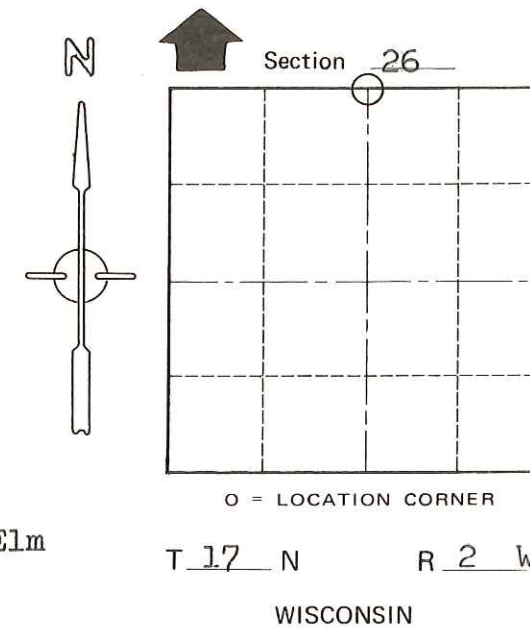
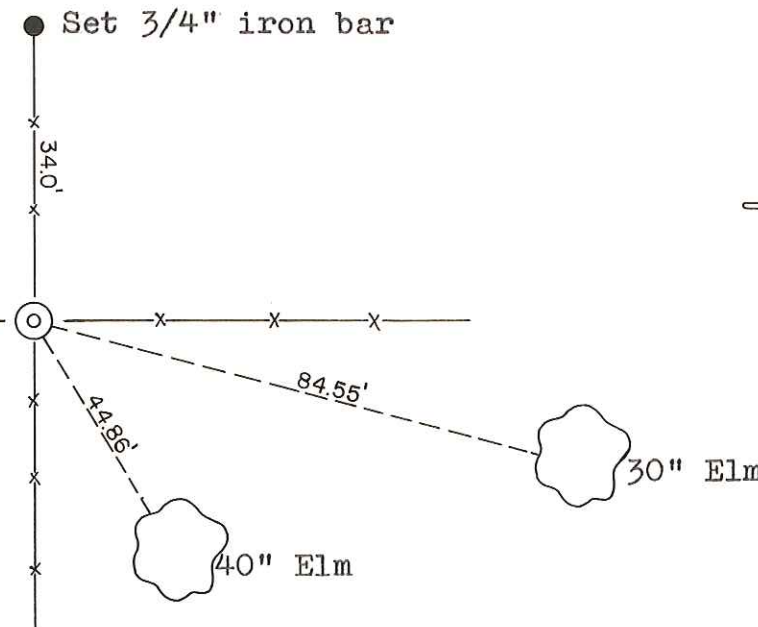

SURVEY CONTROL ORDER

Horizontal	_____
Vertical	_____

WISCONSIN COORDINATE SYSTEM

Corner	East (X)	North (Y)	Elevation (Z)	Zone
Control Sta. Name				

City, Village or Town Adrian

County of Monroe

COUNTY SURVEYOR FORM NO. 1