

**CERTIFICATE**

I, Nicholas M. Hillmer, do hereby certify that this document and the data contained herein was prepared by me or under my direct supervision and that I am a duly Licensed Land Surveyor under the laws of the State of Wisconsin.

Dated this 23rd day of May, 2013

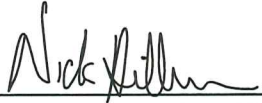

Nicholas M. Hillmer, P.L.S. 2909  
Anderson Engineering of Minnesota, LLC.

**CERTIFIED LAND CORNER**

**History of corner established since Original Government Survey**

In 1993 Lawrence A. Feddersen set a Harrison monument at the corner by using a downed fence as the east line of Section 29 and projecting the north line of the Northeast Quarter of Section 30 to the east to intersect with the downed fence.

**Description of evidence found**

On October 30th, 2012, Anderson Engineering of Minnesota located the Harrison monument flush with the ground and 1.0 foot south of a witness post with survey marker sign.

No. 21702200000



Description of corner and witness monuments, references and accessories used to perpetuate the original or re-established location of this corner:

Witnesses to corner location:

Nick Hillmer  
Josh Oslund  
Dan Greenwald



MONROE COUNTY  
COORDINATE SYSTEM  
NAD 1983 (2007)

HARRISON MONUMENT  
Northing (Y) 373707.41  
Easting (X) 673690.09

Base Station - 22 182W  
Northing (Y) 408053.25  
Easting (X) 679287.00

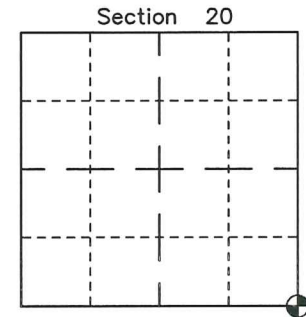
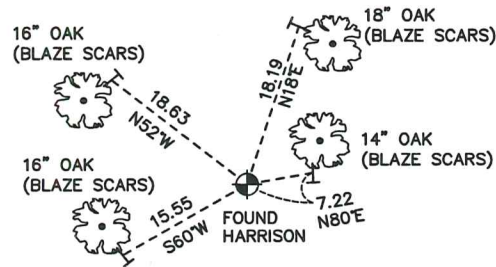

⊙ = LOCATION CORNER  
Corner I.D. SE 20  
T 17 N R 2 W  
Town of Adrian  
Monroe County, WI.

All distances are shown in U.S. Survey Feet.  
Ties are to 60D nails set in trees.  
Bearings are for tie reference purposes only.  
Coordinates were derived from RTK GNSS procedures.

2170220000

I, Lawrence A. Feddersen, do hereby certify that on the eighteenth day of November 1993, I found (evidence) (no evidence) of the Northeast corner of Section 29, T 17 N, R 2 W Fourth Principal Meridian, and I re-established said corner according to the Wisconsin Statutes as shown and described hereon.

Dated this 15th day of Dec. 1993.

Lawrence A. Feddersen

Registered Land Surveyor  
Title

History of corner establishment since Original Government Survey

No record of re-established corner.

Description of corner evidence found:

Used downed fence location as the East line of Section 29. Projected the North line of the NE 1/4 of Section 30 to the East to intersect with downed fence. Bearing checked closely with difference in vars between South & North line of original survey. Fence corners within section were no help, as they didn't check between themselves. All lands surrounding this corner are owned by the U.S. Government.

Description of corner and witness monuments, references and accessories used to perpetuate the original or re-established location of this corner:

Witnesses to corner location:

Lawrence A. Feddersen

Timothy J. Jeatran

John Rulseh

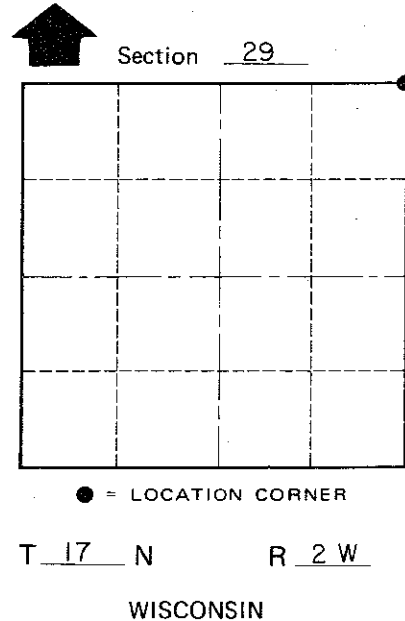
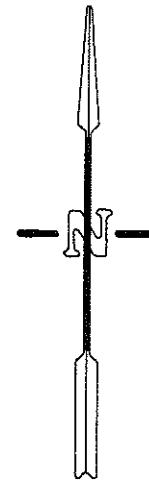
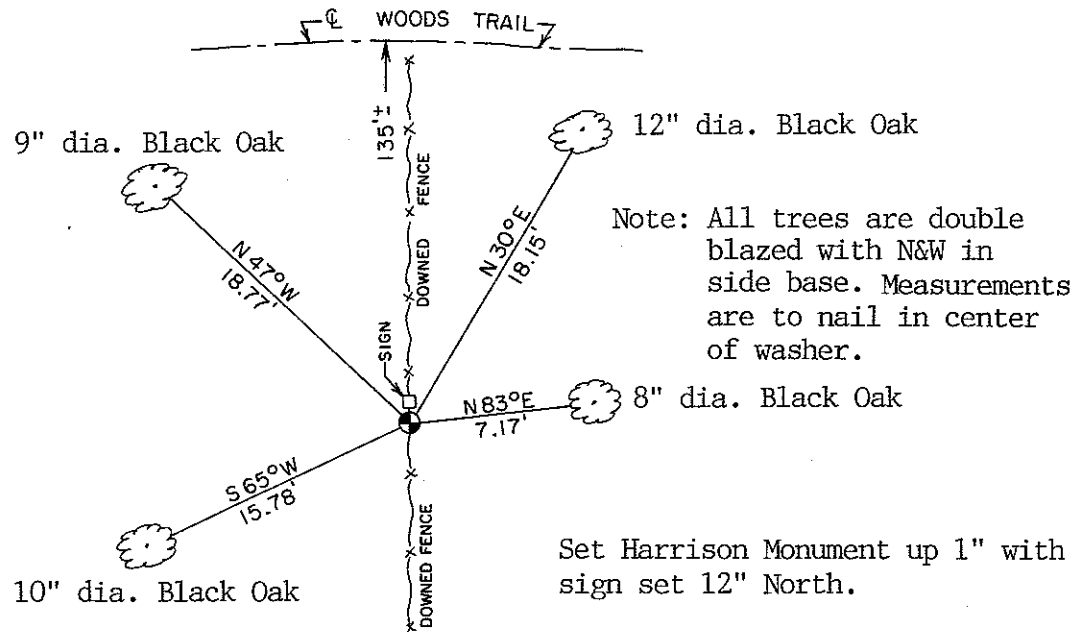

COUNTY SURVEYOR FORM NO. 1

SURVEY CONTROL ORDER

Horizontal	_____
Vertical	_____

WISCONSIN COORDINATE SYSTEM

Corner	East (X)	North (Y)	Elevation (Z)	Zone
Control Sta. Name				

City, Village or Town of Adrian

County of Monroe