

61

**U.S. PUBLIC LAND CORNER
MAINTENANCE**

Corner ID : NE Sec.24, T17N-R2W

21702130000

<u>DATE</u>	<u>CREW</u>	<u>MONUMENT TYPE</u>
November 7, 2018	Zachariah P. Dechant Gary L. Dechant	Existing Harrison, top broke off, down 12", intersection of Hemlock Road and Heritage Avenue All old ties gone, except power pole 46.35' NW.

References:

	<u>Bearing</u>	<u>Distance</u>
1) Set 3/4" x24" round iron bar, down 6", 3' south of r/w fence	N65E	86.22'
2) Set 3/4"x24" round iron bar, down 12" in field, 33' east of huge steel power pole	S64E	86.32'
3) Set 3/4"x24" round iron bar, down 6", south edge of field entrance	S65W	37.48'
4) Set 3/4"x24" round iron bar, down 10" in field	N64W	42.56'

Corner and reference markers set on straight lines.

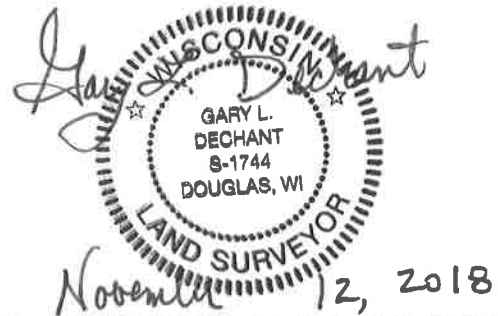

I, Harley A. Sime, do hereby certify that on the 19th day of November 1975, I found (evidence) (~~no evidence~~) of the Northeast corner of Section 24, T17 N, R 2 W, Fourth Principal Meridian, and I re-established said corner according to the Wisconsin Statutes as shown and described hereon.

Dated this 28th day of March 19 77.

Harley A. Sime

**Approved: HARLEY A. SIME
MONROE CO. SURVEYOR**

History of original corner establishment:
O.R. Dahl was at this corner in December of 1870. Ray Hurlburt set a 3/4" pipe inside of an existing pipe in September of 1940 and set an auto torque 2 rods West of the corner. Harley Sime found this pipe and used it in a November, 1965 survey. Fred Zietlow used this corner in a September, 1970 survey. Pritzlaff and Jung placed a bar over this pipe in June of 1974. Jung and Malliet used this bar in a July, 1974 survey, and also again in a November, 1975 survey.

Description of corner evidence found:

A 3/4" pipe was found by Pritzlaff and Jung in June of 1974, down under the road 3'. A 1/2" iron bar was placed above it. Found same in November, 1975. The 3/4" iron pipe was set by Hurlburt in September, 1940.

July 20, 1979

Crew: Meyer and Dade

Found the iron bar, removed it and set the top 18" of a Harrison marker over a 2" pinched pipe.

Description of corner and witness monuments, references and accessories used to perpetuate the original or re-established location of this corner:
Found 1/2" iron bar flush with the road.
It was set over Hurlburt's iron pipe.

Witnesses to corner location:

Jung

Malliet

Lueck



**See Reverse Side
For Maintenance**

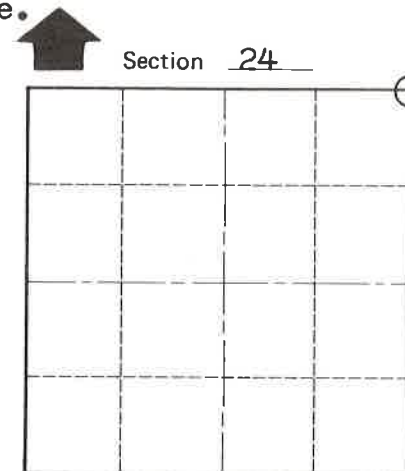
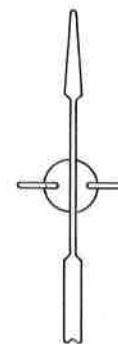
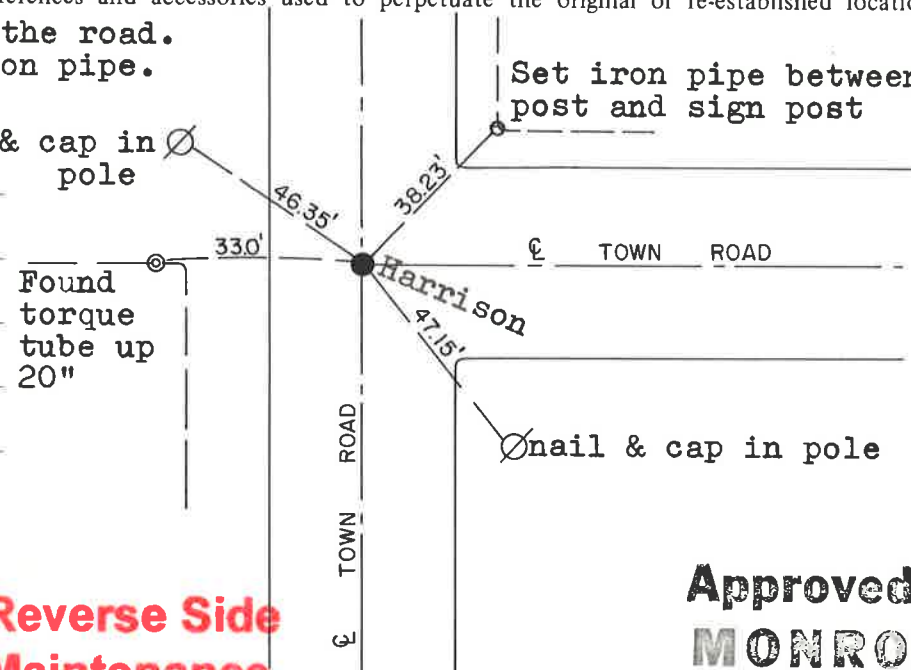

O = LOCATION CORNER

T 17 N R 2 W

WISCONSIN

**Approved: HARLEY A. SIME
MONROE CO. SURVEYOR**

SURVEY CONTROL ORDER

Horizontal	_____
Vertical	_____

WISCONSIN COORDINATE SYSTEM

Corner	East (X)	North (Y)	Elevation (Z)	Zone
Control Sta. Name				

City, Village or Town Adrian

County of Monroe

COUNTY SURVEYOR FORM NO. 1