

CERTIFICATE

I, Nicholas M. Hillmer, do hereby certify that this document and the data contained herein was prepared by me or under my direct supervision and that I am a duly Licensed Land Surveyor under the laws of the State of Wisconsin.

Dated this 21st day of May, 2013



Nicholas M. Hillmer, P.L.S. 2909
Anderson Engineering of Minnesota, LLC.

CERTIFIED LAND CORNER

History of corner established since Original Government Survey

The 1940's McCoy boundary notes show a corner at this location. In December of 1982 William Jung found a broken McCoy concrete marker and a wood witness post. Jung was able to determine the location of the old concrete marker and set a Harrison monument. Jung states this position fits the occupied conditions very well.

Description of evidence found

On October 29th, 2012, Anderson Engineering of Minnesota located the Harrison monument 0.2 feet above grade.

No. 21702090000



Description of corner and witness monuments, references and accessories used to perpetuate the original or re-established location of this corner:

Witnesses to corner location:

Nick Hillmer
Josh Oslund
Dan Greenwald

MONROE COUNTY
COORDINATE SYSTEM
NAD 1983 (2007)

HARRISON MONUMENT
Northing (Y) 384186.29
Easting (X) 678813.78

Base Station - 22 182W
Northing (Y) 408053.25
Easting (X) 679287.00

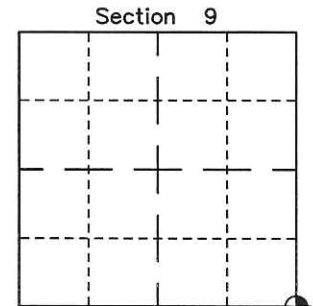
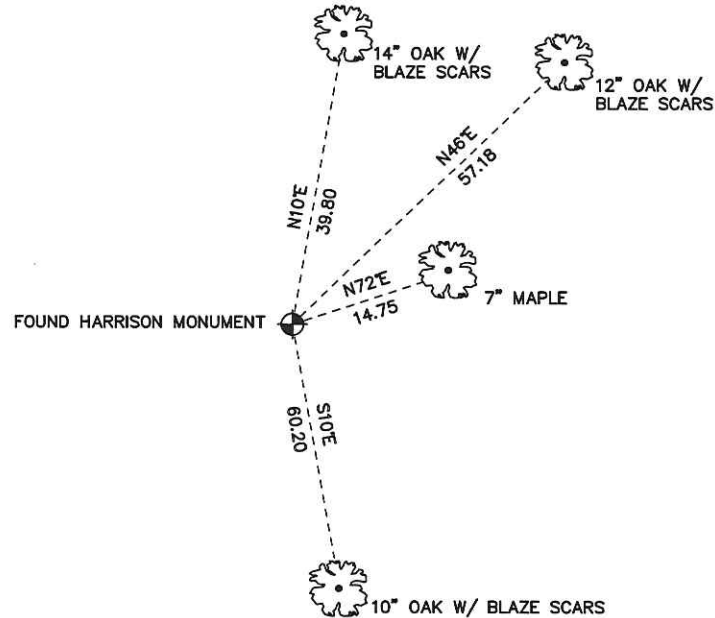

● = LOCATION CORNER
Corner I.D. SE 9
T 17 N R 2 W
Town of Adrian
Monroe County, WI.

All distances are shown in U.S. Survey Feet.
Ties are to 60D nails set in trees.
Bearings are for tie reference purposes only.
Coordinates were derived from RTK GNSS procedures.

21702090000

I, William C. Jung, do hereby certify that on the 28th day of December 1982, I found (evidence) ~~XXXXXXXXXX~~ of the Southwest corner of Section 10, T17 N, R 2 W Fourth Principal Meridian, and I re-established said corner according to the Wisconsin Statutes as shown and described hereon.

History of corner establishment since Original Government Survey

The Camp McCoy boundary survey notes show a monument at this corner.

Description of corner evidence found:

I found a broken McCoy concrete marker and its wood witness post, both broken and plowed over. I was able however to determine the location of the old concrete marker. I set a Harrison monument at this position. This fits the occupied conditions very good.

Dated this 27th day of Jan. 1983.

William C. Jung

Deputy County Surveyor
Title

Approved: **HARLEY A. SIME**
MONROE CO. SURVEYOR

COUNTY SURVEYOR FORM NO. 1

Description of corner and witness monuments, references and accessories used to perpetuate the original or re-established location of this corner:

Witnesses to corner location:

William Jung

Bryan Meyer

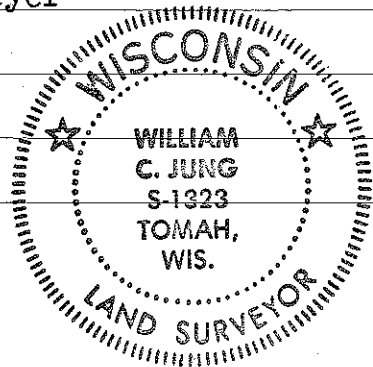

(center to center)

LANE
FIRE
LANE

All B.T.'s double blazed; each dist. is to a nail in a hack on the side of the tree.

(Set broken McCoy marker on N. side of 4" sq. guard FIRE post)

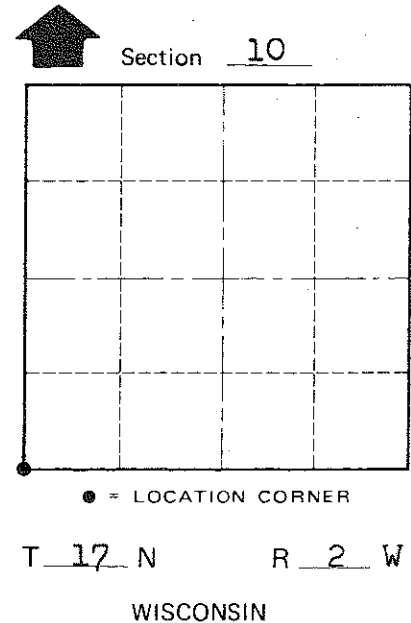
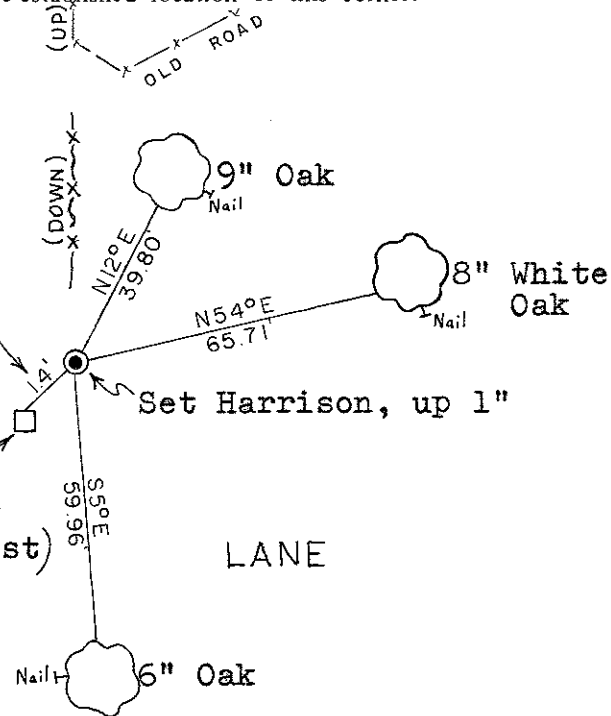

SURVEY CONTROL ORDER

| | |
|------------|-------|
| Horizontal | _____ |
| Vertical | _____ |

WISCONSIN COORDINATE SYSTEM

| Corner | East (X) | North (Y) | Elevation (Z) | Zone |
|-------------------|----------|-----------|---------------|------|
| Control Sta. Name | | | | |

~~Village of~~ Town of Adrian
County of Monroe