

CERTIFICATE

CERTIFIED LAND CORNER

No. 23

21702020000

I, Harley A. Sime, do hereby certify that on the 5th day of December 19 74, I found ~~(evidence)~~ (no evidence) of the NE corner of Section 11, T 17 N, R 2 W, Fourth Principal Meridian, and I re-established said corner according to the Wisconsin Statutes as shown and described hereon.
Dated this 28th day of March 19 77.

History of original corner establishment:

Description of corner evidence found:

Split distance from E¹/₄ of Section 2 and E¹/₄ corner of Section 11.

County Surveyor Approved: HARLEY A. SIME
Title MONROE CO. SURVEYOR

COUNTY SURVEYOR FORM NO. 1

Description of corner and witness monuments, references and accessories used to perpetuate the original or re-established location of this corner:

Set Harrison marker; 1' east of fence, 26' from fence intersection, and 50' from centerline of road.
Monument up 6"

Witnesses to corner location:

Jung
Pietz
Leach

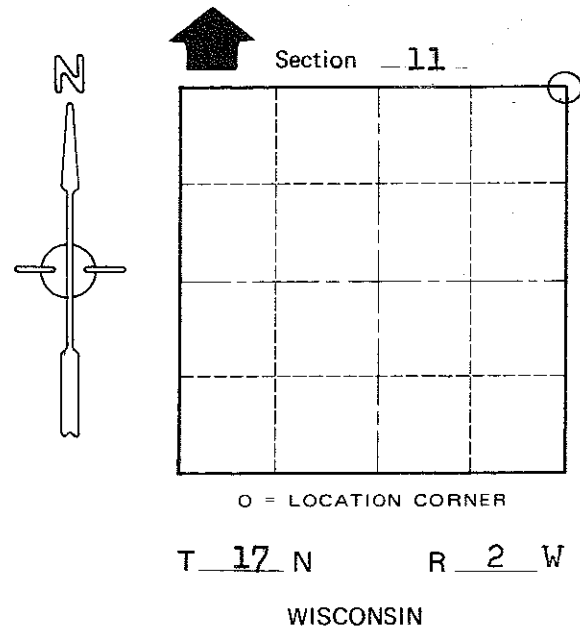
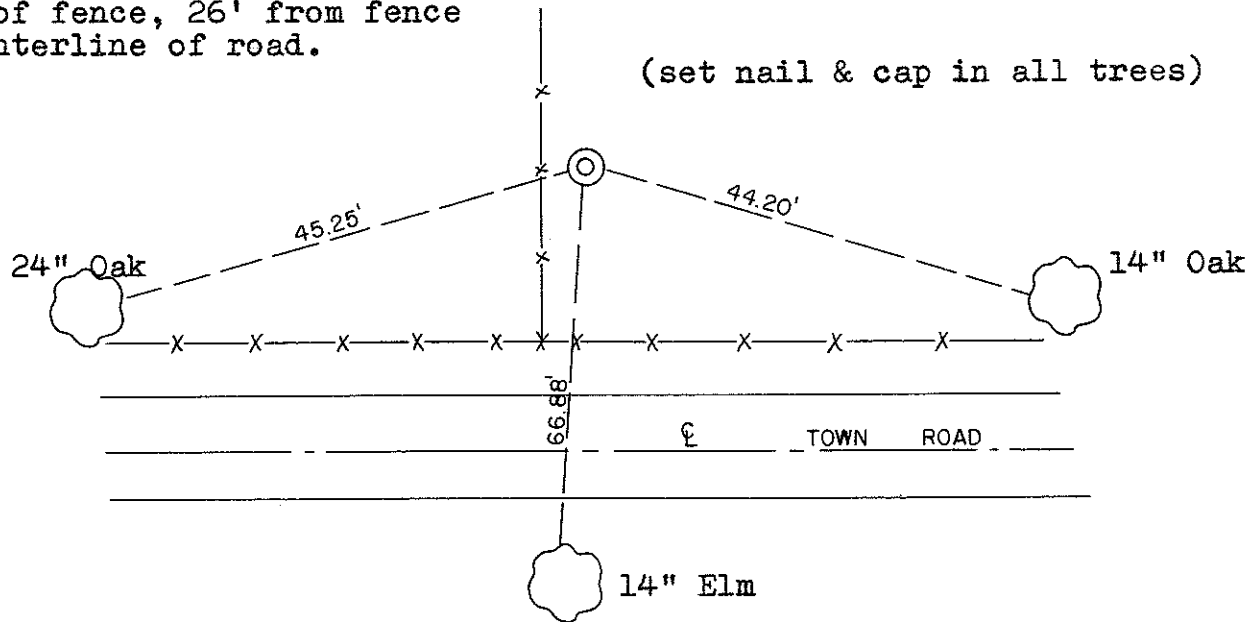
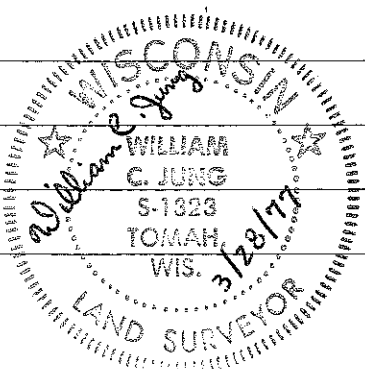

SURVEY CONTROL ORDER

Horizontal _____
Vertical _____

WISCONSIN COORDINATE SYSTEM

Corner	East (X)	North (Y)	Elevation (Z)	Zone
Control Sta. Name				

City, Village or Town Adrian

County of Monroe