

31

**U.S. PUBLIC LAND CORNER
MAINTENANCE**

**Corner ID : SW Sec.5, T17N-R1W
21701060000**

<u>DATE</u>	<u>CREW</u>	<u>MONUMENT TYPE</u>
October 31, 2018	Zachariah P. Dechant Gary L. Dechant	Existing Harrison intact, center of Gondola Road, down 3", 45' north of driveway 13991.

<u>References:</u>	<u>Bearing</u>	<u>Distance</u>
1) Existing 3/4" round iron bar, down 6", 2' north of power pole	N53E	50.09'
2) Set 3/4"x24" round iron bar, down 12" in field	S75E	50.57'
3) Set 3/4"x24" round iron bar, flush in lawn, 12' north of driveway	S53W	56.20'
4) Set 3/4"x24" round iron bar, down 8" in center of field entrance	N75W	47.36'

Harrison & reference markers set on straight lines.

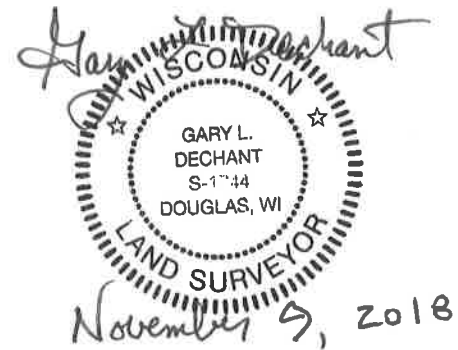

I, William C. Jung, do hereby certify that on the 11th day of July 1978, I found (evidence) (~~no evidence~~) of the SW Section corner of Section 5, T 17 N, R 1 W Fourth Principal Meridian, and I re-established said corner according to the Wisconsin Statutes as shown and described hereon.

Dated this 16th day of Aug. 1978.

William C. Jung, R.L.S. 1323

County Surveyor's Office

Title

History of original corner establishment:

Surveyor was here in Sept. of 1887.

Description of corner evidence found:

Found a 3/4" iron bar used in previous survey work. Replaced the iron bar with a Harrison marker.

See Reverse Side For Maintenance

Description of corner and witness monuments, references and accessories used to perpetuate the original or re-established location of this corner:

Witnesses to corner location:

G. Dechant

D. Dade

B. Meyer

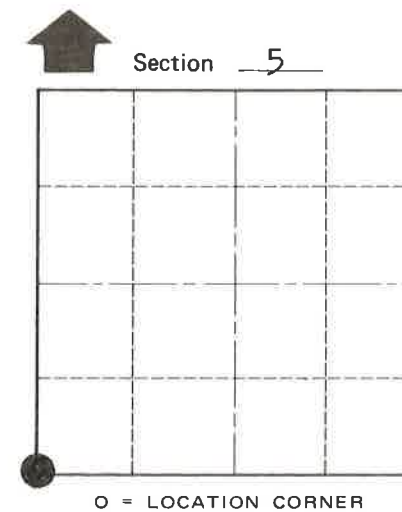
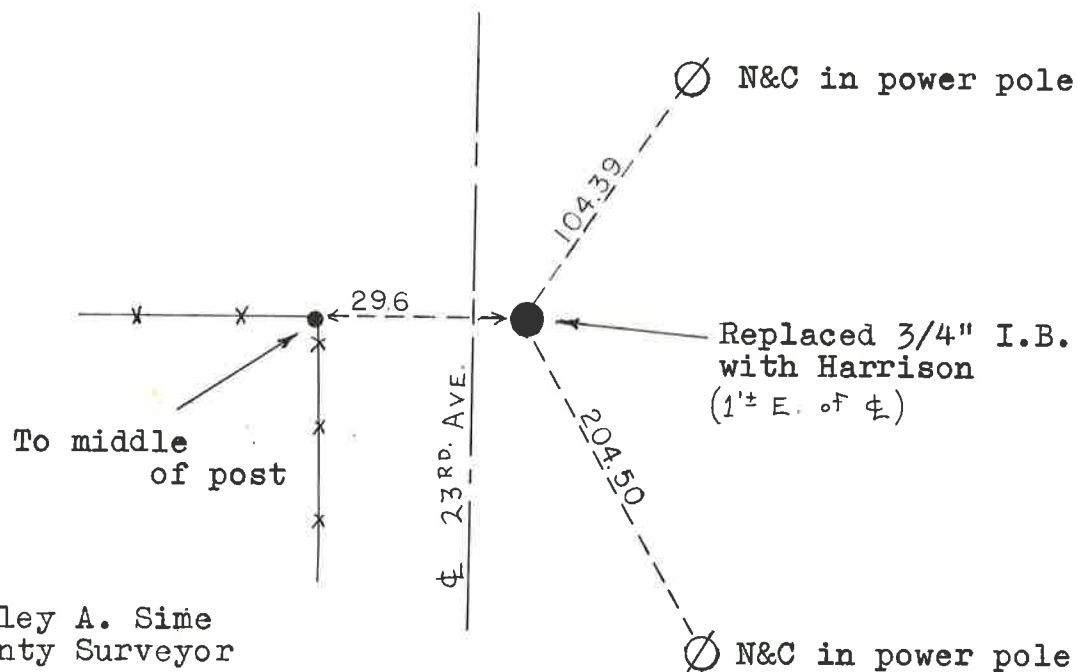

Section 5
O = LOCATION CORNER
T 17 N R 1 W
WISCONSIN

SURVEY CONTROL ORDER

Horizontal	_____
Vertical	_____

Approved by: Harley A. Sime
County Surveyor

WISCONSIN COORDINATE SYSTEM

Corner	East (X)	North (Y)	Elevation (Z)	Zone
Control Sta. Name				

City, Village or Town Tomah
County of Monroe

COUNTY SURVEYOR FORM NO. 1