

CERTIFICATE

CERTIFIED LAND CORNER

No. 17 L

**21701031020**

I, William C. Jung, do hereby certify that on the 9th day of November 1977, I found ~~(evidence)~~(NO EVIDENCE) of the NE Cor. - SE-SW corner of Section 3, T17 N, R 1 W, Fourth Principal Meridian, and I re-established said corner according to the Wisconsin Statutes as shown and described hereon.

History of original corner establishment:

No recorded history.

Description of corner evidence found:

Set the corner as set forth in the Wisconsin State Statutes, Chapter 59.62.

Dated this 9th day of Jan. 1978.

William C. Jung, R.L.S. 1323

Crew Chief, County Surveyor's  
Title Office

Description of corner and witness monuments, references and accessories used to perpetuate the original or re-established location of this corner:

Set a 3/4" iron bar in the woods.

(All trees blazed with N&C)

Witnesses to corner location:

W. Jung

G. Dechant

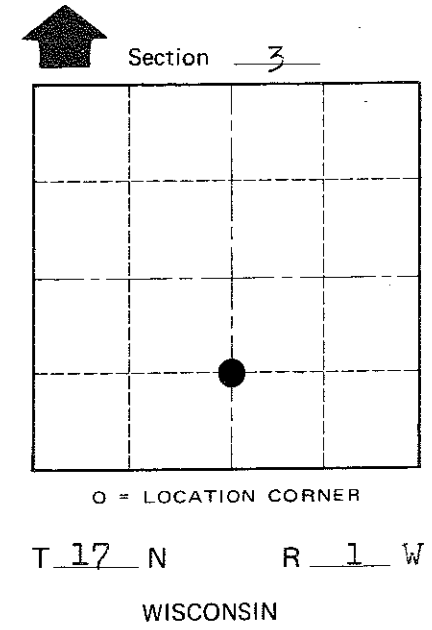
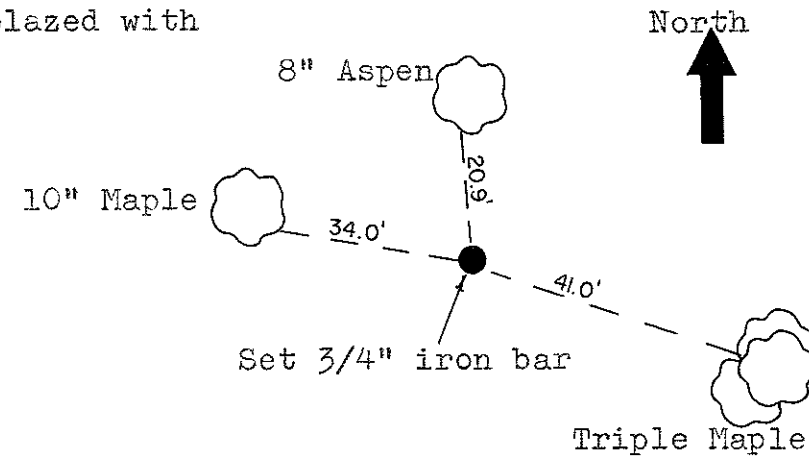
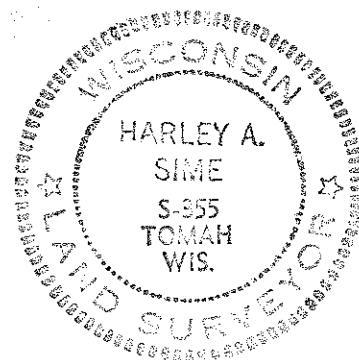
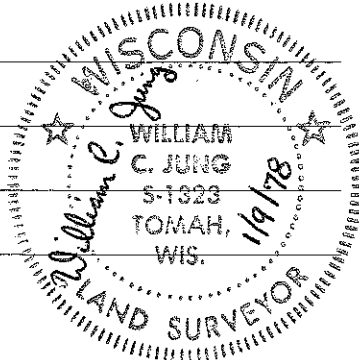

COUNTY SURVEYOR FORM NO. 1

SURVEY CONTROL ORDER

Horizontal \_\_\_\_\_  
Vertical \_\_\_\_\_

Approved: Harley A. Sime  
County Surveyor

WISCONSIN COORDINATE SYSTEM

Corner	East (X)	North (Y)	Elevation (Z)	Zone
Control Sta. Name				

City, Village or Town Tomah  
County of Monroe