

26

**U.S. PUBLIC LAND CORNER
MAINTENANCE**

Corner ID : S1/4 Sec. 3, T17N-R1W

21701030020

<u>DATE</u>	<u>CREW</u>	<u>MONUMENT TYPE</u> -----
July 16, 2018	Zachariah P. Dechant Gary L. Dechant	Existing 3/4" round iron bar at south edge concrete west bound Hwy. "12" & "16". Verified from existing ties. House 95.4' NE Ex. 1" pinched iron pipe north 88', iron pipe 112.1' west of power pole.

References:

	<u>Bearing</u>	<u>Distance</u>
1) Set 3/4"x24" round iron bar, flush, 12' east of SE corner of shed 1140 28' west of house 1210	N2W	101.65'
2) Set 3/4"x24" round iron bar, flush, 2' north of middle of storage shed 326-327	S23E	163.14'
3) Set 3/4"x24" round iron bar, flush, 2' west of NW corner storage shed 301	S2E	146.39'
4) Set 3/4"x24" round iron bar, flush, 11' south SW corner shed 1140	N23W	102.06'

Corner and reference markers set on straight lines.

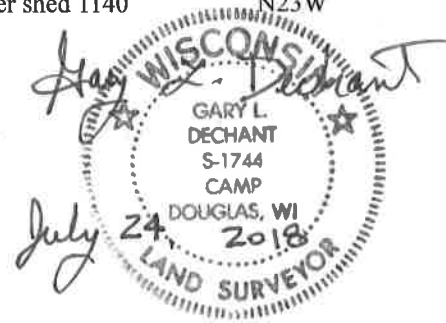

I, Harley A. Sime, do hereby certify that on the 27 day of June 19 77, I found (evidence) ~~(no evidence)~~ of the S4 corner of Section 3, T17 N, R1W, Fourth Principal Meridian, and I re-established said corner according to the Wisconsin Statutes as shown and described hereon.

Dated this 27 day of June 1977.

History of original corner establishment:

No recorded history in the County Surveyor Records.

Description of corner evidence found:

Set the corner at a location used in previous surveys.

See Reverse Side For Maintenance

County Surveyor

Approved: **HARLEY A. SIME**
MONROE CO. SURVEYOR

Description of corner and witness monuments, references and accessories used to perpetuate the original or re-established location of this corner:

Set a Harrison marker.

Witnesses to corner location:

G. Dechant

A. Lueck

R/W Post 5.5' Ex. I.P. SW. Cor. of house

Ex. 3/4" Hexagon Bar

SIGN PLACED 12/19/86 B.Z. Meyer, Kenworthy

Set Harrison 12" down

Ex. I.P. Power pole

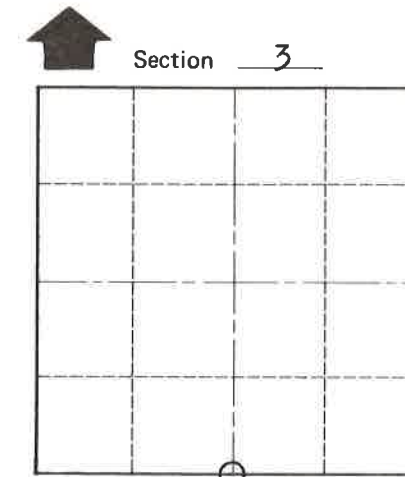
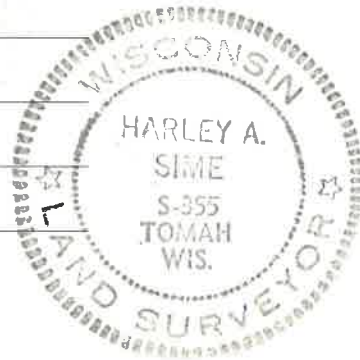

O = LOCATION CORNER

T 17 N R 1W

WISCONSIN

SURVEY CONTROL ORDER

Horizontal	_____
Vertical	_____

WISCONSIN COORDINATE SYSTEM

Corner	East (X)	North (Y)	Elevation (Z)	Zone
Control Sta. Name				

City, Village or Town Tomah

County of Monroe

COUNTY SURVEYOR FORM NO. 1