

24

**U.S. PUBLIC LAND CORNER
MAINTENANCE**

Corner ID : S1/4, Sec. 2, T17N-R1W

21701020020

| <u>DATE</u> | <u>CREW</u> | <u>MONUMENT TYPE</u> |
|----------------|---|---|
| April 20, 2017 | Zachariah P. Dechant Gary L. Dechant | Existing 1/4" round iron bar, down 12". Between lanes of USH "12". Set bolt 1' west and 1' south. Approx. 100' west of Grant Street |

References:

| | <u>Bearing</u> | <u>Distance</u> |
|---|----------------|-----------------|
| 1) Set 3/4"x24" round iron bar, down 6", 2' north of hwy fence | North | 89.78' |
| 2) Set 3/4"x24" round iron bar, down 6", on south highway bank | S32E | 47.89' |
| 3) Set 3/4"x24" round iron bar, down 6", between guy wire anchors | South | 98.98' |
| 4) Set 3/4"x 6' round iron bar, down 6", 2' north of hwy fence on line ± with 14" Ash in lawn further to the NW | N32W | 117.56' |
| 5) Existing culvert with dent (1979 reference marker) | northeast | 114.7' |

Reference markers 1-4 and 1/4" round iron bar set on straight lines

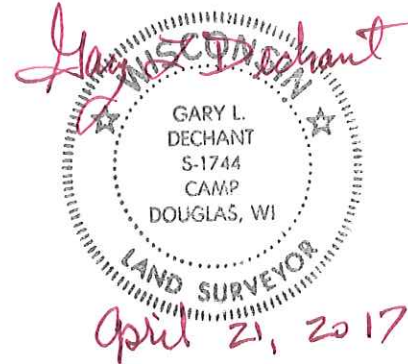

I, William C. Jung, do hereby certify that on the 3rd day of July 1978, I found ~~(evidence)~~ (no evidence) of the S1/4 corner of Section 2, T 17 N, R 1 W Fourth Principal Meridian, and I re-established said corner according to the Wisconsin Statutes as shown and described hereon.

Dated this 11th day of Jan. 1979.

William C. Jung, R.L.S. 1323

Crew Chief, County Surveyor's
Title Office

History of original corner establishment:

No known recorded history since the original government survey.

See Reverse Side For Maintenance

Description of corner evidence found:

The corner was set on line with the SW corner and S1/16SW, and at a distance from the S1/16SW equal to the distance between the SW and S1/16SW.

Description of corner and witness monuments, references and accessories used to perpetuate the original or re-established location of this corner:

Witnesses to corner location:

W. Jung

G. Dechant

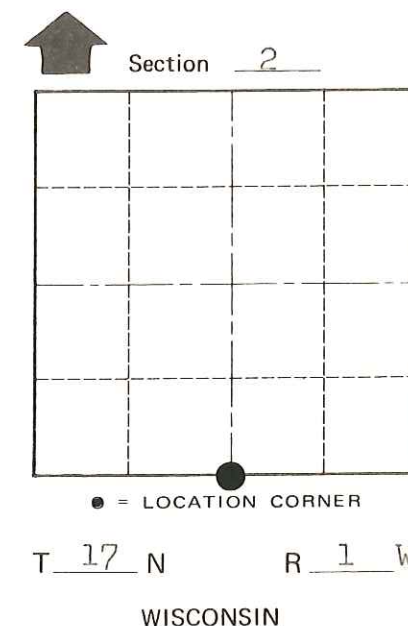
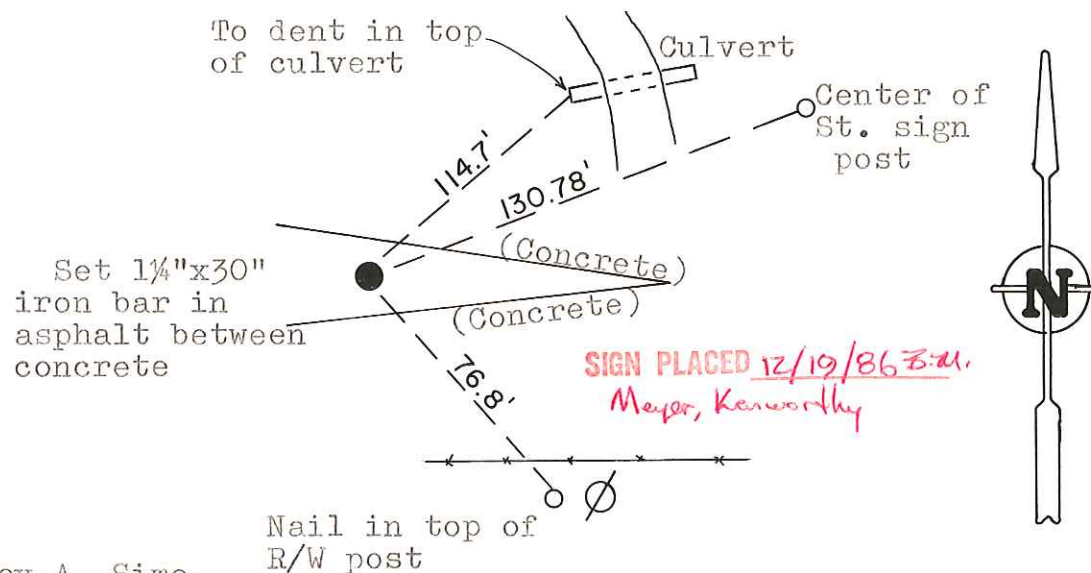
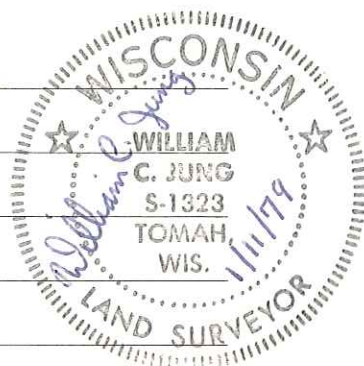

SURVEY CONTROL ORDER

Approved by: Harley A. Sime
County Surveyor

| | |
|------------|-------|
| Horizontal | _____ |
| Vertical | _____ |

WISCONSIN COORDINATE SYSTEM

| Corner | East (X) | North (Y) | Elevation (Z) | Zone |
|-------------------|----------|-----------|---------------|------|
| Control Sta. Name | | | | |

City, Village or Town Tomah

County of Monroe

COUNTY SURVEYOR FORM NO. 1