

22

**U.S. PUBLIC LAND CORNER
MAINTENANCE**

Corner ID : N1/4 Sec. 12, T17N-R1W

21701010020

<u>DATE</u>	<u>CREW</u>	<u>MONUMENT TYPE</u> -----
July 20, 2018	Zachariah P. Dechant Gary L. Dechant	Existing Harrison intact in shallow ditch. Set survey sign 1.5' north. 117' south of center Hwy. "12" & "16".

<u>References:</u>	<u>Bearing</u>	<u>Distance</u>
1) Set 3/4"x24" round iron bar, down 8" on south side of old road bed	N20E	19.58'
2) Set 3/4"x24" round iron bar, down 6"	S14E	16.25'
3) Set 3/4"x24" round iron bar, down 6", 3' NE of 12" White Oak	S19W	12.82'
4) Set 3/4"x24" round iron bar, down 8" on south side of old road bed	N52W	20.60'



I, Harley A. Sime, do hereby certify that on the 5th day of July 19 79, I found (evidence) (no evidence) of the North 1/4 corner of Section 12, T 17 N, R 1 W Fourth Principal Meridian, and I re-established said corner according to the Wisconsin Statutes as shown and described hereon.

Dated this 30th day of Dec. 19 80.

Approved: HARLEY A. SIME
MONROE CO. SURVEYOR

Title

History of corner establishment since Original Government Survey

No known history since the original government survey.

Description of corner evidence found:

Set this corner equidistant and on line between the NW corner and the NE corner of Section 12.

See Reverse Side For Maintenance

COUNTY SURVEYOR FORM NO. 1

Description of corner and witness monuments, references and accessories used to perpetuate the original or re-established location of this corner:

Witnesses to corner location:

Dechant

Webb

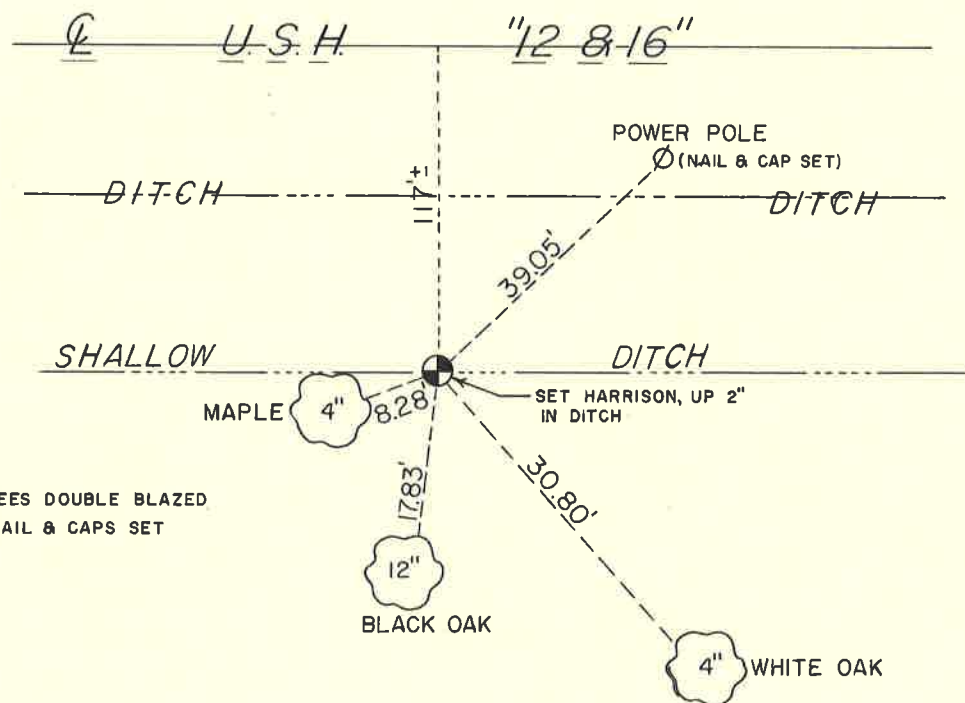

NOTE: ALL TREES DOUBLE BLAZED WITH NAIL & CAPS SET

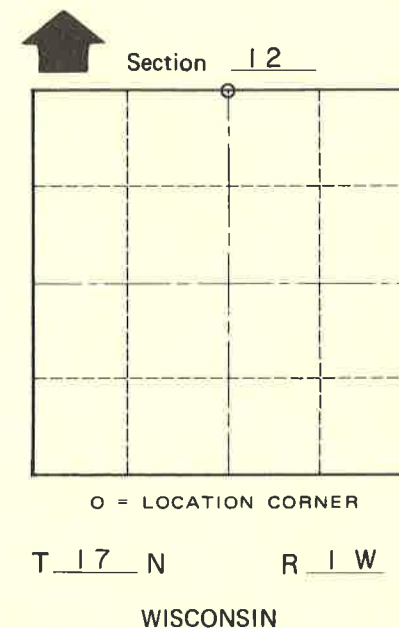

SURVEY CONTROL ORDER

Horizontal	_____
Vertical	_____

WISCONSIN COORDINATE SYSTEM

Corner	East (X)	North (Y)	Elevation (Z)	Zone
Control Sta. Name				

Town Tomah
 County of Monroe