

47

**U.S. PUBLIC LAND CORNER
MAINTENANCE**

Corner ID : SE Sec. 9, T17N-R1W

21701090000

<u>DATE</u>	<u>CREW</u>	<u>MONUMENT TYPE -----</u>
July 13, 2016	Zachariah P.Dechant Gary L. Dechant	Found Harrison top broke off, down 10" Set sign 1' South. 62' NE center of Hiawatha Ave. West of power line.

References:

	<u>Bearing</u>	<u>Distance</u>
1) Set 3/4"x24" round iron bar, down 12" in field	N82E	35.42'
2) Set 3/4"x24" round iron bar, down 12" in field	S58E	43.00'
3) Set 3/4"x24" round iron bar, down 6", 27' NE of Town Road along curve	S13W	40.31'
4) Set 3/4"x24" round iron bar, down 6", 30 from Town Road	S68W	37.33'

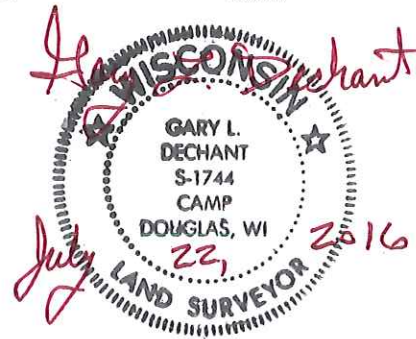

I, Harley A. Sime, do hereby certify that on the 21 day of October 1976, I found (evidence) (~~not found~~) of the NE corner of Section 16, T 17 N, R 1 W. Fourth Principal Meridian, and I re-established said corner according to the Wisconsin Statutes as shown and described hereon.

Dated this 16th day of March 1977.

History of original corner establishment:
None since original survey

**See Reverse Side
For Maintenance**

Description of corner evidence found:

Found Harrison Monument. Duane Marten replaced an existing 1/4" Iron Pipe with this Harrison on December 24, 1971. The Iron Pipe had been used in previous surveys.

County Surveyor Approved: HARLEY A. SIME
Title MONROE CO. SURVEYOR

Description of corner and witness monuments, references and accessories used to perpetuate the original or re-established location of this corner:

Found existing Harrison Monument.

Witnesses to corner location:

William C. Jung

Bruce Rassmussen

August Lueck

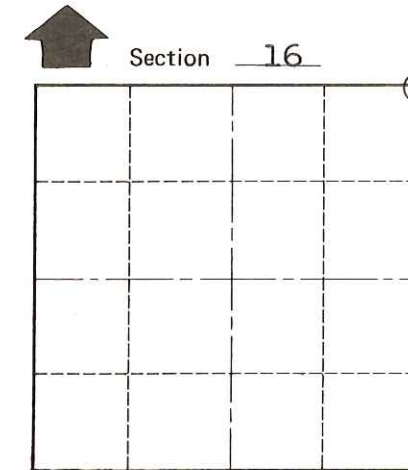
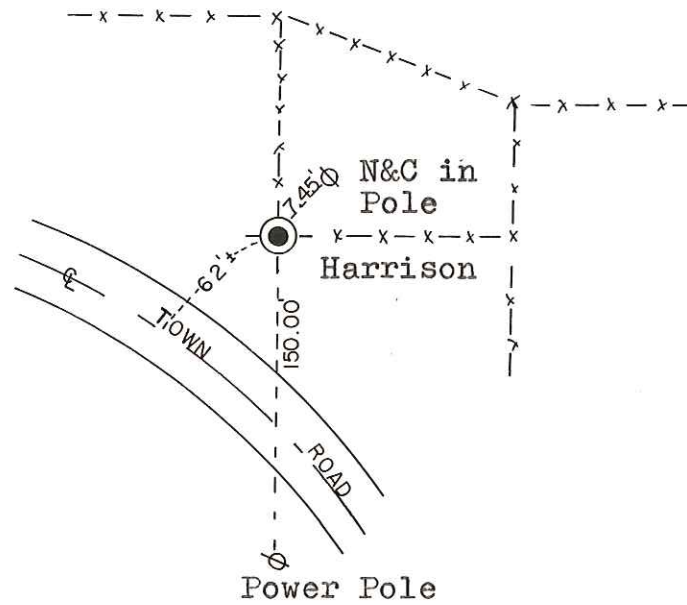
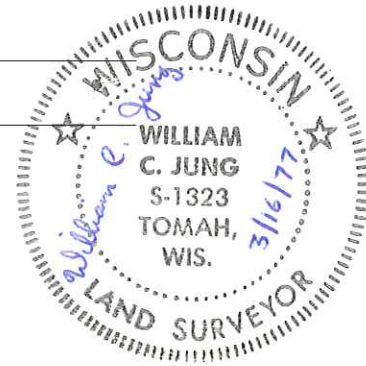

O = LOCATION CORNER
T 17 N R 1 W
WISCONSIN

SURVEY CONTROL ORDER

Horizontal	_____
Vertical	_____

WISCONSIN COORDINATE SYSTEM

Corner	East (X)	North (Y)	Elevation (Z)	Zone
Control Sta. Name				

~~City/Village~~ or Town Tomah

County of Monroe

COUNTY SURVEYOR FORM NO. 1