

35

**U.S. PUBLIC LAND CORNER
MAINTENANCE**

**Corner ID : E1/4 Sec.7, T17N-R1W
2.1701072000**

| <u>DATE</u> | <u>CREW</u> | <u>MONUMENT TYPE</u> |
|-------------------|--|--|
| November 30, 2018 | Zachariah P.Dechant Gary L. Dechant | Existing Harrison, top broke off, up 6", placed 3 stones around Harrison. Set sign 1' north. |

References:

| | <u>Bearing</u> | <u>Distance</u> |
|---|----------------|-----------------|
| 1) Set 3/4"x24" round iron bar, down 3", 4' SW of 5" Burr Oak | N13E | 56.56' |
| 2) Set 3/4"x24"round iron bar, down 3", 5' SW of 18" Scotch Pine | N44E | 59.84' |
| 3) Set 3/4"x24" round iron bar, down 3", 4' NW of 16" Black Oak (1984 BT) | S72E | 29.47' |
| 4) Set 3/4"x24" round iron bar, down 3", 4' SE of 8" White Oak | N48W | 25.69' |

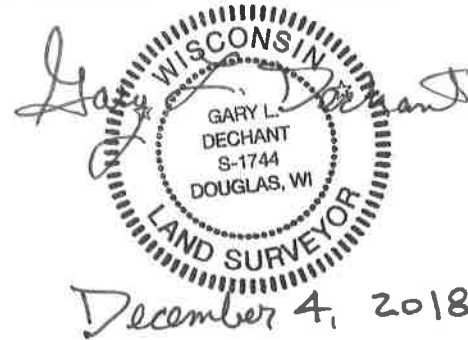

I, Gary L. Dechant, do hereby certify that on the 28th day of February 1984, I found (evidence) ~~(no evidence)~~ of the E¹/₄ corner of Section 7, T 17 N, R 1 W Fourth Principal Meridian, and I re-established said corner according to the Wisconsin Statutes as shown and described hereon.

Dated this 29th day of Feb. 1984.

Gary L. Dechant
 Registered Land Surveyor, S-1744
Title

History of corner establishment since Original Government Survey

No known recorded history since the original government survey.

Description of corner evidence found:

Accepted fence corner as the best available evidence as it fits within 2'± of being half way between the section corners. Also fits original government distance to the W¹/₄ corner within 4'±.

See Reverse Side For Maintenance

Description of corner and witness monuments, references and accessories used to perpetuate the original or re-established location of this corner:

Witnesses to corner location:

Lawrence A. Feddersen, S-1226

Gary L. Dechant

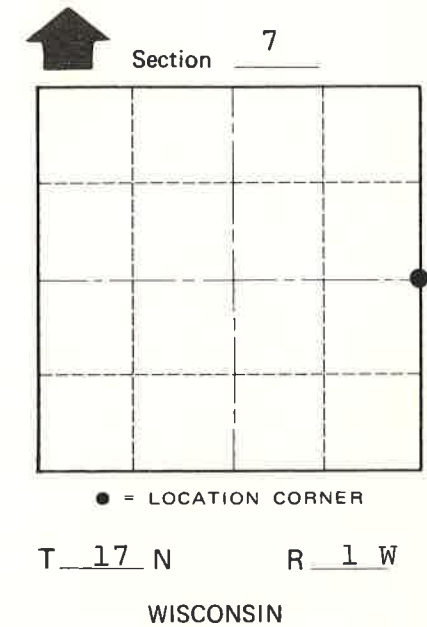
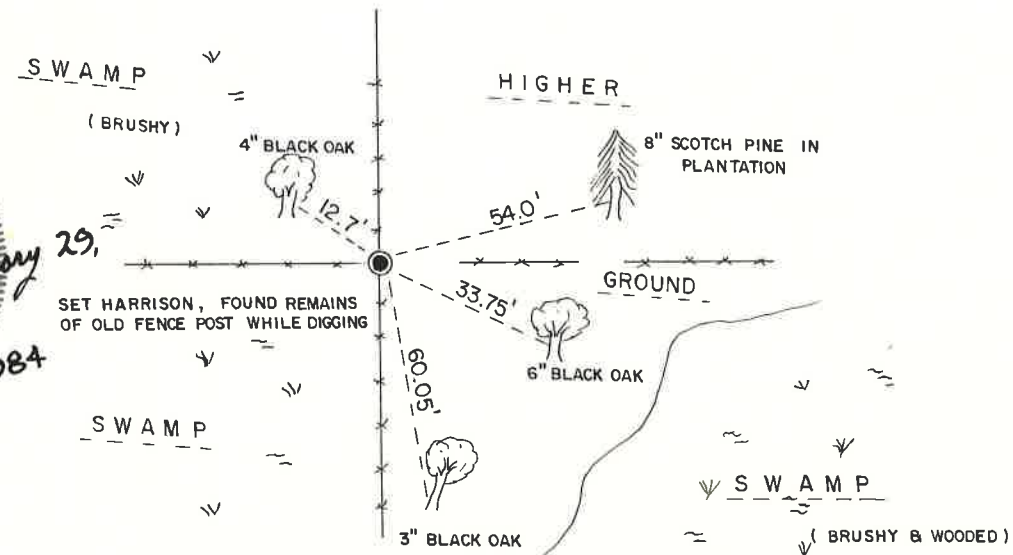

(Trees double blazed, scribed and with N&C's)

Approved: HARLEY A. SIME
MONROE CO. SURVEYOR

COUNTY SURVEYOR FORM NO. 1

SURVEY CONTROL ORDER

| | |
|------------|-------|
| Horizontal | _____ |
| Vertical | _____ |

WISCONSIN COORDINATE SYSTEM

| Corner | East (X) | North (Y) | Elevation (Z) | Zone |
|-------------------|----------|-----------|---------------|------|
| Control Sta. Name | | | | |

City, Village or Town Tomah
 County of Monroe