

# 65

**U.S. PUBLIC LAND CORNER  
MAINTENANCE**

**Corner ID : SE Sec. 15, T17N-R1W**

**21701150000**

<u>DATE</u>	<u>CREW</u>	<u>MONUMENT TYPE</u> -----
July 20, 2018	Zachariah P.Dechant Gary L. Dechant	Existing 1" iron pipe over Harrison 6' west of center line Hickory Road On line with fence to east.

References:

	<u>Bearing</u>	<u>Distance</u>
1) Set 3/4"x24" round iron bar, down 12" in field	N65E	56.51'
2) Set 3/4"x24" round iron bar, down 8" on road shoulder, 18' east of road	S73E	26.61'
3) Set 1/4"x24" round iron bar, down 6". 5' NE of oak stump (1974 BT)	S65W	47.90'
4) Set 1/4"x24" round iron bar, down 6", 4' SE of 16" Maple (1974 BT)	N73W	30.17'

Corner and reference markers set on straight lines.

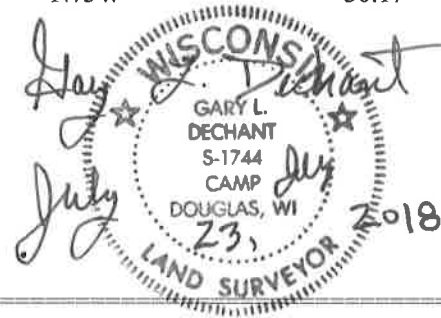

I, Harley A. Sime, do hereby certify that on the 17th day of September 1974, I found (evidence) ~~(no evidence)~~ of the SE corner of Section 15, T. 17 N, R. 1 W Fourth Principal Meridian, and I re-established said corner according to the Wisconsin Statutes as shown and described hereon.

History of original corner establishment:

**See Reverse Side For Maintenance**

Description of corner evidence found:

Dated this 6th day of Feb. 1978.

Intersected fence lines. Set Harrison Monument 6" below surface of gravel road. The corner falls in the centerline of the road.

County Surveyor \_\_\_\_\_  
Title

**Approved: HARLEY A. SIME  
MONROE CO. SURVEYOR**

Description of corner and witness monuments, references and accessories used to perpetuate the original or re-established location of this corner:

SET HARRISON.

Witnesses to corner location:

D. Marten

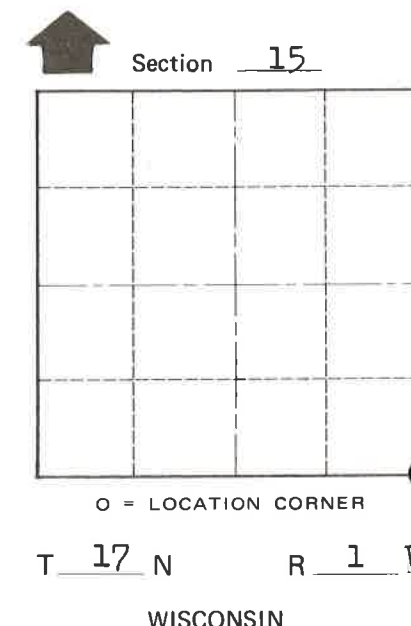
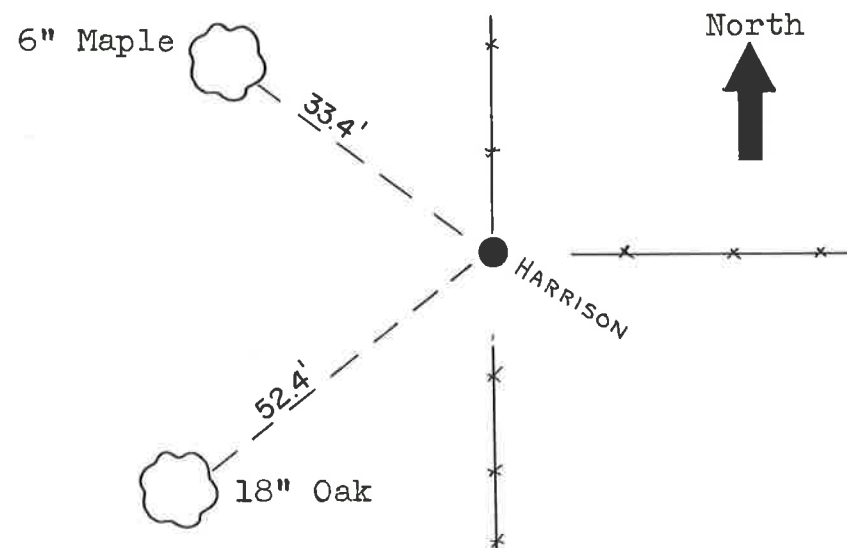

COUNTY SURVEYOR FORM NO. 1

SURVEY CONTROL ORDER

Horizontal	_____
Vertical	_____

WISCONSIN COORDINATE SYSTEM

Corner	East (X)	North (Y)	Elevation (Z)	Zone
Control Sta. Name				

City, Village or Town Tomah

County of Monroe