

# 62

**U.S. PUBLIC LAND CORNER  
MAINTENANCE**

**Corner ID : S1/4 Sec.13, T17N-R1W  
21701130020**

<u>DATE</u>	<u>CREW</u>	<u>MONUMENT TYPE</u>
November 12, 2018	Zachariah P. Dechant Gary L. Dechant	Harrison intact at fence corner. Set sign 1' north.

References:

	<u>Bearing</u>	<u>Distance</u>
1) Set 3/4" round iron bar, down 4",	N50E	24.30'
2) Set 3/4"x24" round iron bar, down 4"	S80E	16.81'
3) Set 3/4"x24" round iron bar, down 10"	S32W	13.45'
4) Set 3/4"x24" round iron bar, down 4", 4' SE of 16" Black Oak	N65W	17.80'

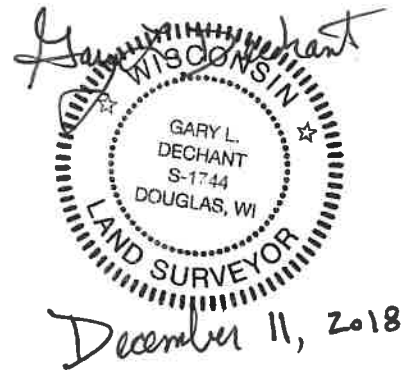

CERTIFICATE

I, Gary L. Dechant, do hereby certify that on the 3rd day of June 1986, I found (evidence) (re-established) of the S 1/4 corner of Section 13, T 17 N, R 1 W Fourth Principal Meridian, and I re-established said corner according to the Wisconsin Statutes as shown and described hereon.

Dated this 9th day of June 1986.

Gary L. Dechant Registered Land Surveyor, 1744 Title

CERTIFIED LAND CORNER

No. 62

History of corner establishment since Original Government Survey

Fred Holden was here in October of 1908.

Description of corner evidence found:

We found an unrecorded iron pipe and accepted it as the corner as it fit other section data extremely well.

See Reverse Side For Maintenance

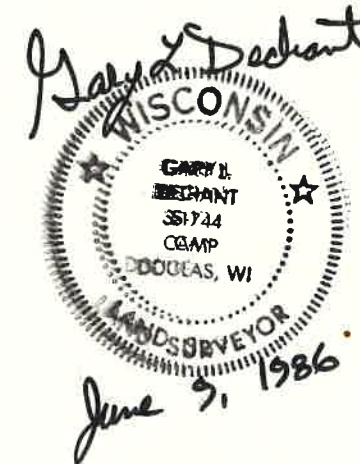

Description of corner and witness monuments, references and accessories used to perpetuate the original or re-established location of this corner:

Witnesses to corner location:

Gary L. Dechant

David Madison

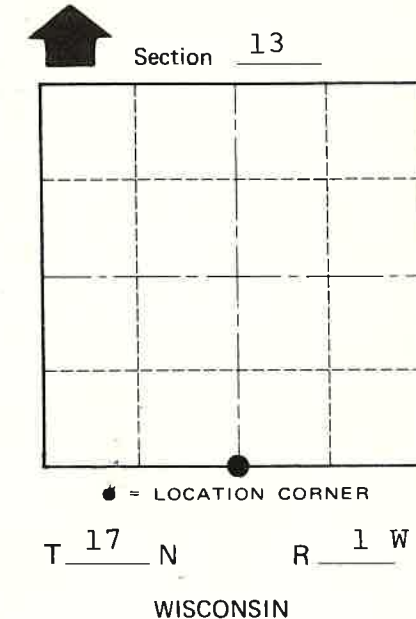
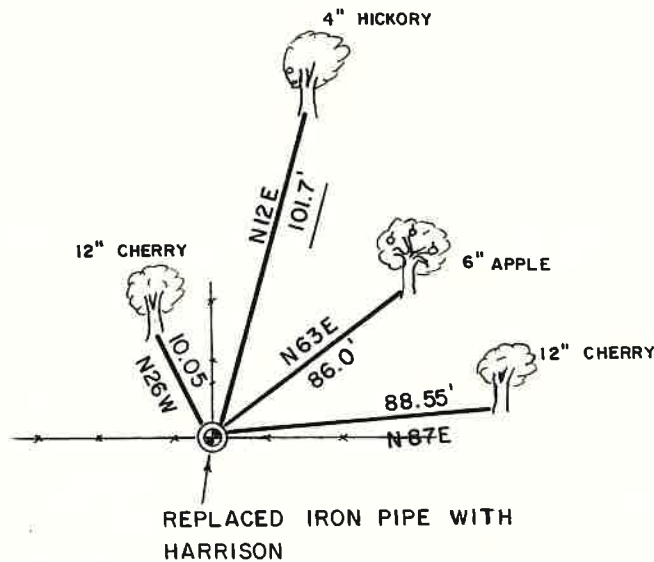

(Trees double blazed with N&C's set)

COUNTY SURVEYOR FORM NO. 1

SURVEY CONTROL ORDER

Horizontal

Vertical

WISCONSIN COORDINATE SYSTEM

Table with columns: Corner, Control Sta. Name, East (X), North (Y), Elevation (Z), Zone

City, Village or Town Tomah County of Monroe