

# 44

**U.S. PUBLIC LAND CORNER  
MAINTENANCE**

**Corner ID : S1/4 Sec. 11, T17N-R1W  
21701110020**

DATE	CREW	MONUMENT TYPE -----
June 9, 2017	Zachariah P.Dechant Gary L. Dechant	Existing Harrison intact, east of gate intact, down 12", 33' east of fence corner. Set sign 1' west

References:

	<u>Bearing</u>	<u>Distance</u>
1) Set 3/4"x24" round iron bar, down 10" in pasture	N32E	23.91'
2) Set 3/4"x24" round iron bar, down 10" in pasture	S50E	39.24'
3) Set 3/4"x24" round iron bar, down 10" in center of roadway	S41W	43.50'
4) Set 3/4"x24" round iron bar, down 10" in field	N47W	27.40'



I, Harley A. Sime, do hereby certify that on the 8 day of September 1972, I found (evidence) ~~(# of evidence)~~ of the N<sup>1</sup>/<sub>4</sub> corner of Section 14, T 17 N, R 1 W, Fourth Principal Meridian, and I re-established said corner according to the Wisconsin Statutes as shown and described hereon.

Dated this 6<sup>th</sup> day of Feb. 1978.

History of original corner establishment:

**See Reverse Side For Maintenance**

Description of corner evidence found:

Existing North - South fence and East - West fence, I projected East - West fence towards the east and intersected this line with the North - South fence.

County Surveyor  
Title

**Approved: HARLEY A. SIME  
MONROE CO. SURVEYOR**

Description of corner and witness monuments, references and accessories used to perpetuate the original or re-established location of this corner:

Set Harrison Monument at corner.

Witnesses to corner location:

Duane Marten

Larry Feddersen

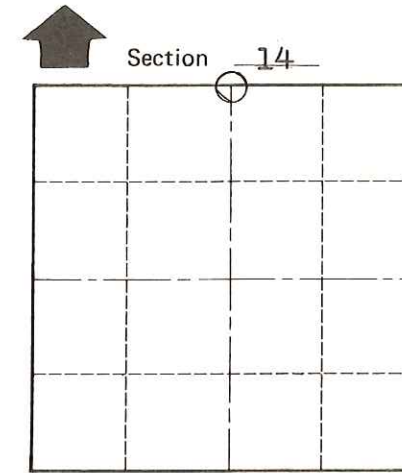
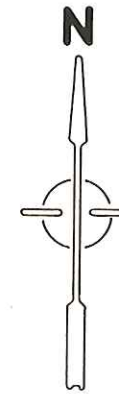
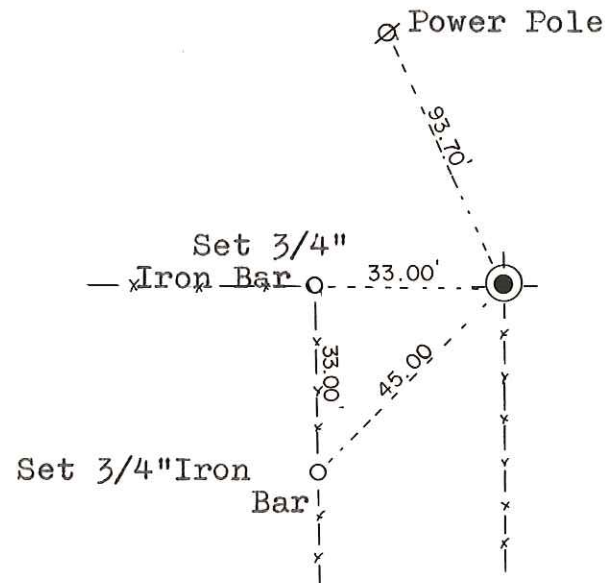

O = LOCATION CORNER

T 17 N R 1 W

WISCONSIN

COUNTY SURVEYOR FORM NO. 1

SURVEY CONTROL ORDER

Horizontal	_____
Vertical	_____

WISCONSIN COORDINATE SYSTEM

Corner	East (X)	North (Y)	Elevation (Z)	Zone
Control Sta. Name				

~~City/Town~~ or Town Tomah

County of Monroe