

89

**U.S. PUBLIC LAND CORNER
MAINTENANCE**

Corner ID : SE Sec.20, T17N-R1W

21701200000

<u>DATE</u>	<u>CREW</u>	<u>MONUMENT TYPE</u>
November 7, 2018	Zachariah P. Dechant Gary L. Dechant	Existing Harrison, top broke off, down 12", at end of Hillside Road, 4' north of culvert, west 1990 tie destroyed and all other 1990 ties found leaning due to widening of road/driveways and recent ditching.

References:

	<u>Bearing</u>	<u>Distance</u>
1) Existing 3/4" round iron bar, leaning, straightened, 1' north of survey sign	North	23.65' (23.53')
2) Existing 3/4" round iron bar, leaning, straightened, 5' east of mail boxes	S13E	72.22' (72.27')
3) Existing, 3/4" round iron bar, leaning, straightened, 12' west of road	S8W	73.10' (72.91')
4) Set 3/4"x24" round iron bar, down 6", set small flat stone over bar	West	46.66'

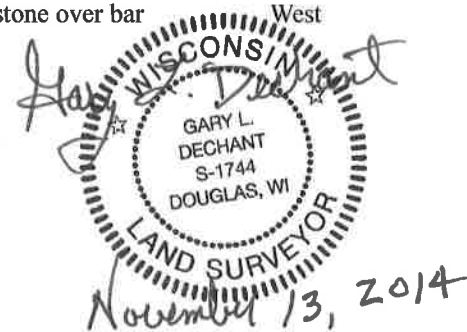

I, Bryan H. Meyer, do hereby certify that on the 19th day of January 1990, I found (evidence) ~~no evidence~~ of the Southeast corner of Section 20, T 17 N, R 1 W Fourth Principal Meridian, and I re-established said corner according to the Wisconsin Statutes as shown and described hereon.

Dated this 17th day of Dec. 1990.

Bryan H. Meyer
Deputy County Surveyor
Title

History of corner establishment since Original Government Survey

William C. Jung was here in May of 1978 and set a 3/4"x24" round iron bar as a survey point. His notes indicate that more measurements were needed to the East and North to verify this corner.

Description of corner evidence found:

I found Mr. Jung's 3/4" round iron bar and made measurements to the West, North and East. These measurements show no consistent pattern as to direction or distance. I accepted Mr. Jung's iron bar which is in the centerline of a Town Road / Driveway and on line with fences from the West, North and East, as the best available evidence.

See Reverse Side For Maintenance



H. A. Sime and Associates
P. O. Box 705
Tomah, Wisconsin 54660
Phone: (608)-372-5392

Description of corner and witness monuments, references and accessories used to perpetuate the original or re-established location of this corner:

Witnesses to corner location:

Brian Forsythe
John Kenworthy
Bryan H. Meyer

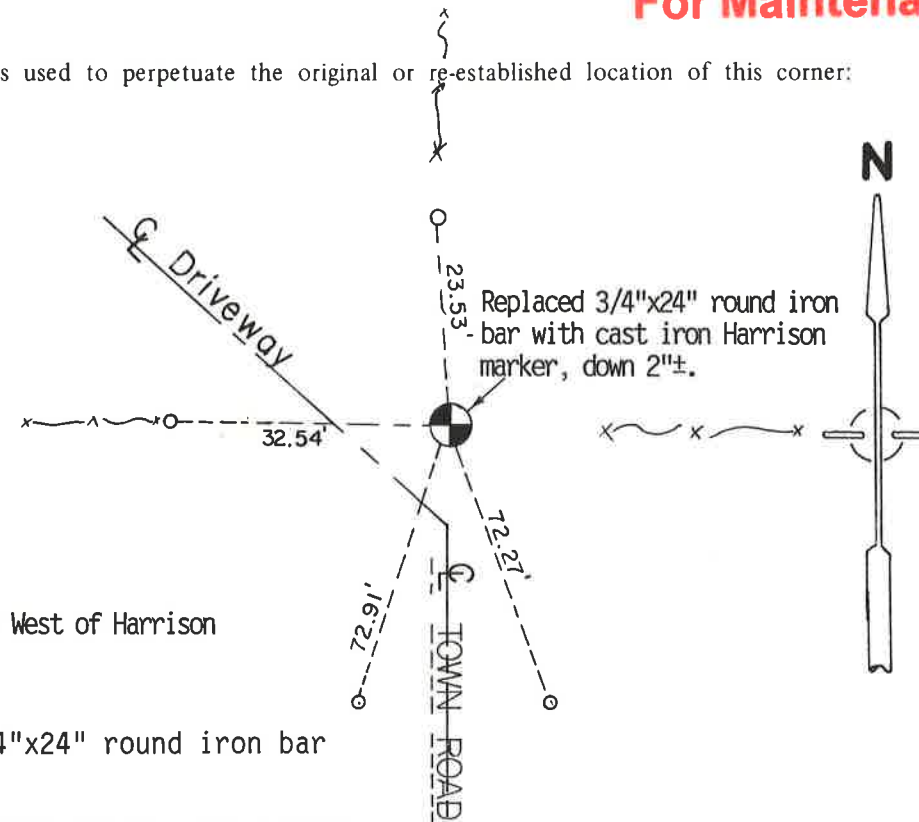

Set sign 32'± West of Harrison

o = Set 3/4"x24" round iron bar

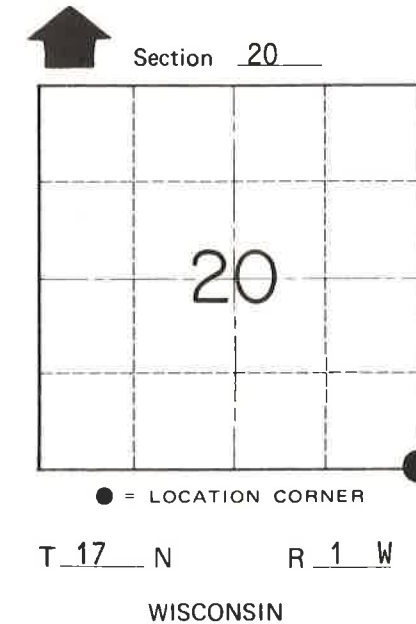

SURVEY CONTROL ORDER

Horizontal	_____
Vertical	_____

WISCONSIN COORDINATE SYSTEM

Corner	East (X)	North (Y)	Elevation (Z)	Zone
Control Sta. Name				

~~City, Village or~~ Town Tomah
County of Monroe

COUNTY SURVEYOR FORM NO. 1