

21605362000

U. S. PUBLIC LAND SURVEY MONUMENT RECORD

SECTION 36 T 16 N, R 5 W, TOWN OF BANGOR

LA CROSSE COUNTY

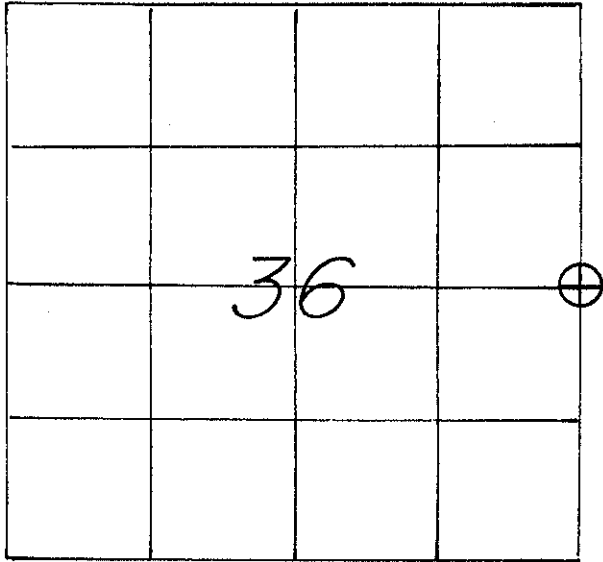

LOCATION OF LANDMARK

WISCONSIN COORDINATE SYSTEM
North
East
Theta Angle
Horiz. Order
Vert. Order
TYPE OF LANDMARK
Existing Harrison marker.
BEARINGS ARE REFERENCED TO

Crew: WILLIAM C. JUNG
 PETER F. FOLLANSBEE
 Date: 6/26/1997

Describe any record evidence, monument evidence, testimonial evidence or any other material evidence you considered and whether the monument was found or restored through acceptance of an obliterated evidence location.

We found the Harrison set by Dechant in good condition. I searched again at length for the stone but found nothing. We then took new ties. Old Mr. Whitehead told me that in the past neighbor kids may have vandalized this corner and possibly threw the stone pieces into the gully to the Northwest. We also searched over there for pieces to verify this but found nothing.

Describe or show any material discrepancy between the location of the restored corner and that of the corner previously restored or reestablished.

None Known.

W/14 Sec. 31
 T16N-R4W

114 (2)

CERTIFICATE

CERTIFIED LAND CORNER

No. 114

I, Gary L. Dechant, do hereby certify that on the 18th day of December, 1986, I found (evidence) (~~no evidence~~) of the W¹/₄ corner of Section 31, T 16 N, R 4 W Fourth Principal Meridian, and I re-established said corner according to the Wisconsin Statutes as shown and described hereon.

Dated this 6th day of Jan., 1987.

Gary L. Dechant
Registered Land Surveyor, 1744
Title

History of corner establishment since Original Government Survey

A surveyor set a stone here according to LaCrosse County Survey Records.

Description of corner evidence found:

Could not find stone, accepted fence corner as best available evidence.

COUNTY SURVEYOR FORM NO. 1

Description of corner and witness monuments, references and accessories used to perpetuate the original or re-established location of this corner:

Witnesses to corner location:

David E. Madison

Gary L. Dechant

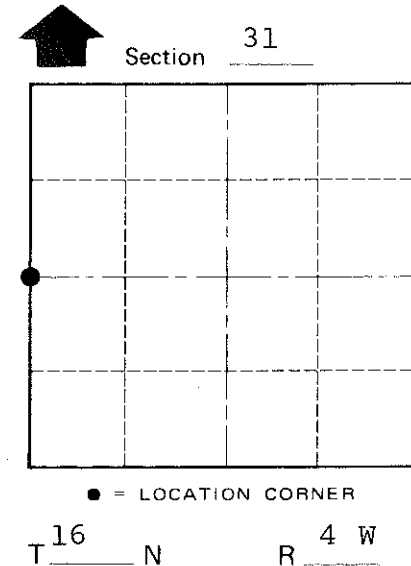
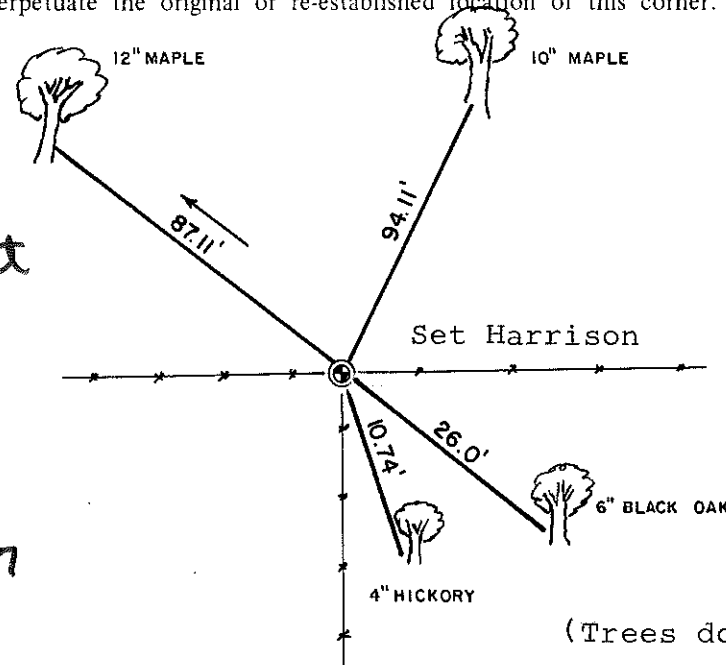
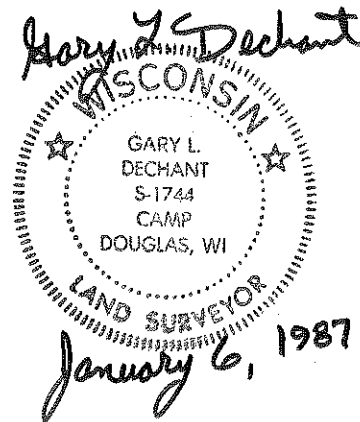

● = LOCATION CORNER
T 16 N R 4 W

WISCONSIN

(Trees double blazed with N&C's set)

SURVEY CONTROL ORDER

Horizontal _____
Vertical _____

WISCONSIN COORDINATE SYSTEM

Corner	East (X)	North (Y)	Elevation (Z)	Zone
Control Sta. Name				

~~City, Village or~~ Town Leon

County of Monroe